

	KATALOG	Primorska 1 42000 VARAŽDIN OIB: 25020037517
	BAZENI I DODATNA OPREMA	Tel: 042/350-074, fax: 042/350-074 E-mail: controlmatik@vz.t-com.hr

KATALOG

Jedna od djelatnosti tvrtke **CONTROLMATIK d.o.o.** je nabava i postavljanje visoko kvalitetnih bazena i njihove dodatne opreme. Naši bazeni su visoke kvalitete i građeni po najvišim standardima.

Pribor za bazene Pokrivi za bazene	BAZENI I PRIBOR
	Solarni grijači vode za bazene
	BAZENSKA TEHNOLOGIJA: FILTERI I PUMPE

OPĆA UPUTSTVA ZA UPRAVLJANJE SA BAZENOM
UPUTSTVO ZA PREZIMLJAVANJE BAZENA
UPUTSTVO ZA UPRAVLJANJE PIJEŠČANIM FILTERIMA
UPUTE ZA UGRADNJU BAZENA

BAZENI I PRIBOR	2-12
BAZENSKA TEHNOLOGIJA :FILTERI I PUMPE	13-22
<u>Pribor za bazene</u>	23-31
<u>Pokrivi za bazene</u>	32-34
<u>Solarni grijači vode za bazene</u>	35-36
OPĆA UPUTSTVA ZA UPRAVLJANJE SA BAZENOM	37-39
UPUTSTVO ZA PREZIMLJAVANJE BAZENA	40-41
UPUTSTVO ZA UPRAVLJANJE PIJEŠČANIM FILTERIMA	42-46
UPUTE ZA UGRADNJU BAZENA	47-50

BAZENI

I

PRIBOR

SUNNY POOL®

Economic-Sets

BAZEN: čelična ploča visine 1.20 cm i debljine 0.45 mm, čelični lim s perforacijama za skimmer i ulazne mlaznice (pocinčane), plastificirane s vanjske strane, lakirano iznutra s bazenskom folijom 0.4 mm, **plave boje**

FILTER: filter IS6 ili pješčani filter Sandy 8, promjera 400 mm s gornjim ventilom te samousisnom pompom s cirkulacijskom stopom od 7 m/h



		Article No.
Economic-Set 1	Round pool ø 4 m, suspension filter IS 6	10.51.10 F
Economic-Set 2	Round pool ø 4 m, sand filter system, integrated skimmer set with inlet nozzle, flange and seals	10.51.11 F
Economic-Set 3	Round pool ø 5 m, suspension filter IS 6	10.51.12 F
Economic-Set 4	Round pool ø 5 m, sand filter system, integrated skimmer set with inlet nozzle, flange and seals	10.51.13 F
Economic-Set 5	Eight form pool 5.4 x 3.5 m, suspension filter IS 6	10.52.10 F
Economic-Set 6	Eight form pool 5.4 x 3.5 m, sand filter system, integrated skimmer set with inlet nozzle, flange and seals	10.52.11 F

SUNNY POOL®

Round swimming pools (Okrugli bazen)

Okrugli bazeni od pocinčanog čeličnog lima



0.6 mm (0,8 mm za bazen dubine 1,5 m), obloženi poliesterom izvana i zaštitnim lakom iznutra, PVC rukohvatom i vodilicama za lim. PVC unutarnji poklopac izrađen je od UV stabiliziranih materijala, i od otporne folije na hladnoću

Steel wall 0.6 mm / foil 0.6 mm blue						
Size	1.2 m deep	1.5 m deep	PE cover tarpaulin	Air bubble foil (round)	Provence stones *	
ø m	Article No.	Article No.	Article No.	Article No.	Article No.	Article No.
4.00	10.11.12 D		32.11.15 D	32.21.15 D		38.15.12 E
5.00	10.11.15 D	10.31.12 D	32.11.19 D	32.21.19 D		38.15.15 E
6.00	10.11.16 D	10.31.13 D	32.11.21 D	32.21.21 D		38.15.16 E
7.00	10.11.17 D	10.31.14 D	32.11.23 D	32.21.23 D		38.15.17 E
8.00	10.11.18 D	10.31.15 D	32.11.25 D	32.21.25 D		38.15.18 E
9.00	10.11.19 D	10.31.16 D	32.11.27 D			
10.00	10.11.20 D	10.31.17 D	32.11.28 D			

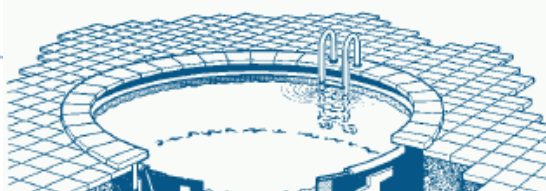

SUNNY POOL®

Eight form swimming pool (**bazen u obliku osmice**)

Bazen u obliku osmice od pocinčanog čeličnog lima 0.6 mm (0,8 mm za bazen dubine 1,5 m).

Također obložen poliesterom izvana i zaštitnim lakom iznutra, PVC rukohvatom i vodilicama za lim.

PVC unutarnji poklopac izrađen je od

UV stabiliziranih materijala, i od otporne folije na hladnoću.

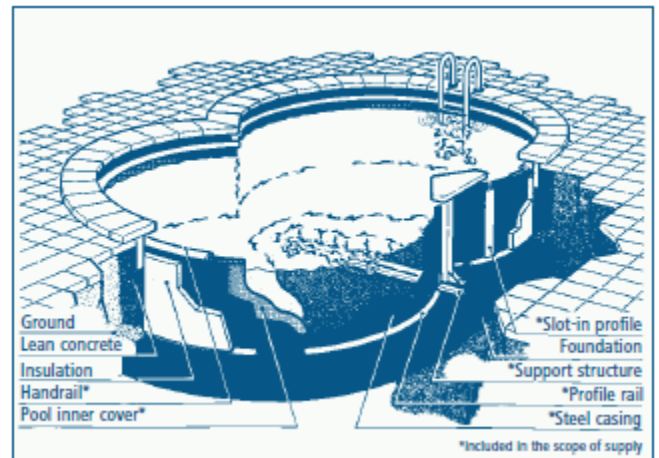

Foil 0.6 mm blue						
Size	1.2 m deep Steel wall 0.6 mm	1.5 m deep Steel wall 0.8 mm	PE cover tarpaulin	Air bubble foil (oval)	Provence stones	
ø m	Article No.	Article No.	Article No.	Article No.	Article No.	
5.25 x 3.20	10.14.10 D	10.34.10 D	32.12.10 D	32.22.10 D	38.15.40 E	
5.40 x 3.50	10.14.11 D	10.34.11 D	32.12.11 D	32.22.11 D	38.15.41 E	
6.25 x 3.60	10.14.12 D	10.34.12 D	32.12.12 D	32.22.12 D	37.15.42 E	
7.25 x 4.60	10.14.14 D	10.34.14 D	32.12.14 D	32.22.14 D	38.15.44 E	
8.55 x 5.00	10.14.16 D	10.34.16 D	32.12.16 D	32.22.16 D	38.15.46 E	
9.20 x 6.00	10.14.17 D	10.34.17 D	32.12.17 D	32.22.17 D	38.15.47 E	



SUNNY POOL®

Oval shape swimming pool

Ovalni bazen bez čelične konstrukcije. Samo za ugradnju u zemlju s podrškom zida od šupljih betonskih cigli, ispunjen betonom i armaturama, ili bez dodatnog punjenja uz posebnu podršku za zid od čeličnih elemenata, od plastificiranog pocinčanog čeličnog lima 0.6 mm (0,8 mm za bazen dubine 1,5 m). Također obložen poliesteraomizvana i zaštitnim lakom iznutra.

PVC rukohvatom i vodilice za lim.

PVC unutarnji poklopac koji je izrađen od UV

stabiliziranih materijala, i od otporne folije na hladnoću.

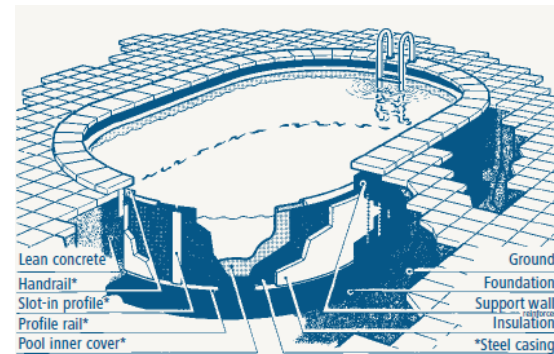

Foil 0.6 mm blue

Size	1.2 m deep Steel wall 0.6 mm	1.5 m deep Steel wall 0.8 mm	PE cover tarpaulin	Provence stones *
m	Article No.	Article No.	Article No.	Article No.
4.90 x 3.00	10.17.10 D	10.37.10 D	32.13.10 D	38.15.60 E
6.30 x 3.60	10.17.12 D	10.37.11.D	32.13.19 D	38.15.62.E
7.37 x 3.60	10.17.14 D	10.37.12 D	32.13.26 D	38.15.64 E
8.00 x 4.00	10.17.15 D	10.37.14 D	32.13.28 D	38.15.65 E
9.16 x 4.60	10.17.18 D	10.37.16 D	32.13.35 D	38.15.69 E
9.00 x 5.00	10.17.19 D	10.37.18 D	32.13.34 D	38.15.70 E
10.30 x 5.00	10.17.20 D	10.37.19 D	32.13.40 D	38.15.72 E
11.00 x 5.50	10.17.21 D	10.37.20 D	32.13.41 D	38.15.73 E

SUNNY POOL® **SUNSTAR® POOL**

Bazen Sunstar je montažni bazen od čeličnih segmenata koji mogu biti 0,5 m ili 0,25 m širine i 1,5 m visine, koji su zajedno spojeni. Bazen Sunstar može se isporučiti u svim dimenzijama .

Segmenti su izrađeni od visokog čvrstog čelika koji je pocinčan i plastificiran . Ovaj moderan materijal je razvijen za automobilsku industriju, jako je čvrst, ali i ima visoku razinu otpornost na koroziju. Jedan od elemenata teži je 13 kg.



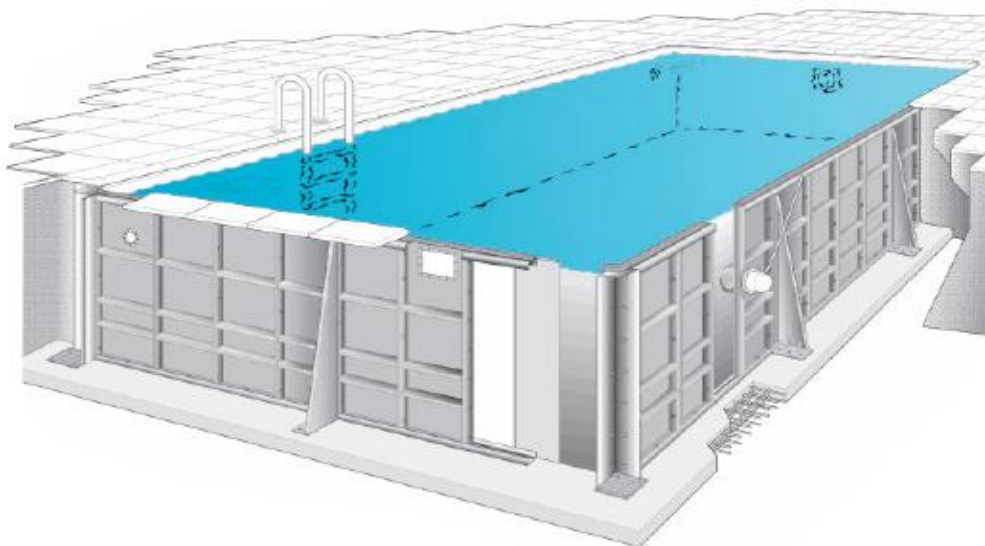

Pool depth 1.5 m

Pool size		Approx. volume		Edge stones colour
				Provence light
m	m ²	Article No.		Article No.
6.0 x 3.0	27	11.21.10 F		38.12.28 E
6.5 x 3.0	29	11.21.11 F		38.12.29 E
6.5 x 3.5	34	11.21.12 F		38.12.30 E
7.0 x 3.5	37	11.21.13 F		38.12.31 E
7.5 x 3.5	39	11.21.14 F		38.12.32 E
7.0 x 4.0	42	11.21.15 F		38.12.33 E
7.5 x 4.0	45	11.21.16 F		38.12.34 E
8.0 x 4.0	48	11.21.17 F		38.12.35 E
8.0 x 4.5	54	11.21.18 F		38.12.36 E
8.0 x 5.0	60	11.21.19 F		38.12.37 E
8.5 x 4.5	57	11.21.20 F		38.12.38 E
9.0 x 4.5	60	11.21.21 F		38.12.39 E
9.0 x 5.0	67	11.21.22 F		38.12.40 E
9.5 x 5.0	71	11.21.23 F		38.12.41 E
10.0 x 5.0	75	11.21.24 F		38.12.42 E
12.0 x 6.0	108	11.21.25 F		38.12.43 E
Steel elements 0.25 m wide		25.34.11 F		
Steel elements 0.5 m wide		25.34.10 F		

	<h1>KATALOG</h1>	<p>Primorska 1 42000 VARAŽDIN OIB: 25020037517 Tel: 042/350-074, fax: 042/350-074 E-mail: controlmatik@vz.t-com.hr</p>
<h2>BAZENI I DODATNA OPREMA</h2>		

SUNNY POOL®

SUNSTAR® POOL with overflow channel



Uspješna Sunstar s prelivom kanala je doživio daljnji razvoj pružajući još veću udobnost i sigurnost.

Preljevni kanal koji se savršeno uklapa sa strukturom tako da poboljšava sigurnosni aspekt, kao i držanje površine vode čistim i povećava bazensku hidrauliku, čime se poboljšava kvaliteta vode.

Čelični segmenti su izrađeni na isti način kao i bazen Sunstar ali su nešto kraći. Preljevni kanal jednostavno se ugrađuje na montirane segmente i spojen je na rubove segmenta. Ako segmente pažljivo uskladimo, neće biti potrebe daljnjeg prilagođavanja prelivnih kanala.

Standarde rešetke za kanal su 200 mm, one se nalaze u smjeru kretanja vode.

Kanal rešetka de luxe 200 mm.

Rešetke ovog izuzetno elegantnog poklopca
leže poprečno u odnosu na smjer kretanja vode.

To sprečava vodu da se prelijeva u velikoj
mjeri, kao i dizajn koji funkcionira

kao mini lukobran.

Rezultat je još niža razine potrošnje vode.

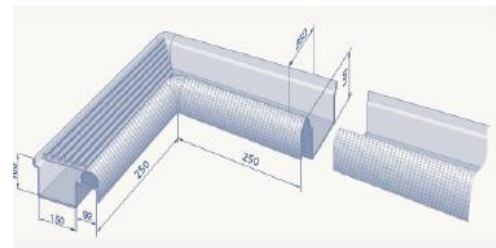

BAZEN SE SASTOJI OD:

- pocinčani, plastificirani čelik visoke čvrstoće 0,5 m
- 4 pocinčana čelična kutna podržaća koji podržavaju najmanje svaka 2 m
- pocinčani i plastificirane U-profile kao i čeličnih segmenata na dnu
- pocinčani vijci M10 heksadecimalni s podložnim pločicama
- tiple za pričvršćivanje koje podržavaju čelične segmente do betoniranih ploča
- cut-out za podvodna svjetla (uz naplatu)



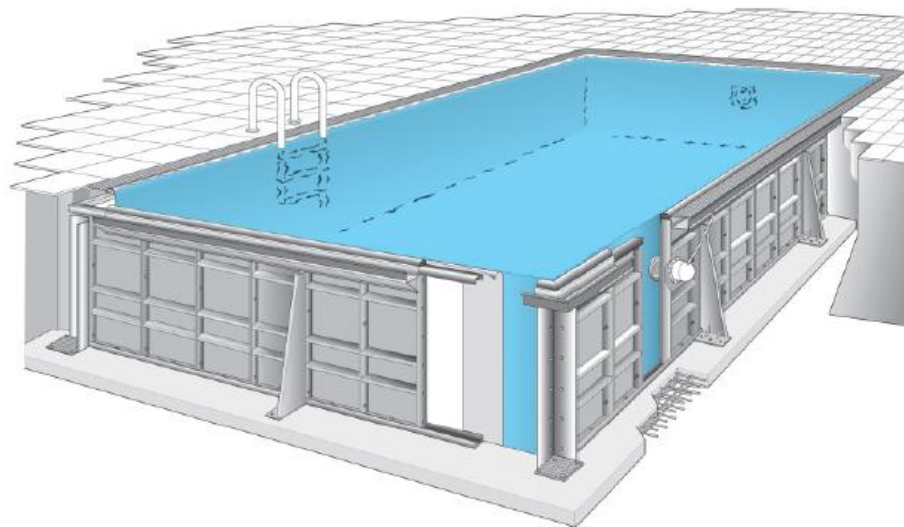

Pool depth 1.34 m *							
Pool size		Approx. volume		Channel grating Standard		Channel grating de Luxe	
m	m ²	Article No.		Article No.		Article No.	
6.0 x 3.0	24	11.24.10 F		25.92.10 E		25.92.11 E	
6.5 x 3.0	26	11.24.11 F		25.92.12 E		25.92.13 E	
6.5 x 3.5	30	11.24.12 F		25.92.14 E		25.92.15 E	
7.0 x 3.5	33	11.24.13 F		25.92.16 E		25.92.17 E	
7.5 x 3.5	35	11.24.14 F		25.92.18 E		25.92.19 E	
7.0 x 4.0	38	11.24.15 F		25.92.20 E		25.92.21 E	
7.5 x 4.0	40	11.24.16 F		25.92.22 E		25.92.23 E	
8.0 x 4.0	43	11.24.17 F		25.92.24 E		25.92.25 E	
8.0 x 4.5	48	11.24.18 F		25.92.26 E		25.92.27 E	
8.0 x 5.0	54	11.24.19 F		25.92.28 E		25.92.29 E	
8.5 x 4.5	51	11.24.20 F		25.92.30 E		25.92.31 E	
9.0 x 4.5	54	11.24.21 F		25.92.32 E		25.92.33 E	
9.0 x 5.0	60	11.24.22 F		25.92.34 E		25.92.35 E	
9.5 x 5.0	64	11.24.23 F		25.92.36 E		25.92.37 E	
10.0 x 5.0	67	11.24.24 F		25.92.38 E		25.92.39 E	
12.0 x 6.0	97	11.24.25 F		25.92.40 E		25.92.41 E	
Steel elements 0.25 m wide		25.35.13 F					
Steel elements 0.5 m wide		25.35.10 F					

Polyester steps

(Poliester Stepenice)

Stepenice od stakloplastike armiranog poliestera s folijom prirubnicom. One su opremljene s folijom prirubnicom i time pogodne za gotovo sve bazenske dizajne obložene folijom ili unutarnji poklopcem. Na primjer, Sunstar bazeni, bazen od polistirena ili elemenata i zida bazena.



Size	White with blue steps	Pale blue with white steps	Medium blue with white steps
W x D x H	Article No.	Article No.	Article No.
3.0 m x 1.25 m x 1.5 m	37.23.10 F	37.23.11 F	37.23.12 F
2.5 m x 1.0 m x 1.5 m	37.23.13 F	37.23.14 F	37.23.15 F
1.5 m x 1.0 m x 1.5 m	37.23.16 F	37.23.17 F	37.23.18 F
Corner steps (only for use with 1.5 mm foil)			
2.00 x 2.00 x 1.50 m with inner steps	37.23.19 F	37.23.20 F	37.23.21 F

37.23.16
37.23.17
37.23.18

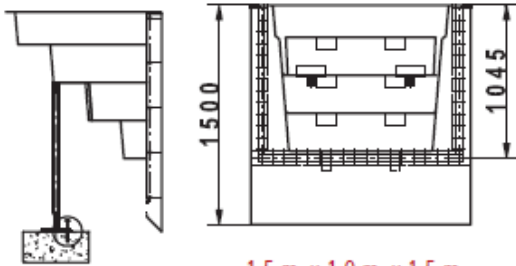
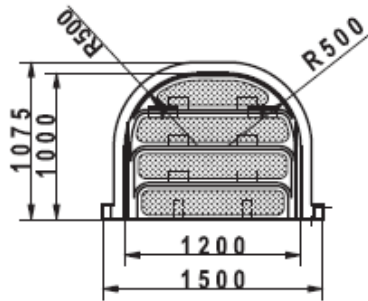

1.5 m x 1.0 m x 1.5 m

37.23.13
37.23.14
37.23.15

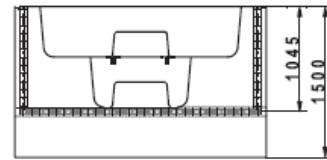
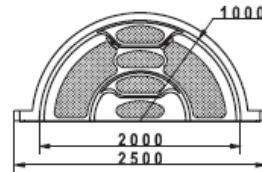

2.5 m x 1.0 m x 1.5 m

37.23.10
37.23.11
37.23.12

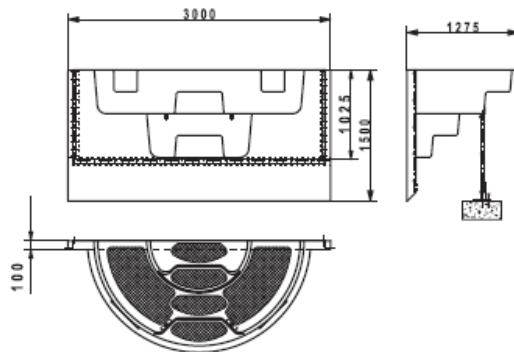
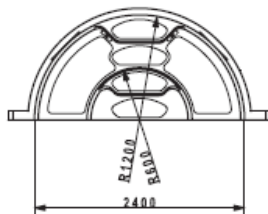

3.0 m x 1.25 m x 1.5 m

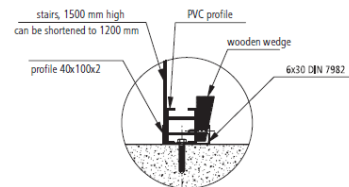
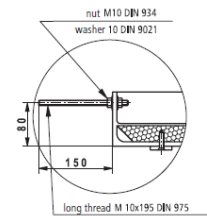
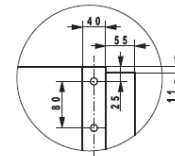

**BAZENSKA
TEHNOLOGIJA:
FILTERI I
PUMPE**



Pješčani filterski sustav

Pješčani filter se sastoji od dva dijela. Filtera i šestpoložajnog ventila.

Filter: Dolaskom vode u filter voda se pod velikim pritiskom filtrira kroz 75 kg kvarcnog pijeska. To se pokazalo kao najbolje rješenje za filtriranje slatke vode koja sadrži prašinu, masnoće te oku nevidljive nečistoće.



Filterski spremnik napravljen od ojačane plastike, s identično glatkom površinom iznutra i izvana, ima veliku snagu i otpornost na temperature od -40° C do 120 ° C. Filteri su građeni od kvalitetne plastike kako bi sve dijelove filtra zaštitili od korozije. Jedna od prednosti naših filtera jest njihova jednostavnost servisiranja, gornji dio filterskog spremnika može se skinuti i zamijeniti pijesak, bez isključivanja cijevi. Također je jednostavan za korištenje. Također ima automatski backwashing (povratno pranje filtera tako da je jačina filtera godinama ista) sustav dostupan na zahtjev za sve filtre. I zadnje, ali ne manje važno, funkcionalni dizajn koji je impresivno za pogledati.

Piješčani filtri za privatne bazene

Type	Article No.	Pump type	Filtration rate	Tank	Filter surface	Mean filtering speed
			m ³ /h	Ø in m	m ²	m/h
KS 7 W	20.11.15 D	Speck Badu 90/7W	6.0 - 8.5	0.45	0.16	44
KS 9 W	20.11.16 D	Speck Badu 90/11W	8.5 - 11.0	0.45	0.16	56
KS 9 D	20.11.17 D	Speck Badu 90/11D	8.5 - 11.0	0.45	0.16	56
KS 9 W	20.12.10 D	KSB Filtra 8E	8.5 - 11.0	0.45	0.16	56
KS 9 D	20.12.11 D	KSB Filtra 8D	8.5 - 11.0	0.45	0.16	56
BLUE LINE						
KS 9 W	20.11.18 E	Superpump 12	8.0 - 10.5	0.45	0.16	56
KS 9 W	20.12.12 E	KSB Filtra 6E	8.0 - 10.5	0.45	0.16	56
KS 12 W	20.11.19 E	Superpump 14	9.0 - 13.0	0.60	0.28	43
KS 12 W	20.12.13 E	KSB Filtra 14E	9.0 - 13.0	0.60	0.28	43
KS 12 W	20.11.20 D	Speck Badu 90/15G-W	9.0 - 13.0	0.60	0.28	43
KS 12 D	20.11.21 D	Speck Badu 90/15G-D	9.0 - 13.0	0.60	0.28	43
KS 12 W	20.12.14 D	KSB Filtra 14E	9.0 - 13.0	0.60	0.28	43
KS 12 D	20.12.15 D	KSB Filtra 14D	9.0 - 13.0	0.60	0.28	43
KS 14 D	20.11.22 D	Speck Badu 90/20G-D	10.0 - 15.0	0.60	0.28	50
KS 14 D	20.12.16 D	KSB Filtra 18D	10.0 - 15.0	0.60	0.28	50
KS 16 D *	20.11.23 D	Speck Badu 90/20 D	10.0 - 17.0	0.60	0.28	57
KS 16 D *	20.12.17 D	KSB Filtra 18D	10.0 - 17.0	0.60	0.28	57



KS 9 W and KS 9 D



KS 16 D



Typ KS 1:



Typ KS 9 BLUE LINE KSB



Typ KS 12 BLUE LINE KSB



KS 16 D

max. pool size	Power consumption P1	Power output P2	Electrical connection	Sand quantity	Net weight	Gross weight	Packaging
in m ²	in kW	in kW	Voltage	kg	kg	kg	L x B x H in mm
40	0.50	0.30	230	45	28	33	770 x 770 x 780
60	0.65	0.45	230	45	28	33	770 x 770 x 780
60	0.66	0.45	3 ~ 400	45	28	33	770 x 770 x 780
60	0.70	0.40	230	45	28	33	770 x 770 x 780
60	0.70	0.40	3~400	45	28	33	770 x 770 x 780
60	0.65	0.45	230	45	28	33	770 x 770 x 780
60	0.65	0.35	230	45	28	33	770 x 770 x 780
80	0.95	0.65	230	75	45	51	850 x 900 x 880
80	0.90	0.63	230	75	45	51	850 x 900 x 880
80	1.10	0.75	230	75	45	51	850 x 900 x 880
80	1.00	0.75	3 ~ 400	75	45	51	850 x 900 x 880
80	0.90	0.63	230	75	45	51	850 x 900 x 880
80	0.90	0.63	3 ~ 400	75	45	51	850 x 900 x 880
100	1.32	1.00	3 ~ 400	75	46	52	850 x 900 x 880
100	1.15	0.80	3 ~ 400	75	46	52	850 x 900 x 880
100	1.32	1.00	3 ~ 400	75	46	52	850 x 900 x 880
100	1.15	0.80	3 ~ 400	75	46	52	850 x 900 x 880



KS 7 W, KS 9 W, KS 9 D



KS 12 W, KS 12 D, KS 14 D



Filter tank SUPRAPLAST®



	Article No.
Filter tank SUPRAPLAST®, ø 450 mm	20.91.10 D
Filter tank SUPRAPLAST®, ø 600 mm	20.91.11 D
Pallet made of glass-fibre reinforced plastic, with soundproofing effect	20.93.12 D
Filter pallet for KS 7 and KS 9 with integrated filter foot made of plastic	20.93.13 D
Rubber soundproofing plate for KS 7+9	20.93.15 D
Filter pallet for KS 10 to KS 16 and High SUPRAPLAST® with integrated plastic filter foot	20.93.14 D
Rubber soundproofing plate for KS 12, 14, 16	20.93.16 D

FILTERSKI PIJESAK

	Article No.
Quartz filter sand 0.4 – 0.8 mm grain size, 25 kg	20.92.10 D
Quartz filter sand 1.0 – 2.0 mm grain size, 25 kg	20.92.11 D
Quartz filter sand 2.0 – 3.15 mm grain size, 25 kg	20.92.12 D
Quartz filter sand 3.15 – 5.6 mm grain size, 25 kg	20.92.13 D
Basalt 0.4 – 0.8 mm, 40 kg. The surface of the basalt grain is 29% larger than quartz sand for the same grain size, so that basalt offers better filtration than quartz	20.92.16 D
Special carbon (anthracite N), 50 l = 36 kg	20.92.17 D

Quartz filter sand



Special carbon

Basalt

Ventili za filtere

Šestpoložajni ventil: drugi je dio pješčanog filtera koji ima određene funkcije potrebne za rad kompletne opreme.

Položaji ventila:

1. FILTER - normalan rad cijelog sustava
2. BYPASS - odvajanje filtera od uporabe. Voda ide direktno od skimera do pumpe te kroz filter do mlaznica koje pod pritiskom guraju vodu u bazen. Služi za efikasnije doziranje kemikalija
3. RINSE - ispiranje filtera u trajanju 5-10 sekunda nakon BACKWASH-a
4. WASTE - mogućnost čišćenja prašine i zemlje sa dna bazena koja se bez filtera vodi van bazena u odvodni kanal
5. BACKWASH - povratno ispiranje filtera i kvarcnog pijeska
6. CLOSED - zatvara cijeli sustav

Valve	Article No.
6-way plastic valve, Top Mount (Speck)	20.95.10 C
6-way plastic valve, threaded connection R 1 1/2"	20.95.11 C
6-way valve, threaded connection R 2"	20.95.12 C
6-way valve, threaded connection R 3"	20.95.13 C



Pumpe za bazene



		Voltage	P2	Article No.
Filtra	6 E	230 V	0.30 kW	20.22.10 C
Filtra	6 D	400 V	0.30 kW	20.22.11 C
Filtra	8 E	230 V	0.40 kW	20.22.12 C
Filtra	8 D	400 V	0.40 kW	20.22.13 C
Filtra	12 E	230 V	0.50 kW	20.22.14 C
Filtra	12 D	400 V	0.50 kW	20.22.15 C
Filtra	14 E	230 V	0.63 kW	20.22.16 C
Filter	14 D	400 V	0.63 kW	20.22.17 C
Filtra	18 E	230 V	0.80 kW	20.22.18 C
Filtra	18 D	400 V	0.80 kW	20.22.19 C
Filtra	22 E	230 V	1.00 kW	20.22.20 C
Filtra	22 D	400 V	1.00 kW	20.22.21 C
Filtra	24 E	230 V	1.20 kW	20.22.22 C
Filtra	24 D	400 V	1.20 kW	20.22.23 C
Filtra	30D	400 V	1.20 kW	20.22.24 C

KSB bazenske pumpe čije kućište je otporno na visoke temperature i vlagu a građen je od jako otpornog polipropilena



Najnoviji modeli pumpe

		Voltage	P2	Article No.
Badu	90/7 W NEW	230 V	0.25 kW	20.21.10 C
Badu	90/7 D NEW	400 V	0.25 kW	20.21.11 C
Badu	90/11 W NEW	230 V	0.45 kW	20.21.12 C
Badu	90/11 D NEW	400 V	0.45 kW	20.21.13 C
Badu	90/13 W NEW	230 V	0.55 kW	20.21.14 C
Badu	90/13 D NEW	400 V	0.55 kW	20.21.15 C
Badu	90/15 W NEW	230 V	0.75 kW	20.21.16 C
Badu	90/15 D NEW	400 V	0.75 kW	20.21.17 C
Badu	90/20 W NEW	230 V	1.00 kW	20.21.18 C
Badu	90/20 D NEW	400 V	1.00 kW	20.21.19 C



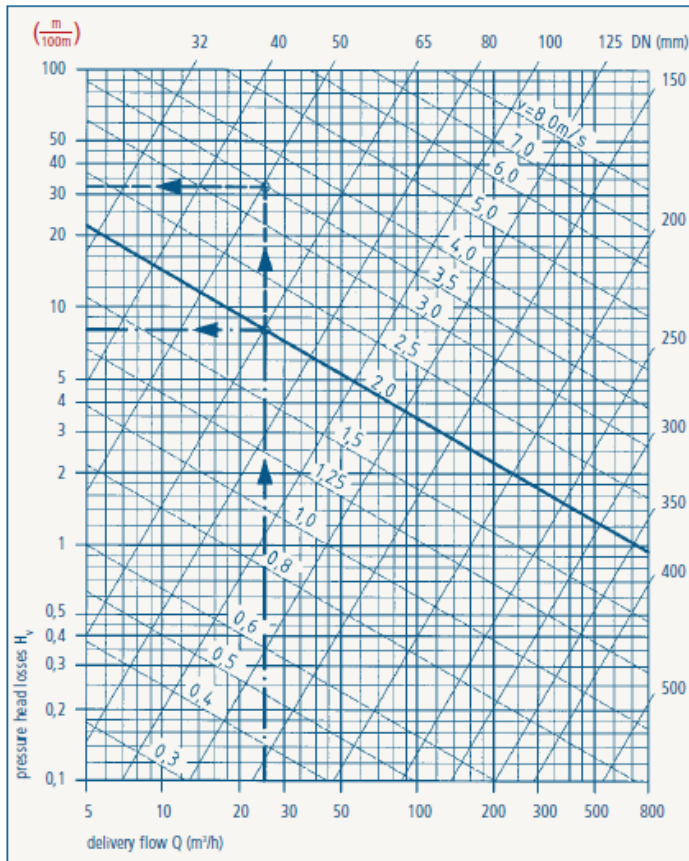

Primjer:

$Q = 25 \text{ m}^3/\text{h}$, 20 m plastic pipe

DN 50 = Δ d 63

DN 65 = Δ d 75

Tlačno čitanje glavnih gubitaka

$H_v = 33 \text{ m per } 100 \text{ m}$ $8.00 \text{ m per } 100 \text{ m}$

Korekcija faktora 0,80 za plastiku cijevi

$26.40 \text{ m per } 100 \text{ m}$ $6.40 \text{ m per } 100 \text{ m}$

Pritisak glavnih gubitaka:

Za 20 m pipe (x 20/100)

$H_v = 5.28 \text{ m}$ 1.28 m

Brzina protjecanja $v = 3,50 \text{ kontrolu m}$

/ s (previsoka) $2,00 \text{ m / s (OK)}$



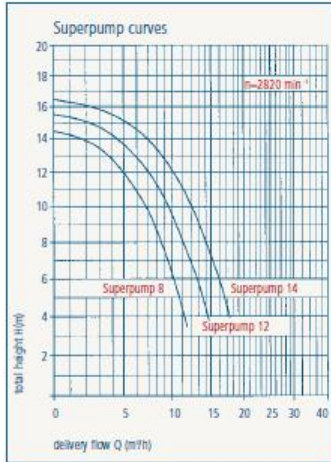

The stated output is the power output P2

	P2		Article No.
Superpump 8	230 V	0.30 kW	20.21.20 D
Superpump 12	230 V	0.45 kW	20.21.21 D
Superpump 14	230 V	0.65 kW	20.21.22 D

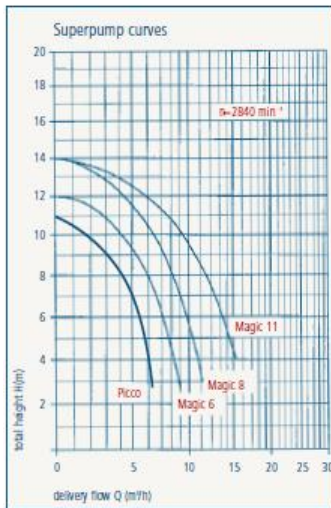

The stated output is the power output P2

	P2		Article No.
Picco 5	230 V	0.20 kW	20.21.23 E
Magic 6	230 V	0.25 kW	20.21.24 E
Magic 8	230 V	0.40 kW	20.21.25 E
Magic 11	230 V	0.45 kW	20.21.26 E



5BR made of bronze, particularly quiet

	Voltage	Output in m ³ /h at 8 m water column	Power output in P2	Article No.
5BRB-1	220 - 240 V	8	0,25kW	20.23.10 D
5BRB-3	380 - 420 V	8	0,25kW	20.23.11 D
5BRC-1	220 - 240 V	11	0,37kW	20.23.12 D
5BRC-3	380 - 420 V	11	0,37kW	20.23.13 D
5BRD-1	220 - 240 V	15	0,55kW	20.23.14 D
5BRD-3	380 - 420 V	15	0,55kW	20.23.15 D
5BRE-1	220 - 240 V	18	0,75kW	20.23.16 D
5BRE-3	380 - 420 V	18	0,75kW	20.23.17 D
5BRF-1	220 - 240 V	21	1,10kW	20.23.18 D
5BRF-3	380 - 420 V	21	1,10kW	20.23.19 D



5MPRC Dyna-Glas

	Voltage	Output in m ³ /h at 8 m water column	Power output in P2	Article No.
5MPRC-1	220 - 240 V	12	0.37kW	20.23.20 D
5MPRC-3	380 - 420 V	12	0.37kW	20.23.21 D
5MPRD-1	220 - 240 V	16	0.55kW	20.23.22 D
5MPRD-3	380 - 420 V	16	0.55kW	20.23.23 D
5MPRE-1	220 - 240 V	21	0.75kW	20.23.24 D
5MPRE-3	380 - 420 V	21	0.75kW	20.23.25 D
5MPRF-1	220 - 240 V	27	1.10kW	20.23.26 D
5MPRF-3	380 - 420 V	27	1.10kW	20.23.27 D



SW5P6R special pumps for seawater (salt level max. 4.0%)

	Voltage	Output in m ³ /h at 8 m water column	Power output in P2	Article No.
SW5P6RD-1	220 - 240 V	16.5	0.55kW	20.23.28 D
SW5P6RD-3	380 - 420 V	16.5	0.55kW	20.23.29 D
SW5P6RE-1	220 - 240 V	20.0	0.75kW	20.23.30 D
SW5P6RE-3	380 - 420 V	20.0	0.75kW	20.23.31 D
SW5P6RF-1	220 - 240 V	24.5	1.10kW	20.23.32 D
SW5P6RF-3	380 - 420 V	24.5	1.10kW	20.23.33 D
SW5P6RG-1	220 - 240 V	29.0	1.50kW	20.23.34 D
SW5P6RG-3	380 - 420 V	29.0	1.50kW	20.23.35 D
SW5P6RH-1	220 - 240 V	34.0	2.20kW	20.23.36 D
SW5P6RH-3	380 - 420 V	34.0	2.20kW	20.23.37 D



Pribor za bazene



Usisavači za bazene

Ručni usisavači

Ručni čistač za sve bazene - okrugle, ovalne, u obliku osam ili pravokutnog oblika. Četke usisava pomoću vakuuma pod bazena. Čišćenje se izvodi ručno. Zajedno s 9,8 m posebnim crijevom i prenosnim ventilom.



Uz to se dobiva : Teleskopski štap i crijevo za usisavanje

Teleskopski štap	1,5-3,0m	1,8-3,6 m	2,4-4,8 m	2,4-4,8m	1,8-3,6 m
Te crijeva za usisavanje	4,5m	7,5 m	10 m	15 m	7,5m

Automatski usisavači

Automatski čistači, čiste bazene bez nadzora, čak vrlo prljave bazene i to brzo i temeljito, bez problema čiste rubove, uglove i područja oko zaljeva mlaznica i ljestava.

Dolphin pool cleaners



Dolphin Plus Battery

- Cordless pool cleaner with lithium ion battery
- Cleans the pool in 1.5 hours • Special programs
- Clogged filter bag indicator • Incl. caddy
- With remote control • New scanner software
- For pools up to 12 m long

Combi brush Article No. 40.12.31 E

Wonder brush Article No. 40.12.32 E



Dolphin Luminous

- Lighting • Special programs • Cleans the pool in 1.5 hours
- 19 m cable with swivel • Clogged filter bag indicator
- Incl. caddy • With remote control • New scanner software
- For pools up to 12 m long

Combi brush Article No. 40.12.15 E

Wonder brush Article No. 40.12.16 E

Dolphin Magic

- Pool cleaner for all pool shapes • Cleaning program takes 100 min • Cable with swivel • 19 m cable • Incl. caddy
- New scanner software • For pools up to 12 m

PVC brush Article No. 40.12.11 E

Combi brush Article No. 40.12.12 E

Wonder brush Article No. 40.12.13 E



Dolphin Diagnostic

- Climbs walls • Large filter surface • Cable 20 m long with float
- 1 kg dirt absorption capacity • Incl. caddy • Cleans the pool in 3 hours • For pools up to 12 m long

PVC brush Article No. 40.12.20 E

Combi brush Article No. 40.12.21 E

Wonder brush Article No. 40.12.22 E

Diagnostic and Dynamic filter bag

Article No. 40.13.61 E

Disposable bags 5 each Article No. 40.14.81 E

Magic/Luminous filter bag

Article No. 40.13.78 E

Moby filter bag

Article No. 40.15.29 E



Dolphin Dynamic plus

- Special programs • Cleans the pool in 3 hours • 20 m cable with swivel • Clogged filter bag indicator • With Combi brushes
- Incl. caddy • With remote control • New scanner software
- For pools up to 12 m

PVC brush	Article No. 40.12.23 E
Combi brush	Article No. 40.12.24 E
Wonderbrush	Article No. 40.12.25 E

Dolphin Dynamic pro X

- Special programs • Cleans the pool in 6 hours • 30 m cable with swivel • Clogged filter bag indicator • Incl. caddy
- With remote control • New scanner software
- For pools up to 25 m

Combi brush	Article No. 40.12.27 E
Wonder brush	Article No. 40.12.28 E



Dolphin 2x2

- Climbs walls • Cable 40 m long with swivel • 2 x 1 kg dirt absorption capacity • With remote control • Incl. caddy
- Cleans the pool in 8 hours • Clogged filter bag indicator
- With Combi brushes • For public pools up to 60 m long

PVC brush	Article No. 40.12.17 E
Combi brush	Article No. 40.12.18 E
Wonder brush	Article No. 40.12.19 E

Dolphin Moby

- Pool cleaner for all pool shapes • 19 m cable without caddy
- Cycle time 2.5 h • Small filter bag with 70 micron instead of 50 micron • Without remote control • 2 years guarantee
- Cleans the corners, not the walls • For pools up to 10 m long

Combi brush	Article No. 40.12.37 E
--------------------	------------------------



Montažni dijelovi

Extension piece made of gunmetal for surface extractor, length: 100 mm
Article No. 36.21.30 C

Surface extractor made of gunmetal, with 2-way control valve, installation depth 24 cm
Article No. 36.21.11 C*

as above, without control valve
Article No. 36.21.10 C*

Pool cleaner connection plate. For surface extractor 36.21.11 and 36.21.10
Article No. 36.21.36 C



Sealing plug 1 1/2"
Article No. 36.28.10 C

Key for sealing plug
Article No. 36.28.11 C

PVC hose nozzle NW 38
Article No. 36.28.12 C

Water level controller, mechanical, made of gunmetal, matches surface extractor 36.21.11 and 36.21.10
Article No. 36.28.13 C



Tile frame fits the lid of surface extractor 36.21.11 and 36.21.10, Ms, pol. NiZi
Article No. 36.21.31 C



Double tile frame for 2 lids of the surface extractor and water level controller, Ms, pol. NiZi
Article No. 36.21.32 C



Flange set for surface extractor, for foil and prefabricated pools
Article No. 36.21.33 C



Flange set for surface extractor, for tiled pools, 15 mm wider on each side
Article No. 36.21.34 C



Floor drain with right-angled outlet R 2"
Article No. 36.23.10 C

Set of flange rings for floor drain
Article No. 36.23.30 C



Electronic water level control with solenoid valve R 1/2"
Article No. 36.92.10 C



240 mm R 2" inside x R 1 1/2" inside (302)
Article No. 36.24.10 C

340 mm R 2" inside x R 1 1/2" inside (303)
Article No. 36.24.11 C



Double seal for 36.21.11 and 36.21.10
Article No. 36.91.14 C*

Mlaznice



Flange parts only fit wall leadthrough 36.24.10 and 36.24.11
with nozzle, adjustable direction, ball 18 mm \varnothing

Article No. 36.22.18 C

Inlet fitting with flange part. With nozzle, adjustable direction,
18 mm \varnothing , outer thread R 1½" x 40 mm

Article No. 36.22.10 C

Inlet fitting with flange part. With nozzle, adjustable direction,
18 mm \varnothing , outer thread R 2" x 40 mm

Article No. 36.22.11 C



Inlet nozzle R 1½", thread length 40 mm, nozzle 18 mm \varnothing

Article No. 36.22.12 C

Outer thread R 2", thread length 40 mm, nozzle 18 mm \varnothing

Article No. 36.22.13 C

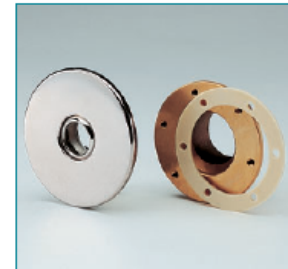

Lampe za bazene

made of stainless steel	<p>Concrete installation recess (V2A) for underwater spotlights incl. cable protection pipe</p> <p>Article No. 37.79.10 C</p> 	<p>Underwater spotlight (V2A), used with 12V 300W light bulb, ø 250 mm</p> <p>Article No. 37.79.11 C</p> 	<p>Distribution box (V2A) for underwater spotlights 2 x PG 16 and 1 x 3/4" connections Anschlüsse</p> <p>Article No. 37.79.12 C</p> 	<p>Flange set for underwater spotlights for prefabricated and foil pool, complete with seals and screws (V2A)</p> <p>Article No. 37.79.13 C</p>	
	<p>Double seal for underwater spotlight installation recess (37.79.11)</p> <p>Article No. 37.79.14 C</p>				
	made of gunmetal	<p>Installation recess</p> <p>Article No. 37.79.19 C</p> 	<p>Spotlight insert</p> <p>Article No. 37.79.20 C</p> 	<p>Connection box made of gunmetal (distribution box)</p> <p>Article No. 37.79.27 C</p> 	<p>Flange set for foil pools</p> <p>Article No. 37.79.18 C</p>
		<p>Double seal for underwater spotlight 37.71.13</p> <p>Article No. 37.79.16 C</p>			
made of plastic		<p>Underwater spotlight made of white plastic with installation recess made of ABS for foil pools, flange made of ABS</p> <p>Article No. 37.71.10 A</p> 	<p>Underwater spotlight made of white plastic with installation recess made of ABS for foil pools, flange made of stainless steel with installation recess made of ABS</p> <p>Article No. 37.71.11 A</p> 	<p>Connection box made of plastic (distribution box)</p> <p>Article No. 37.79.26 B</p> 	<p>Double seal for underwater spotlights (37.71.10 and 37.71.11)</p> <p>Article No. 37.79.15 D</p>

Bazenske ljestve



Stainless steel ladder, type M, **wide** angled shape, ladder beam $d = 43$ mm, beams and steps made of stainless steel 1.4301 polished

3 steps with installation bracket

Article No. 37.21.18 C

4 steps with installation bracket

Article No. 37.21.19 C

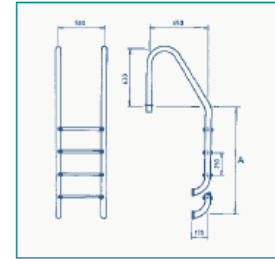

Stainless steel ladder type T, **narrow** angled shape, ladder beam $d = 43$ mm, beams and steps made of stainless steel 1.4301 polished

3 steps with installation bracket

Article No. 37.21.20 C

4 steps with installation bracket

Article No. 37.21.21 C

Flange fastening for 3- and 4-step ladder, suitable for type T (narrow angled) and type M (wide angled)

Article No. 37.29.18 C

Stainless steel pivot joints (pair) for all ladder beams, $d = 43$ mm, suitable for type T (narrow angled) and type M (wide angled)

Attachable sleeve for **installation bracket**

Article No. 37.29.19 C

Flange fastening

Article No. 37.29.20 C

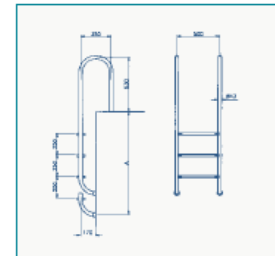

Stainless steel ladder type T, **divided**, ladder beam $d = 43$ mm, beams and steps made of stainless steel 1.4301 polished

3 steps with flange fastening

Article No. 37.21.22 C

4 steps with flange fastening

Article No. 37.21.23 C

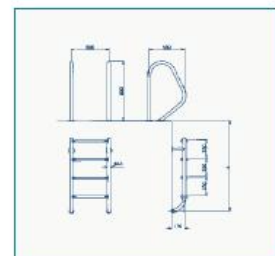



Stainless steel ladder type R for surface-mounting pools, ladder beam $d = 43$ mm. Plastic steps and plastic platform

Pool height m	Steps	Article No.
1.2/0.4	4/1	37.21.24 C
1/1	3/3	37.21.25 C
1.2/1.2	4/4	37.21.26 C
1.35/1.35	5/5	37.21.27 C
1.5/1.5	5/5	37.21.28 C

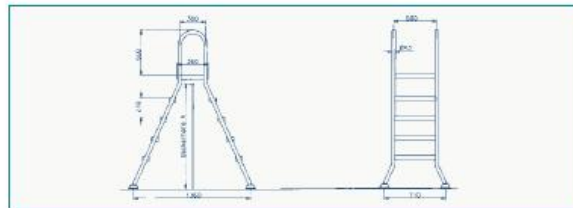

No. of steps	4/4	4/1	3/3
Pool height A	1.2/1.2 m	1.2/0.4 m	1.0/1.0 m

New low-priced ladder, ladder beams of steel, painted, $d = 25$ mm, pool height 1.2/1.2 m, steps 4/4

Article No. 37.21.29 C



Pokrivi za bazene

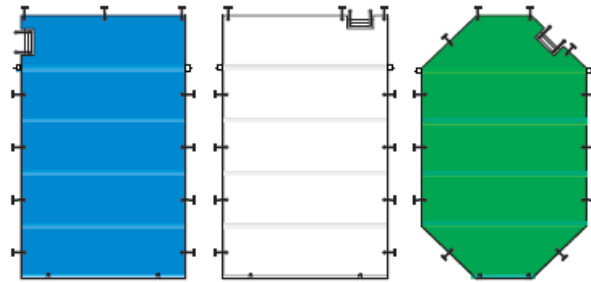

Pokrivi za bazene, su izolacijski pokrivi koji služe kao zaštita od vanjskih utjecaja, od zmrznoće koje mogu uletjeti u bazen, te služe kao sigurnosni pokrivi

SUNNY SAFE® S	
Blue	Article No. 32.61.97 D
Green	Article No. 32.61.99 D
White	Article No. 32.61.98 D
Packaging costs	Article No. 32.60.50
Roller gear with hand crank	
1 : 3	Article No. 32.91.15 E
1 : 7	Article No. 32.91.10 E
Ground anchor	Article No. 51.11.43

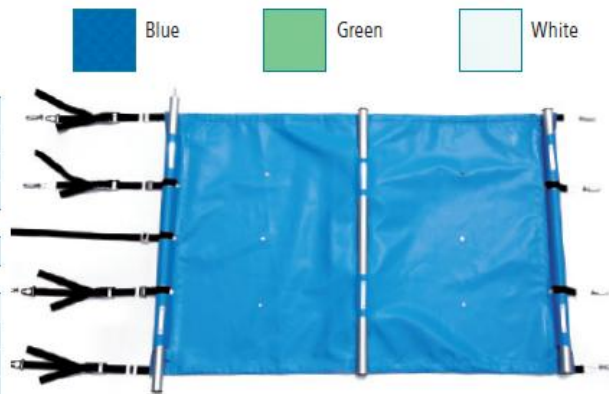

Snow load safeguard for SUNNY SAFE® S and SUNNY SAFE®	
Pool width up to 3 m	Article No. 32.60.12 D
Pool width up to 4 m	Article No. 32.60.13 D
Pool width up to 5 m	Article No. 32.60.14 D
Pool width up to 6 m	Article No. 32.60.15 D

SUNNY SAFE®	Article No.
Blue	32.60.97 E
White (translucent)	32.60.98 E
Green	32.60.99 E

Roller gear with hand crank	
1 : 3	Article No.32.91.15 E
1 : 7	Article No.32.91.10 E

	Article No.
Cut-outs (e.g. for ladders)	32.60.10 D
Chamfer	32.60.11 D
Ground anchor	51.11.26
Bungee strap with toggle	51.90.17

Packaging costs	32.60.50
-----------------	----------

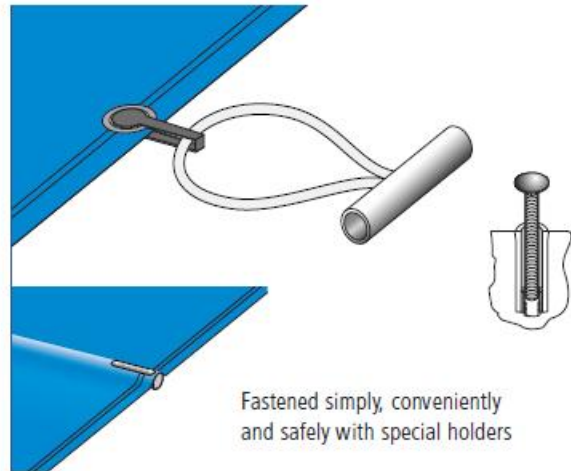

Fastened simply, conveniently and safely with special holders



Winter cover (green)	Article No. 32.70.99 D
Winter cover (blue)	Art.Nr. 32.70.98 D

Cut-outs (e.g. for ladders)	Article No. 32.70.10 D
-----------------------------	------------------------



Solarni grijači vode za bazene



Kako radi: solarni sustav je instaliran u postojeći filterar krug.

Pumpa filtera također radi na solarni sustav.

Motorni ventil je postavljen na postojeće cijevi.

T-komad mora biti postavljen zbog filtera, povratna cijev vodi iz solarnog sustava natrag u cijev bazena, gdje je potreban drugi T-komad.

Motor obrnutog ventila kontrolira elektronski kontroler temperature. On dobiva informacije iz solarnog senzora koji je montiran na kolektor, a iz vode od senzora koji je ugrađen u cijevi bazenske opskrbe. Vodeni senzor mjeri temperaturu vode u bazenu. Ako solarni senzor izmjeri temperaturu veću od one u bazenu, tada solarni kontroler prebacuje motor unazad i opskrba vode je blokirana.

To znači da će voda u bazenu sada teći preko krova kroz Solarni sustav.

Voda teče kroz pojedinačne cijevi i zagrijava se prije nego se vraća natrag kroz filter u bazen.

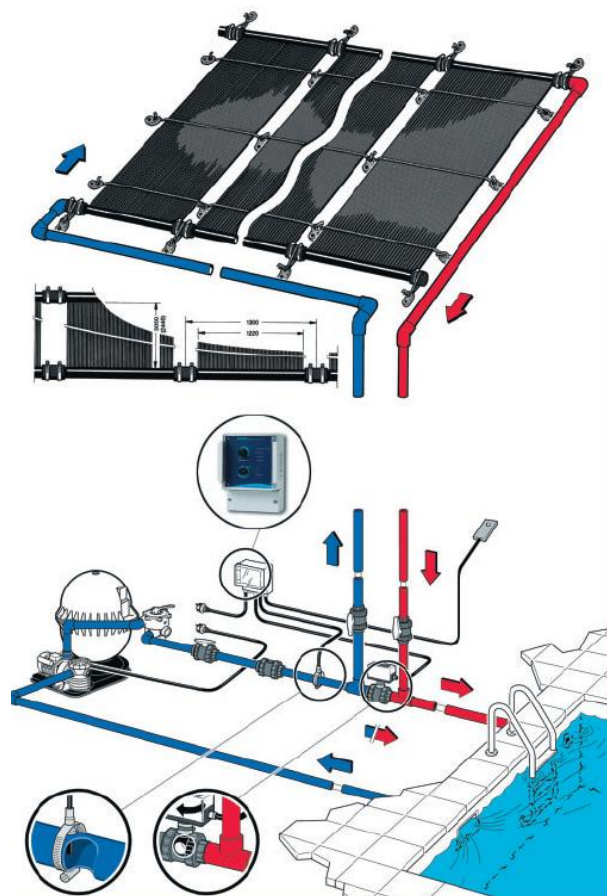

SUNNY FLEX® S - Premium class
The trend-setting solar system, latest technology



SUNNY PLATE
The world's top-selling product



SUNNY FLEX®
The extremely flexible, aesthetic version



SUNNY MAX
The simple, low-cost solution

