





# swimming pools and accessories

Economic-Sets

**Swimming pool:**

Steel plate 1.20 m high, 0.45 mm thick, steel wall with perforations for skimmer and inlet nozzle, galvanized, plastic-coated on the outside, lacquered on the inside, with **swimming pool foil 0.4 mm thick, blue**

**Filter system:**

Suspension filter IS 6 or sand filter system Sandy 8, tank diameter 400 mm with top mount valve, pump circulation rate 7 m<sup>3</sup>/h, self-priming pump



		Article No.
<b>Economic-Set 1</b>	Round pool ø 4 m, suspension filter IS 6	10.51.10 F
<b>Economic-Set 2</b>	Round pool ø 4 m, sand filter system, integrated skimmer set with inlet nozzle, flange and seals	10.51.11 F
<b>Economic-Set 3</b>	Round pool ø 5 m, suspension filter IS 6	10.51.12 F
<b>Economic-Set 4</b>	Round pool ø 5 m, sand filter system, integrated skimmer set with inlet nozzle, flange and seals	10.51.13 F
<b>Economic-Set 5</b>	Eight form pool 5.4 x 3.5 m, suspension filter IS 6	10.52.10 F
<b>Economic-Set 6</b>	Eight form pool 5.4 x 3.5 m, sand filter system, integrated skimmer set with inlet nozzle, flange and seals	10.52.11 F

**i** All our foils are thermoplastics. Temperatures constantly above 28°C can cause pleating. The maximum constant temperature for fabric-reinforced foils is 32°C.



## Round swimming pools

Round pools with a galvanized steel wall 0.6 mm thick (0.8 mm for pool depths of 1.5 m).  
 Also coated with polyester on the outside and protective lacquer on the inside. Aluminium slot-in profiles provide a sturdy connection of the steel wall ends, and can easily be detached again.  
 PVC handrail and ground rail.  
 PVC inner cover made of UV-stabilized, tearproof, cold-resistant foil, always with special MTH liner wedge profile.



Steel wall 0.6 mm / foil 0.6 mm blue							
Size	1.2 m deep	1.5 m deep	PE cover tarpaulin	Air bubble foil (round)	Provence stones *		
ø m	Article No.	Article No.	Article No.	Article No.	Article No.	Article No.	
4.00	10.11.12 D		32.11.15 D	32.21.15 D	38.15.12 E		
5.00	10.11.15 D	10.31.12 D	32.11.19 D	32.21.19 D	38.15.15 E		
6.00	10.11.16 D	10.31.13 D	32.11.21 D	32.21.21 D	38.15.16 E		
7.00	10.11.17 D	10.31.14 D	32.11.23 D	32.21.23 D	38.15.17 E		
8.00	10.11.18 D	10.31.15 D	32.11.25 D	32.21.25 D	38.15.18 E		
9.00	10.11.19 D	10.31.16 D	32.11.27 D				
10.00	10.11.20 D	10.31.17 D	32.11.28 D				

\* Transport fee for edge stones are extra and not included

### Pool surcharge for all pools compared to blue foil 0.6 mm:

- Foil 0.75 mm: •Florida •Naxos 15%
- Foil 0.8 mm: •marble •pale blue •white •sand 12%;  
•blue and turquoise 8%

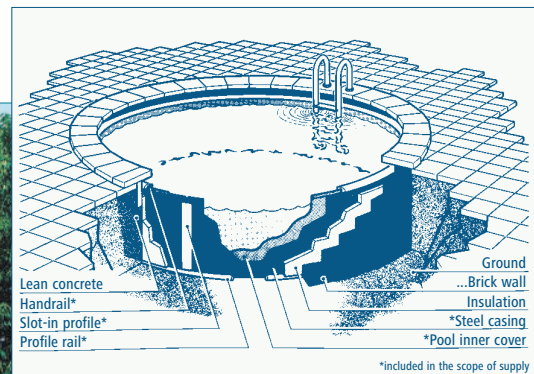

For steps: foil must be produced in a special size for steps in the round. Please always state with the order.

## Eight form swimming pool

Eight form pools with a galvanized smooth steel wall 0.6 mm thick (0.8 mm for pool depth of 1.5 m).

Also coated with polyester on the outside and protective lacquer on the inside. Aluminium slot-in profiles provide a sturdy connection of the steel wall ends, and can easily be detached again.

PVC handrail and ground rail.

PVC inner cover made of UV-stabilized, tearproof, cold-resistant foil, always with special MTH liner wedge profile. The steel structure for the eight form pool consists of vertical supports with divided cross stays. All parts are galvanized.



### Foil 0.6 mm blue

Size	1.2 m deep Steel wall 0.6 mm	1.5 m deep Steel wall 0.8 mm	PE cover tarpaulin	Air bubble foil (oval)	Provence stones *
ø m	Article No.	Article No.	Article No.	Article No.	Article No.
5.25 x 3.20	10.14.10 D	10.34.10 D	32.12.10 D	32.22.10 D	38.15.40 E
5.40 x 3.50	10.14.11 D	10.34.11 D	32.12.11 D	32.22.11 D	38.15.41 E
6.25 x 3.60	10.14.12 D	10.34.12 D	32.12.12 D	32.22.12 D	37.15.42 E
7.25 x 4.60	10.14.14 D	10.34.14 D	32.12.14 D	32.22.14 D	38.15.44 E
8.55 x 5.00	10.14.16 D	10.34.16 D	32.12.16 D	32.22.16 D	38.15.46 E
9.20 x 6.00	10.14.17 D	10.34.17 D	32.12.17 D	32.12.17 D	38.15.47 E

\* Transport fee for edge stones are extra and not included

### Pool surcharge for all pools compared to blue foil 0.6 mm:

**Foil 0.75 mm:** •Florida •Naxos 15%

**Foil 0.8 mm:** •marble •pale blue •white •sand 12%;  
•blue and turquoise 8%

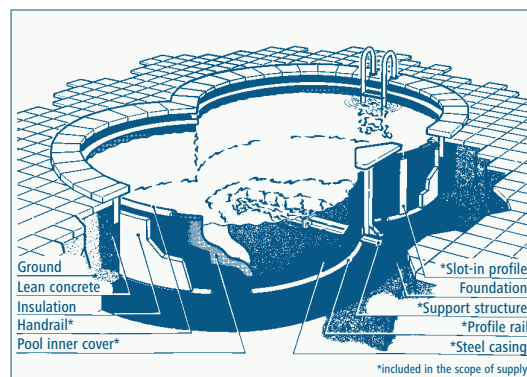

Polyester steps 1.5 mm wide. For simple installation in the steel casing. Only suitable for pools with a depth of 1.5 m. Description see 19





## Oval shape swimming pool

Oval swimming pool without steel structure. Only for installation in the ground with support wall made of hollow concrete bricks filled with lean concrete and steel reinforcement, or without backfilling with a special support wall made of steel elements. The swimming pool consists of a galvanized, plastic-coated steel casing 0.6 mm thick (or 0.8 mm thick for a depth of 1.50 m), peripheral PVC handrail and ground rail, PVC inner cover made of UV-stabilized, tearproof and cold-resistant foil always with special MTH liner wedge profile.



Foil 0.6 mm blue						
Size	1.2 m deep Steel wall 0.6 mm	1.5 m deep Steel wall 0.8 mm	PE cover tarpaulin	Provence stones *		
m	Article No.	Article No.	Article No.	Article No.	Article No.	Article No.
4.90 x 3.00	10.17.10 D	10.37.10 D	32.13.10 D		38.15.60 E	
6.30 x 3.60	10.17.12 D	10.37.11.D	32.13.19 D		38.15.62.E	
7.37 x 3.60	10.17.14 D	10.37.12 D	32.13.26 D		38.15.64 E	
8.00 x 4.00	10.17.15 D	10.37.14 D	32.13.28 D		38.15.65 E	
9.16 x 4.60	10.17.18 D	10.37.16 D	32.13.35 D		38.15.69 E	
9.00 x 5.00	10.17.19 D	10.37.18 D	32.13.34 D		38.15.70 E	
10.30 x 5.00	10.17.20 D	10.37.19 D	32.13.40 D		38.15.72 E	
11.00 x 5.50	10.17.21 D	10.37.20 D	32.13.41 D		38.15.73 E	

\* Transport fee for edge stones are extra and not included

### Pool surcharge for all pools compared to blue foil 0.6 mm:

- Foil 0.75 mm: •Florida •Naxos 15%
- Foil 0.8 mm: •marble •pale blue •white •sand 12%;  
•blue and turquoise 8%



Polyester steps 1.5 mm wide. For simple installation in the steel casing. Only suitable for pools with a depth of 1.5 m.

Description see 19

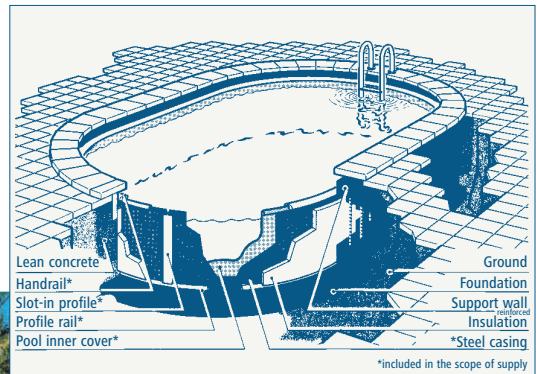

# SUNNY POOL®



## Metal-tec

Designer swimming pool in silver-grey metallic\* to meet the very highest demands. The exclusive special edition really is a sight to be seen and is most effective in free-standing solutions or pools partly installed in the ground.

The pool consists of a galvanized steel wall 0.7 mm thick and is 1.35 m high, with perforations for skimmer and nozzle. On the outside it is coated with polyester plastic, and with protective lacquer on the inside.

Aluminium slot-in profiles provide a sturdy connection of the steel wall ends, and can easily be detached again.

The PVC handrail and ground rail are also designed in elegant silver-grey metallic\*. The PVC inner cover "Florida" made of UV-stabilized, tearproof, cold-resistant foil 0.75 mm thick with - special MTH liner wedge profile is not only elegant and stable but also practical: dirt and stains are less obvious.

\* RAL 9006



Metal-tec SUNNY POOL® is available as round pool and oval pool.

The oval pool is erected optionally with a steel structure (see support walls  13) or can be partly installed in the ground.

Alternatively, it is also possible to use a support wall made of hollow concrete bricks (filled with lean concrete) with steel reinforcement. The metallic design is particularly attractive in pools partly installed in the ground on a slope.

### Metal-tec SUNNY POOL®, foil Florida 0.75 mm

Size	1.35 deep Steel wall 0.7 mm	PE cover tarpaulin	Air bubble foil (round)
m ø / m	Article No.	Article No.	Article No.
5.00	10.23.10 D	32.11.19 D	32.21.19 D
6.00	10.23.11 D	32.11.21 D	32.21.21 D
			(oval)
7.37 x 3.60	10.29.10 D	32.13.26 D	32.23.26 D
8.00 x 4.00	10.29.11 D	32.13.28 D	32.23.28 D

### A stainless steel ladder is also available to go with the Metal-tec SUNNY POOL®.

Stainless steel ladder type R for surface-mounting pools 1.35 m high, platform and steps made of white plastic. Ladder beam diameter = 43 mm, 1.35 / 1.35, 5/5-steps

Art. No.  
37.21.27 C

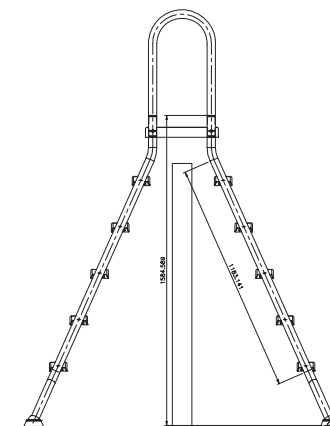



## Special support wall for oval pool

This prefabricated wall made of elements of the SUNSTAR® pool can be used to install the swimming pool on a hardened concrete slab in one single move. The walls are so robust that no backfilling is necessary. The pool can be filled with water immediately.

The scope of supply includes not only the segments and vertical supports but also the top and bottom U-profiles, screws and nuts, and the heavy-duty dowels.



**i**

The support walls withstand the static water pressure. After installation, suitable material must be used for backfilling. The system does not compensate for dynamic forces resulting from use of the swimming pool, e.g. diving, so that the system cannot be erected as a surface-mounted solution without backfilling. The insulation material between support wall and steel wall must compensate at least the outer overhang of the handrail to avoid a push in of the steel wall.



Special support wall for oval pool with a depth of 1.5 m or 1.35 m for size

Set	1.5 m deep	1.35 m deep	No. of segments	No. of vertical supports
m	Article No.	Article No.		
6.30 x 3.60	25.33.10 F		12	6
7.37 x 3.60	25.33.11 F	25.33.12 F	16	6
8.00 x 4.00	25.33.13 F	25.33.14 F	16	6
9.16 x 4.60	25.33.15 F		18	8
9.00 x 5.00	25.33.16 F		18	8
10.30 x 5.00	25.33.17 F		22	8

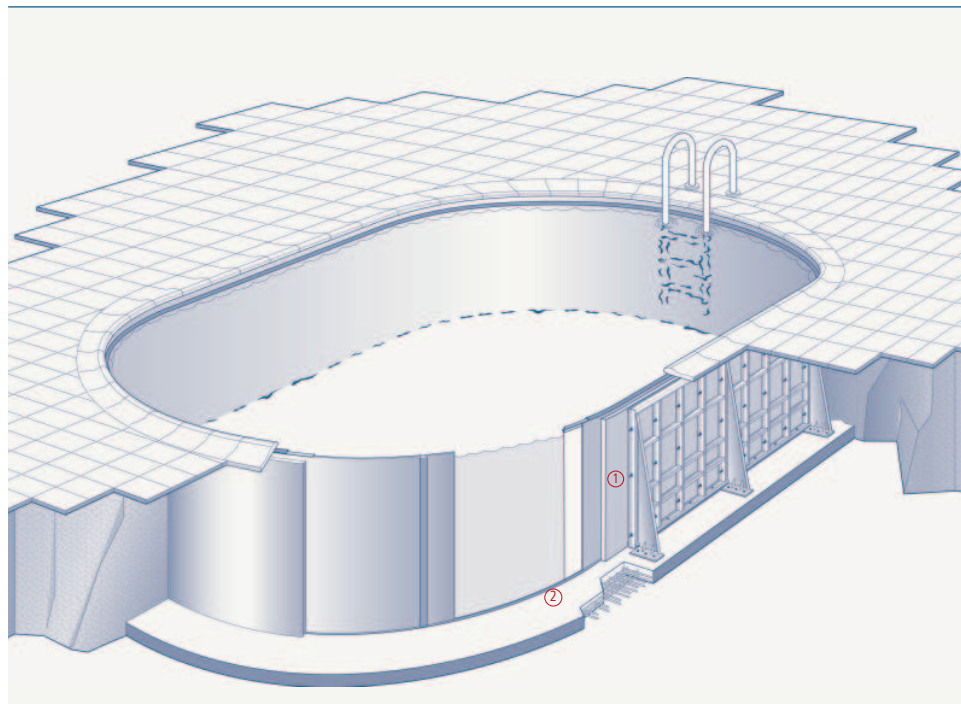

- ① Insulation (also necessary because of the ground rail)
- ② Ground rail

# SUNNY POOL®

## SUNSTAR® POOL

The SUNSTAR® pool is a prefabricated pool made of available steel segments measuring 0.5 m or 0.25 m in width and 1.5 m in height, which are screwed together.

The SUNSTAR® pool can be supplied in all dimensions, based on a grid size of 0.25 m in length and width.

The segments are made of high-strength, galvanized and plastic-coated steel. This modern material was developed for the automotive industry, and offers not only the greatest possible strength but also a high level of corrosion resistance. As a result, the elements offer high stiffness values while at the same time reducing the weight. One element weighs only just 13 kg.

The high corrosion resistance gives the whole system a long service life, so that we give a 10-year guarantee on the pool against rusting through\* and also on the imperviousness of the foil (the guarantee does not cover discolouring and pleating). As a rule, the lining consists of a blue prefabricated swimming pool liner 0.8 mm thick.



It goes without saying that a SUNSTAR® pool can also be lined with fabric reinforced foil 1.5 mm thick. In this case, the prefabricated inner liner is omitted.

Condition: No damaging on transport and assembly



Go to [www.mth-sunnypool.com/downloads](http://www.mth-sunnypool.com/downloads) to see the SUNNY POOL SUNSTAR® video!



(picture below): SUNSTAR® with Roman steps made of polyester.



SUNSTAR® is a registered trademark of MTH AG



## Scope of delivery

### 1. Pool

Galvanized, plastic-coated high-strength steel elements 0.5 m wide and 1.5 m high, + 1 element with skimmer cut-out for skimmer type 111 (Astral)

- 2 elements with nozzle cut-out for inlet nozzle
- 4 galvanized steel corner supports, steel interim supports at least every 2 m
- Galvanized and plastic-coated U-profiles to take the steel segments at the top and bottom
- Galvanized hex screws M10 with nuts and washers, heavy-duty dowels for fastening the corner and interim supports and steel segments to the concrete base slab
- Screws for fastening the suspension profiles
- Hard PVC fastening profile for fitting the wedge liner profile
- Keder to seal the profile for fitting the wedge liner profile (makes a neat finish and holds the wedge liner profile securely)
- 4 corner pieces (hard PVC fastening profiles bent into a quadrant shape so that the wedge liner profile can be fitted easily in the corners)
- 4 profiles of polyethylene foam, 1.5 m long, rounded (for adhering in the vertical pool corner)
- Pool inner cover, blue, 0.8 mm with wedge liner profile

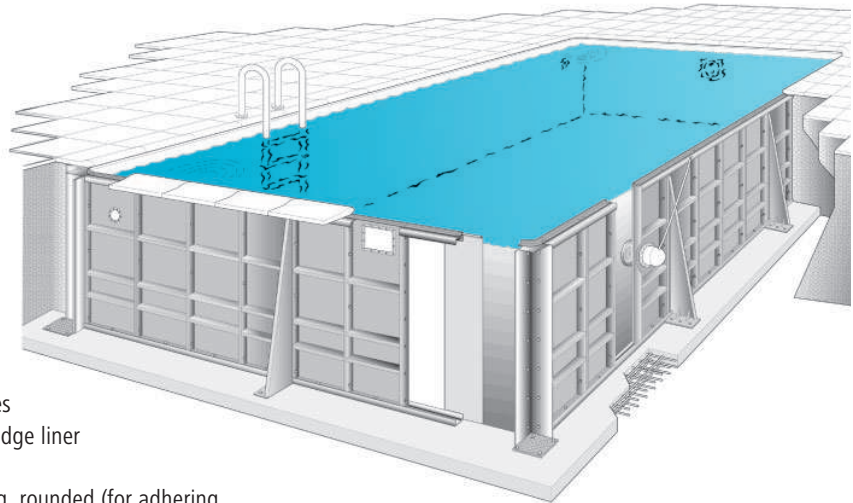

### Note:

See page 19 for sets of installation parts in various different versions (not included in the price).

### Pool surcharge for all pools compared to blue foil 0.8 mm:

Foil 0.75 mm: •Florida •Naxos 4.5%

Foil 0.8 mm: •marble •pale blue •white 2.5%, •turquoise without surcharge

Pool depth 1.5 m					
Pool size		Approx. volume		Edge stones colour Provence light	
m	m <sup>2</sup>	Article No.		Article No.	
6.0 x 3.0	27	11.21.10 F		38.12.28 E	
6.5 x 3.0	29	11.21.11 F		38.12.29 E	
6.5 x 3.5	34	11.21.12.F		38.12.30 E	
7.0 x 3.5	37	11.21.13 F		38.12.31 E	
7.5 x 3.5	39	11.21.14 F		38.12.32 E	
7.0 x 4.0	42	11.21.15 F		38.12.33 E	
7.5 x 4.0	45	11.21.16 F		38.12.34 E	
8.0 x 4.0	48	11.21.17 F		38.12.35 E	
8.0 x 4.5	54	11.21.18 F		38.12.36 E	
8.0 x 5.0	60	11.21.19 F		38.12.37 E	
8.5 x 4.5	57	11.21.20 F		38.12.38 E	
9.0 x 4.5	60	11.21.21 F		38.12.39 E	
9.0 x 5.0	67	11.21.22 F		38.12.40 E	
9.5 x 5.0	71	11.21.23 F		38.12.41 E	
10.0 x 5.0	75	11.21.24 F		38.12.42 E	
12.0 x 6.0	108	11.21.25 F		38.12.43 E	
Steel elements 0.25 m wide		25.34.11 F			
Steel elements 0.5 m wide		25.34.10 F			

## SUNSTAR® POOL with overflow channel

The successful SUNSTAR® range has undergone further development for even greater convenience and safety.

An overflow channel which fits perfectly with the SUNSTAR® structure improves safety aspects as well as keeping the water surface clean and enhancing pool hydraulics, thus improving the water quality.

Like the SUNSTAR® pool itself, the overflow channel is produced in Germany, thus vouching for the best possible quality and design.

The steel segments are designed in the same way as the SUNSTAR® pool but are somewhat shorter. The overflow channel is simply fitted onto the mounted segments and connected to the edges of the segments. If the segments have been carefully aligned, there will be no further need to adjust the overflow channel.

### Standard channel grating

200 mm wide.

The grating bars lie longitudinal in the direction of water movement. (not illustrated)

### Channel grating de luxe

200 mm wide. The grating bars of this extremely robust and elegant channel cover lie crosswise to the direction of water movement. This prevents water from spilling over to a great extent, as the design functions more-or-less like a mini breakwater. This results in even lower water consumption levels.



### The advantages at a glance

- Better extraction of the water surface
- Greater safety because the system prevents water from spilling over
- Installation of an overflow tank greatly reduces water losses because the overflowing water is cleaned and returned to the pool
- Swimming becomes an incomparable experience because the pool has no raised edge to hinder visibility

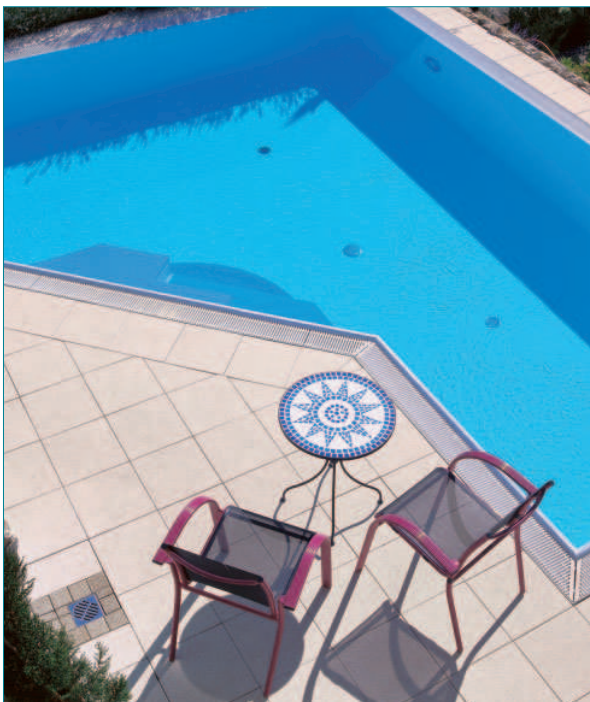

The standard overflow channel edge is semi-circular. This not only looks good but offers the additional advantage of better guidance when covering the pool with a roller shutter system. Please ask for an individual offer.

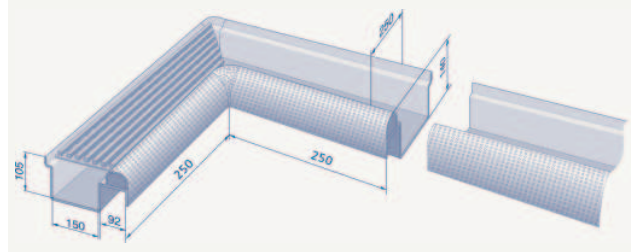

## Scope of delivery

### 1. Pool

- Galvanized, plastic-coated high-strength steel elements 0.5 m
- 4 galvanized steel corner supports, steel interim supports at least every 2 m
- Galvanized and plastic-coated U-profiles to take the steel segments at the bottom
- Galvanized hex screws M10 with nuts and washers
- Heavy-duty dowels for fastening the corner and interim supports and steel segments to the concrete base slab
- Cut-out for jet or underwater lights(surcharge)

### 2. Overflow channel system

- 4 corner pieces with inner leg length 250 mm
- Straight elements measuring 2000 mm, 1000 mm and 500 mm in length
- The overflow edge is semi-circular.
- The swimming pool foil is pushed under the foil at the overflow channel and welded in position.
- **The SUNSTAR POOL® with overflow channel cannot be supplied with a prefabricated liner.**
- 3 channel systems are available for public use. The overflow edge is then designed similar to the Finnish overflow channel (prices on request), not illustrated.

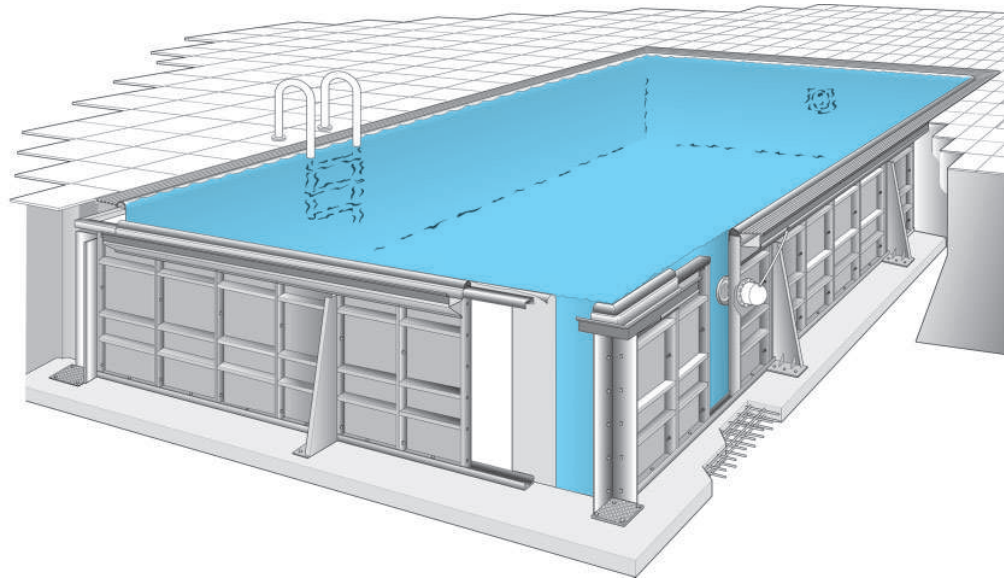

Pool depth 1.34 m *							
Pool size		Approx. volume		Channel grating Standard		Channel grating de Luxe	
m	m <sup>2</sup>	Article No.		Article No.		Article No.	
6.0 x 3.0	24	11.24.10 F		25.92.10 E		25.92.11 E	
6.5 x 3.0	26	11.24.11 F		25.92.12 E		25.92.13 E	
6.5 x 3.5	30	11.24.12 F		25.92.14 E		25.92.15 E	
7.0 x 3.5	33	11.24.13 F		25.92.16 E		25.92.17 E	
7.5 x 3.5	35	11.24.14 F		25.92.18 E		25.92.19 E	
7.0 x 4.0	38	11.24.15 F		25.92.20 E		25.92.21 E	
7.5 x 4.0	40	11.24.16 F		25.92.22 E		25.92.23 E	
8.0 x 4.0	43	11.24.17 F		25.92.24 E		25.92.25 E	
8.0 x 4.5	48	11.24.18 F		25.92.26 E		25.92.27 E	
8.0 x 5.0	54	11.24.19 F		25.92.28 E		25.92.29 E	
8.5 x 4.5	51	11.24.20 F		25.92.30 E		25.92.31 E	
9.0 x 4.5	54	11.24.21 F		25.92.32 E		25.92.33 E	
9.0 x 5.0	60	11.24.22 F		25.92.34 E		25.92.35 E	
9.5 x 5.0	64	11.24.23 F		25.92.36 E		25.92.37 E	
10.0 x 5.0	67	11.24.24 F		25.92.38 E		25.92.39 E	
12.0 x 6.0	97	11.24.25 F		25.92.40 E		25.92.41 E	
Steel elements 0.25 m wide		25.35.13 F					
Steel elements 0.5 m wide		25.35.10 F					

\* Pool depth of 1,5 m available on request

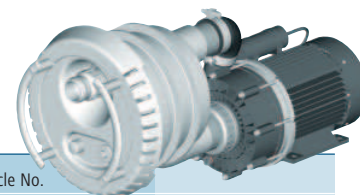

	Article No.	
<b>Set of installation parts, plastic (Astral)</b> Plastic skimmer, plastic inlet nozzles 2 x, floor drain plastic	11.29.21 C	
<b>Set of installation parts, plastic (OWM)</b> Plastic skimmer, plastic inlet nozzles 2x (Astral), floor drain plastic	36.49.10 C	
<b>Set of installation parts stainless steel (V4A), made in Germany</b> Fitted skimmer B280 with sieve insert, flange and seal, stainless steel inlet nozzles with set of locking parts, floor drain stainless steel type 190	11.29.22 D	
<b>Swim-Jet (Speck) set ready for installation.</b> Flooding system, round fitting made of plastic complete with PN switching device, Connection set with integrated mounting bracket, power output: 2.6 kW three-phase current, power consumption: 3.3 kW three-phase current, pumping rate 50 m³/h, see  84	37.82.36 D	
<b>Set of installation parts</b> , installation depth 240 mm, including plastic flange set	37.82.35 D	
<b>Console</b>	37.89.25 D	
<b>Set of underwater lights, plastic (Astral)</b> <ul style="list-style-type: none"> <li>• 2 plastic underwater lights with flange (Art. No. 37.71.10)</li> <li>• Transformer 600 VA (Art. No. 37.79.31)</li> <li>• 2 plastic connection boxes (Art. No. 37.79.26)</li> <li>• Cut-outs for 2 underwater lights (Art. No. 11.29.11)</li> </ul>	37.72.10 C	
<b>Set of underwater lights, plastic (OWM)</b> <ul style="list-style-type: none"> <li>• 2 plastic underwater lights with flange (Art. No. 37.74.11)</li> <li>• Transformer 600 VA (Art. No. 37.79.31)</li> <li>• 2 plastic connection boxes (37.74.32)</li> </ul>	37.72.14 C	
<b>Set of underwater lights, stainless steel</b> 2 underwater underwater lights 12V/300W, 2 flanges for UWS, 2 distribution boxes, 2 cut-outs in steel segment, transformer 600 VA	37.72.13 C	
<b>Cut-out for jet or underwater lights in the Swim-tec® range</b>		
<b>Cut-out for GSA (11.29.10), UWS (11.29.11)</b>		
<b>Cut-out for skimmer (11.29.13), nozzle (11.29.14)</b>		
<b>Cut-out for other parts on request</b>	11.29.12 F	
<b>Roman steps</b> We offer three attractive versions of Roman steps for our SUNSTAR® POOL, made of polyester, measuring 1.5 m, 2.5 m and 3 m in width. Standard colour white with steps in contrasting blue.		
<b>Steps 1.5 m wide</b>	11.29.17 F	
<b>Steps 2.5 m wide</b>	11.29.16 F	
<b>Steps 3 m wide</b>	11.29.15 F	
<b>Corner steps (only for use with 1.5 mm foil)</b> 2.0 x 2.0 m for SUNSTAR® POOL. White, steps azure blue	11.29.23 F	
<b>Special element for 1.5 m pool depth</b> Segment 25 cm wide may be necessary to fit installed parts in the middle	25.34.11 F	
Segment 50 cm wide	25.34.10 F	

# Swim-tec®

## Polyester steps

Steps made of fibreglass reinforced polyester with foil flange. These steps are essentially identical with the step system in the Swim-tec® pool. But equipped with foil flange and thus suitable for nearly all pool designs lined with foil or with an inner cover. For example, SUNSTAR® POOL, pool made of polystyrene elements or also brick wall pools.

The back of the steps are equipped with two robust steel pipe supports which can be adjusted in height exactly to the size of the pool. Each flange comes with two wall anchors for pools with brick walls or made of polystyrene elements.

Three sizes of steps are available:

2.5 m, 3.0 m and 1.5 m wide. The small steps can also be used for all round, oval and eight form SUNNY POOL®'S (height 1.5 m).



Standard colour: white with blue contrasting steps. Number of steps: 4 steps; steps including wooden transport packaging.

Size	White with blue steps	Pale blue with white steps	Medium blue with white steps
W x D x H	Article No.	Article No.	Article No.
3.0 m x 1.25 m x 1.5 m	37.23.10 F	37.23.11 F	37.23.12 F
2.5 m x 1.0 m x 1.5 m	37.23.13 F	37.23.14 F	37.23.15 F
1.5 m x 1.0 m x 1.5 m	37.23.16 F	37.23.17 F	37.23.18 F
<b>Corner steps</b> (only for use with 1.5 mm foil)			
2.00 x 2.00 x 1.50 m with inner steps	37.23.19 F	37.23.20 F	37.23.21 F

Freight charge are not included

### **i** Note

Any bleaching or discolouring caused by the effects of direct sunlight and water care chemicals are not covered by the guarantee.

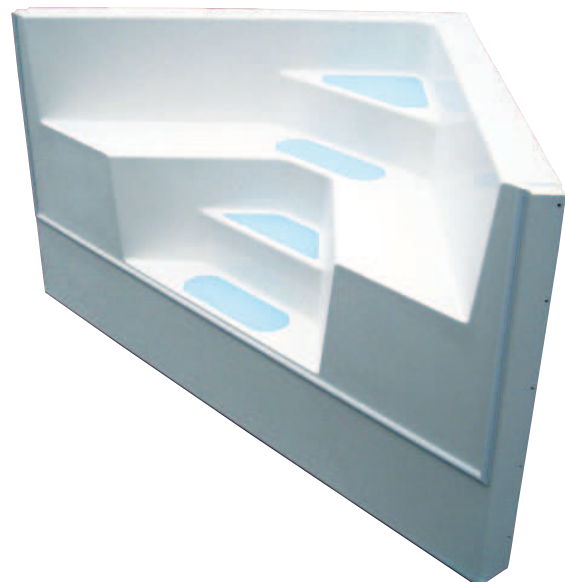

Polyester steps

- 37.23.16
- 37.23.17
- 37.23.18

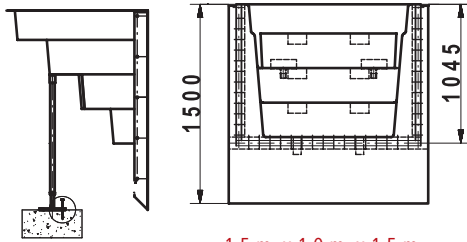
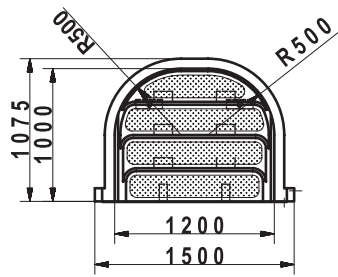

- 37.23.13
- 37.23.14
- 37.23.15

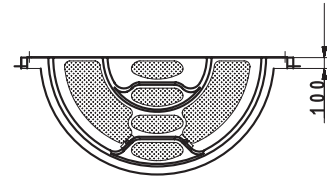
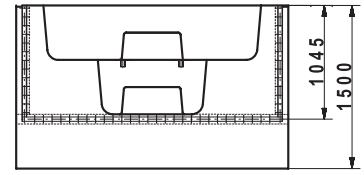
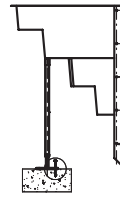
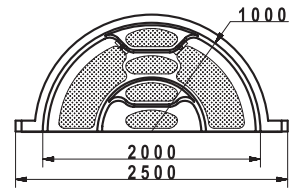

2.5 m x 1.0 m x 1.5 m

- 37.23.10
- 37.23.11
- 37.23.12

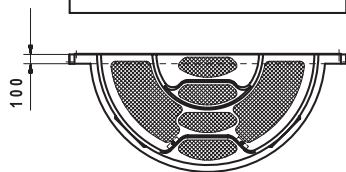
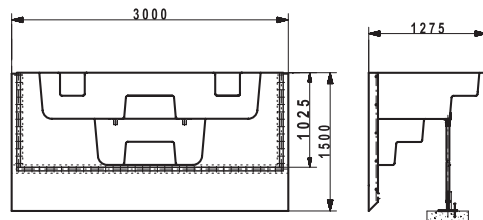
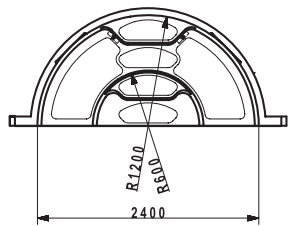

3.0 m x 1.25 m x 1.5 m

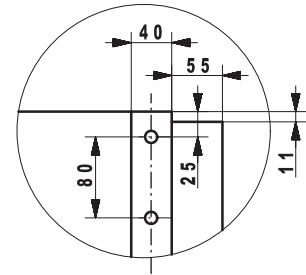

nut M10 DIN 934  
washer 10 DIN 9021

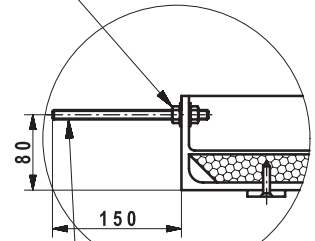

long thread M 10x195 DIN 975

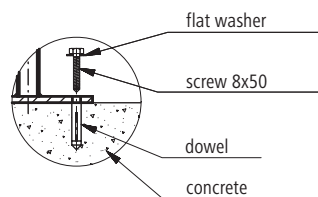
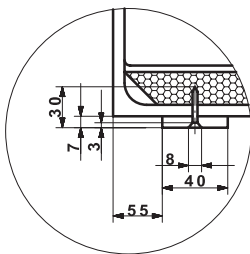

stairs, 1500 mm high  
can be shortened to 1200 mm

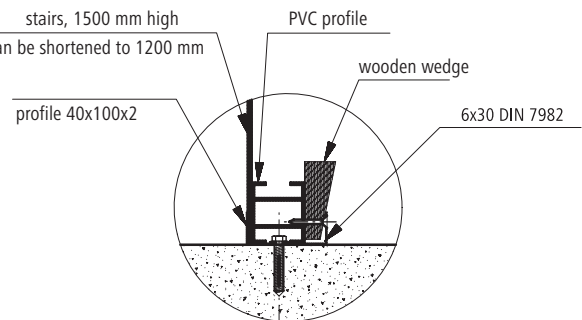



# WE CREATE HOLIDAY ...take a rest.

INNOVATIVE PRODUCTS FOR YOUR POOL



**MTH**<sup>AG</sup>  
MODERNE WASSERTECHNIK

[www.mth-sunnypool.com](http://www.mth-sunnypool.com)

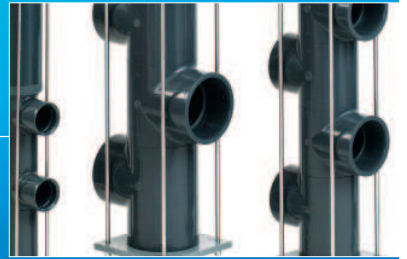
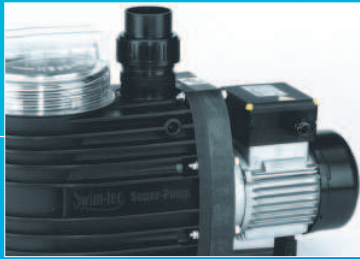



# **swimming pool technology**

## **filters & pumps**

# Economy sand filter systems



Economic sand filter system		
		Article No.
<b>Sandy 5</b>	with new plastic pump Swimtec-Trend 50	20.11.10 D
<b>Sandy 8</b>	with plastic pump Swimtec-Trend 70 and 6-way Top Mount valve (Speck)	20.11.11 D
<b>Sandy 8 Super</b>	with plastic pump Swimtec-Trend 90 and 6-way Top Mount valve (Speck)	20.11.12 D
<b>Sandy 10 Top Mount</b>	with Speck plastic pump Magic 11 and 6-way Top Mount valve (Speck)	20.11.13 D
<b>Sandy 10 Side Mount</b>	with Speck plastic pump Magic 11 and 6-way Side Mount valve	20.11.14 D
<b>Filter sight glass</b>	1½" x 38 mm hose	20.93.10 D
<b>Filter sight glass</b>	1½" x 50 mm adhesive bushing	20.93.11 D



	<b>Sandy 5</b>	<b>Sandy 8</b>	<b>Sandy 8 Super</b>	<b>Sandy 10 Top Mount</b>	<b>Sandy 10 Side Mount</b>
Filtration rate	5-6 m³/h	6-7 m³/h	7-9 m³/h	9-11 m³/h	9-11 m³/h
Tank diameter	0.38 m	0.4 m	0.4 m	0.5 m	0.5 m
Filter surface	0.11 m²	0.13 m²	0.13 m²	0.20 m²	0.20 m²
Tank material	Polyethylene	Polyester	Polyester	Polyester	Polyester
Power output P2	180 W	250 W	400 W	450 W	450 W
Electrical connection	230 V, 50 Hz	230 V, 50 Hz	230 V, 50 Hz	230 V, 50 Hz	230 V, 50 Hz
Dimensions (L x W x H in mm)	730 x 470 x 860	644 x 473 x 827	644 x 473 x 827	750 x 535 x 925	778 x 740 x 805
Weight without sand					
with packaging	18 kg	24 kg	24 kg	30 kg	32 kg
Sand quantity	40 kg	40 kg	40 kg	50 - 60 kg	50 - 60 kg
for pools up to	25 m³	30 m³	45 m³	60 m³	60 m³



# Fine sand filter systems for private swimming pools

Fully developed, reliable technology and pioneering design, premium Quality

## The SUPRAPLAST® fine sand filter range:

The MTH fine sand filters with the trade name SUPRAPLAST® embody state-of-the-art filter technology and demonstrate our many years of know-how in sand filter construction.

And this is all to your advantage, because the SUPRAPLAST® fine sand filters by MTH are devices with a long service life, low procurement price and very low maintenance costs.

One of the main reasons for this is the filter tank in the SUPRAPLAST® series. It is made using the SMC method (hot pressing of prepreg resin mats) from glass-fibre reinforced polyester (GRP). This method guarantees filter tanks of uniform quality, great strength, temperature resistance from -40°C to +120°C and an identically smooth surface on the inside and outside.

Simple filter tanks made of injected thermoplasts or even blown PE tanks are just not comparable in terms of quality when it comes to strength, service life, temperature resistance and UV resistance.

This first-rate tank and the top quality backwashing system with individually replaceable nozzle arms are indispensable for good backwashing results.

Tanks with a diameter of 600 mm have computer calculated nozzle arms which are responsible for uniformly intensive backwashing across the whole surface – almost the same as the nozzle base prescribed for public systems.

## Impressive design and perfect technology

- The filter tank made of glass-fibre reinforced plastic, with an identically smooth surface on the inside and outside, offers great strength and temperature resistance up to 120°C.
- Robust fins warrant the great strength of the divided tank.
- Top quality plastic is used to make all parts of the filter and prevents any corrosion.
- Easy for servicing:  
The upper half of the filter tank can be taken off to replace the sand, without having to disconnect the pipes.
- Proven, reliable 6-way plastic valve with pressure gauge and sight glass makes the filter so convenient and ensures it is easy to use.
- Self-priming, quiet circulation pump with overload protection for single phase pump and integrated pre-filter.
- Manual air release, an extra feature in addition to automatic air release valve.
- Automatic backwashing system available on request for all filters.
- And last but not least, functional design that is impressive to look at.



### **i** Filtering speed

The filtering speed in m/h indicates the quality of physical filtration in a sand filter. The greater the filtering speed, the poorer the filtering results. In a private swimming pool, the filtering speed should not exceed 50 m/h.

The DIN standard, for example, states that in public swimming pools, the filtering speed must not exceed 30 m/h.

SUPRAPLAST® is a registered trademark of MTH AG.

# Sand filter systems for private swimming pools

## Sand filter SUPRAPLAST® equipped with KSB or Speck pumps



KS 12 W and KS 12 D

**☑ All KSB and Speck pumps featured here are naturally self-priming.**

Type	Article No.	Pump type	Filtration rate	Tank	Filter surface	Mean filtering speed
			m <sup>3</sup> /h	Ø in m	m <sup>2</sup>	m/h
KS 7 W	20.11.15 D	Speck Badu 90/7W	6.0 - 8.5	0.45	0.16	44
KS 9 W	20.11.16 D	Speck Badu 90/11W	8.5 - 11.0	0.45	0.16	56
KS 9 D	20.11.17 D	Speck Badu 90/11D	8.5 - 11.0	0.45	0.16	56
KS 9 W	20.12.10 D	KSB Filtra 8E	8.5 - 11.0	0.45	0.16	56
KS 9 D	20.12.11 D	KSB Filtra 8D	8.5 - 11.0	0.45	0.16	56
<b>BLUE LINE</b>						
KS 9 W	20.11.18 E	Superpump 12	8.0 - 10.5	0.45	0.16	56
KS 9 W	20.12.12 E	KSB Filtra 6E	8.0 - 10.5	0.45	0.16	56
KS 12 W	20.11.19 E	Superpump 14	9.0 - 13.0	0.60	0.28	43
KS 12 W	20.12.13 E	KSB Filtra 14E	9.0 - 13.0	0.60	0.28	43
KS 12 W	20.11.20 D	Speck Badu 90/15G-W	9.0 - 13.0	0.60	0.28	43
KS 12 D	20.11.21 D	Speck Badu 90/15G-D	9.0 - 13.0	0.60	0.28	43
KS 12 W	20.12.14 D	KSB Filtra 14E	9.0 - 13.0	0.60	0.28	43
KS 12 D	20.12.15 D	KSB Filtra 14D	9.0 - 13.0	0.60	0.28	43
KS 14 D	20.11.22 D	Speck Badu 90/20G-D	10.0 - 15.0	0.60	0.28	50
KS 14 D	20.12.16 D	KSB Filtra 18D	10.0 - 15.0	0.60	0.28	50
KS 16 D *	20.11.23 D	Speck Badu 90/20 D	10.0 - 17.0	0.60	0.28	57
KS 16 D *	20.12.17 D	KSB Filtra 18D	10.0 - 17.0	0.60	0.28	57

W = single phase 230V | D = three phase 400V, \* filters KS 16 have 2" 6-way valves

All sand filters from KS 9 can also be equipped with a quiet bronze pump on request at a surcharge. SUPRAPLAST® is a registered trademark of MTH AG



KS 9 W and KS 9 D



KS 16 D



Typ KS 12 BLUE LINE Superpump



Typ KS 9 BLUE LINE KSB



Typ KS 12 BLUE LINE KSB

BLUE LINE: high quality for a low price



KS 16 D



max. pool size	Power consumption P1	Power output P2	Electrical connection	Sand quantity	Net weight	Gross weight	Packaging
in m <sup>3</sup>	in kW	in kW	Voltage	kg	kg	kg	L x B x H in mm
40	0.50	0.30	230	45	28	33	770 x 770 x 780
60	0.65	0.45	230	45	28	33	770 x 770 x 780
60	0.66	0.45	3 ~ 400	45	28	33	770 x 770 x 780
60	0.70	0.40	230	45	28	33	770 x 770 x 780
60	0.70	0.40	3~400	45	28	33	770 x 770 x 780
60	0.65	0.45	230	45	28	33	770 x 770 x 780
60	0.65	0.35	230	45	28	33	770 x 770 x 780
80	0.95	0.65	230	75	45	51	850 x 900 x 880
80	0.90	0.63	230	75	45	51	850 x 900 x 880
80	1.10	0.75	230	75	45	51	850 x 900 x 880
80	1.00	0.75	3 ~ 400	75	45	51	850 x 900 x 880
80	0.90	0.63	230	75	45	51	850 x 900 x 880
80	0.90	0.63	3 ~ 400	75	45	51	850 x 900 x 880
100	1.32	1.00	3 ~ 400	75	46	52	850 x 900 x 880
100	1.15	0.80	3 ~ 400	75	46	52	850 x 900 x 880
100	1.32	1.00	3 ~ 400	75	46	52	850 x 900 x 880
100	1.15	0.80	3 ~ 400	75	46	52	850 x 900 x 880



KS 7 W, KS 9 W, KS 9 D



KS 12 W, KS 12 D, KS 14 D



Filter tank SUPRAPLAST®

## Filter & Accessories

	Article No.
Filter tank SUPRAPLAST®, ø 450 mm	20.91.10 D
Filter tank SUPRAPLAST®, ø 600 mm	20.91.11 D
Pallet made of glass-fibre reinforced plastic, with soundproofing effect	20.93.12 D
Filter pallet for KS 7 and KS 9 with integrated filter foot made of plastic	20.93.13 D
Rubber soundproofing plate for KS 7+9	20.93.15 D
Filter pallet for KS 10 to KS 16 and High SUPRAPLAST® with integrated plastic filter foot	20.93.14 D
Rubber soundproofing plate for KS 12, 14, 16	20.93.16 D



# Multi-layer sand filters for swimming pools

## Premium filter technology

### High SUPRAPLAST® filters with special carbon and basalt sand

- The combination of a new kind of basalt sand (the filter surface of basalt sand is 29% more effective than quartz sand) with special carbon clearly improves the quality of the swimming pool water.

#### Filter system:

Multi-layer filter with basalt and special carbon. 80 kg basalt and 72 kg special carbon included in the scope of supply.

#### Why additional special carbon?

Special carbon is even capable of removing part of the dissolved impurities which can normally no longer be separated out by other mechanical filtration processes. Odorants are mainly separated out by absorption, and the chloramines which are mainly responsible for the chlorine smell are absorbed, while naturally preserving the chlorine level.

Net weight: 78 kg (without filtration material)	
<b>Size</b>	
L x W x H	ø tank
1000 mm x 850 mm x 130 mm	600 mm

High SUPRAPLAST® is a registered trademark of MTH AG



	Article No.	
Filter tank High SUPRAPLAST®, ø 600 mm	20.91.14 D	
Filter pallet for KS 10 to KS 16 and High SUPRAPLAST® with integrated plastic filter foot	20.93.14 D	
Pallet of glass-fibre reinforced plastic	20.93.12 D	



#### Typ KS SH 14D

Tank made of top quality, glass-fibre reinforced polyester, tank diameter 600 mm, height 1.35 m, with extremely quiet bronze pump (Sta-Rite BRD 3), with manual reversing valve, 6-way valve 2", filtration rate 14 m³/h, filter material and Swim-tec® Pool Consulting control 400 V included in the scope of supply

Article No. 20.13.10 D



#### Typ KS SA 14D

Tank made of top quality, glass-fibre reinforced polyester, tank diameter 600 mm, height 1.35 m, with extremely quiet bronze pump (Sta-Rite BRD 3), with time-controlled automatic backwashing, 6-way valve 2", filtration rate 14 m³/h, filter material and Swim-tec® Pool Consulting control 400 V included in the scope of supply

Article No. 20.13.11 D

# Swimming pool Sandfilters – Series MTH 'private'



**i** BESGO valves and accessories, see **33**

## MTH 'private' sand filter tank with valve connection on the side

De luxe quality class in private swimming pools. Hand-made one-layer filters. Inside surface smoothed with polyester resin. The filters are installed where quality counts. The sand filters have a filter rating of approx. 50 micron. MTH 'private' standard filters are normally fed with one sand grain size.

- Filter tank made of glass-fibre reinforced polyester resin
- Tank absolutely corrosion-proof
- Extra reinforced inner piping and star distributor
- Available with a diameter of 610 mm – 1800 mm
- Max. operating pressure 2.5 bar

Type	Height	Filtration rate at 50m/h	Connection	Article No.
ø mm	mm	m³/h	d	
610 *	1080	14.0	50	20.91.47 D
765 *	1150	22.5	63	20.91.48 D
920 *	940	32.5	63	20.91.49 D
1080	1110	46.0	90	20.91.50 D
1250	1600	61.5	90	20.91.51 D
1450	1800	77.0	110	20.91.52 D
1600	1900	100.0	125	20.91.53 D
1800	2000	127.0	140	20.91.54 D

\* 6-way valve included

## Sandfilter system – Series MTH 'de luxe'

Tank made of glass-fibre reinforced polyester D 610 mm, H: 1080 mm and D 765m H: 1160, with large service opening on the top and at the side, with integrated nozzle cross, drain tap and pressure gauge max. 2.5 bar. Filter pump Badu 90/11 W, particularly quiet. 2" BESGO automatic backwashing system with solenoid valve. Completely mounted on base plate.

### Sandfilter system 'de luxe' 610, ø 610 mm, Badu 90/13 W

2" BESGO automatic backwashing	Article No. 20.11.24 D
2" 6-way valve	Article No. 20.11.25 D

Filter material not included in the scope of supply. Filter filling: 50 kg, 0.7 – 1.0 mm and 150 kg 0.4 – 0.8 mm

### Sandfilter system 'de luxe' 765

ø 765 mm, Badu 90/20 W

2" BESGO automatic backwashing	Article No. 20.11.29 D
2" 6-way valve	Article No. 20.11.30 D

Filter material not included in the scope of supply. Filter filling: 100 kg, 0.7 – 1.0 mm and 200 kg 0.4 – 0.8 mm

## Multi-layer filter type KS SAB 13 W

Top quality divisible filter tank made of glass-fibre reinforced polyester. With Speck plastic pump Badu 90/13 W, DN40/d50, BESGO backwashing valve, Pool Consulting control for filter, heating, solar and backwashing. Including filter material, mounted on a polyester plate.

mit BESGO automatic backwashing	Article No. 20.13.12 D
---------------------------------	------------------------

Filter filling: 80 kg basalt and 72 kg special carbon N

## Filter materials

	Article No.
Quartz filter sand 0.4 – 0.8 mm grain size, 25 kg	20.92.10 D
Quartz filter sand 1.0 – 2.0 mm grain size, 25 kg	20.92.11 D
Quartz filter sand 2.0 – 3.15 mm grain size, 25 kg	20.92.12 D
Quartz filter sand 3.15 – 5.6 mm grain size, 25 kg	20.92.13 D

Basalt 0.4 – 0.8 mm, 40 kg. The surface of the basalt grain is 29% larger than quartz sand for the same grain size, so that basalt offers better filtration than quartz	20.92.16 D
Special carbon (anthracite N), 50 l = 36 kg	20.92.17 D

**Basalt + special carbon = better filtering results**



**i** The BESGO valves can be activated with our **Pool Consulting** and **Pool Consulting Plus** controls!



Quartz filter sand

Special carbon



Basalt

## Commercial swimming pool sandfilters

### Series MTH 'Star': high-layer sand filter with laterals



#### MTH 'Star' sand filter tank with valve connection on the side (private or commercial).

De luxe quality class in private swimming pools. Hand-made multi-layer filters. Inside surface smoothed with polyester resin. The filters are installed where quality and a long service life count. MTH high-layer filters are normally fed with several different sand grain sizes. The sand filters offer a filter rating of approx. 50 micron.

Activated carbon can also be used.

- Filter tank made of glass-fibre reinforced polyester resin
- Tank absolutely corrosion-proof
- Extra-reinforced inner piping and star distributor
- Special heights and customised versions available on request
- Sight glass available on request
- Available with a diameter of 610 – 1450 mm and a height of 1600 – 2700 mm
- Max. operating pressure 2.5 bar

Type	Height	Filtration rate at 50 m/h	Connection	Article No.	
ø mm	mm	m <sup>3</sup> /h	d		
610	1600	14.5	63	20.91.31 D	
610	1800	14.5	63	20.91.32 D	
765	1600	22.5	63	20.91.33 D	
765	1800	22.5	63	20.91.34 D	
920	1800	32.5	90	20.91.35 D	
1080	2500	46.0	90	20.91.36 D	
1250	2500	61.5	110	20.91.37 D	
1450	2700	82.5	125	20.91.38 D	

### Series MTH 'Public': DIN multi-layer filter for public pools



#### MTH 'Public' sand filter tank with valve connection on the side

The public MTH swimming pool filters are suitable for public pools in accordance with the German DIN 19643.

The filters are equipped with a special nozzle base. Inside surface smoothed with polyester resin.

- Filter tank made of glass-fibre reinforced polyester resin
- Tank absolutely atoxic and corrosion-proof
- Large service openings give easy access to inside the filter
- Sight glass made of top quality acrylic glass (PMMA)
- Additional sight glasses available on request
- Special heights and customised versions available on request
- Available with a diameter of 610 – 1800 mm and a height of 2100 – 2900 mm
- Max. operating pressure 2.5 bar, pressure test by expert to works standard
- Acknowledged tested product as per KSW/KTW

Type	Height	Filtration rate at 30 m/h	Connection	Article No.	
ø mm	mm	m <sup>3</sup> /h	d		
610	2100	8.7	75 / 90	20.91.40 D	
765	2200	13.5	90 / 110	20.91.41 D	
920	2350	19.5	90 / 110	20.91.42 D	
1080*	2500	27.6	110 / 140	20.91.43 D	
1250*	2500	36.8	140 / 160	20.91.44 D	
1450*	2700	49.5	140 / 160	20.91.45 D	
1800*	2900	76.3	160 / 180	20.91.46 D	

Executed in accordance with works standard, taking account of DIN 19605/19643. Heights can be reduced and have tolerances resulting from the production process. Surcharge for ozone-resistant inner coating 10%.

\* Also available in filling height 1.5 m

# Commercial Sand filter units



## Filter system consisting of:

- Plastic tank with complete piping
- 1 self-priming plastic filter pump
- 1 backwashing pump (at 30 m/h flow velocity)
- 1 manual backwashing valve 3" (only for  $\varnothing$  630 +  $\varnothing$  830)
- 1 manual control panel DN 125 (only for  $\varnothing$  1050 +  $\varnothing$  1260), optional BESGO valve at a surcharge for filling height 1200 mm, 30 m/h flow velocity with 2 filter pumps

Actual freight costs are charged



for filling heights 1200 mm to 1300 mm, jacket height 1700 mm, 30 m/h flow velocity with 2 pumps



All filter systems can be supplied with BESGO automatic valves at a surcharge

Tank outer $\varnothing$ mm	Height mm	Filtration rate* m <sup>3</sup> /h	Filter pump type	Article No.	
610	2,100	9	2 x 90 / 11	20.17.10 D	
765	2,200	13.5	2 x 90 / 15	20.17.11 D	
1,080	2,450	24	2 x Badu 40 / 32	20.17.12 D	
1,250	2,530	34	2 x 21 - 60 / 45	20.17.13 D	

\* Flow velocity 30 m/h

## Sand loading scheme for upper units

Filter tank	Grain size mm				Carbon N
	3.15-5.6	2.00 – 3.15	1.00 – 2.00	0.4 – 0.8	
	kg	kg	kg	kg	kg
610 DIN	50	50	50	200	72
765 DIN	50	50	50	250	108
1080 DIN	100	100	100	600	180
1250 DIN	150	150	150	850	252

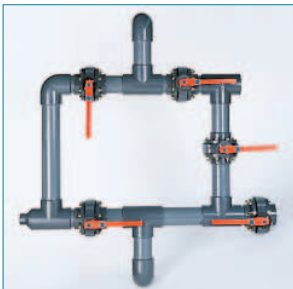

### Front piping (control panel), manual

Not glued, with PVC stop valves, for the following positions:  
filtration, backwashing, clear rinsing, channel, closed.

Tank	Nominal width	Article No.
610 + 765	DN80	20.99.11 D
1080 + 1250	DN125	20.99.12 D



### Differential pressure gauge panel

made of plastic with 2 pressure gauges, 0-3 bar

Article No. 20.99.13 E



### Differential pressure gauge station

made of plastic with 2 pressure gauges  
2 test water sampling taps

Article No. 20.99.14 E



### Automatic ventilation valve

made of plastic, for ventilating the filter during backwashing, R 3/4"

Article No. 20.99.15 E



### Automatic ventilation valve

made of stainless steel for ventilating the filter during backwashing, R 3/4"

Article No. 20.99.16 E

# Sand filters Suprasteel® and 6-way valves

Sand filters Suprasteel®, filter tank made of stainless steel 1.4571	Article No.
<b>Typ 1026-W</b> with KSB pump Filtra 8E	20.12.18 D
<b>Typ 1026-D</b> with KSB pump Filtra 8D for pools up to 50 m <sup>3</sup> , filtration rate: 9-12 m <sup>3</sup> /h, stainless steel filter tank 500 mm ø	20.12.19 D
<b>Typ 1436-D</b> with KSB pump Filtra 18D and 1½" Ventil for pools up to 80 m <sup>3</sup> , filtration rate: 14 m <sup>3</sup> /h, stainless steel filter tank 620 mm ø	20.12.20 D
<b>Typ 1636-D</b> with KSB pump Filtra 18D and 2" Ventil for pools up to 100 m <sup>3</sup> , filtration rate: 16 m <sup>3</sup> /h, stainless steel filter tank 620 mm ø	20.12.21 D
<b>Filter tank stainless steel ø 500 mm</b>	20.91.12 D
<b>Filter tank stainless steel ø 620 mm</b>	20.91.13 D



Type 1026-W/D



Type 1436-D



Type 1636-D



Filter tank ø 500 mm



Filter tank ø 620 mm

Valve	Article No.
<b>6-way plastic valve, Top Mount (Speck)</b>	20.95.10 C
<b>6-way plastic valve, threaded connection R 1½"</b>	20.95.11 C
<b>6-way valve, threaded connection R 2"</b>	20.95.12 C
<b>6-way valve, threaded connection R 3"</b>	20.95.13 C



6-way plastic valve Top Mount



6-way valves

Automatic backwashing for sand filters	Article No.
Fully automatic, time-dependent <b>automatic backwashing</b> Valve type 1½", add surcharge to filter price	20.96.10 D
Fully automatic, time-dependent <b>automatic backwashing</b> Valve type 2", add surcharge to filter price	20.96.11 D
Fully automatic, time-dependent <b>automatic backwashing</b> Valve type 3", add surcharge to filter price	20.96.12 D



Valve type 1½"



Valve type 2"



Valve type 3"

# BESGO automatic backwashing systems – the safe method of backwashing

- Universally connectable
- The connections can be turned through 90°
- Closed in 1 to 2 seconds
- No pressure hammers
- Low pressure losses
- The valve is closed when there is no power supply so that the pool cannot be drained unintentionally

DN 40 and 50 with adhesive nipple (adhered to the outside), DN 65, 80 and 100 with adhesive bushing (adhered to the inside), 1x adhesive nipple. Inside parts made of V4A 1.4571, seal made of ozone-resistant Viton/PTFE.



		Article No.
<b>DN 40 / d50mm</b>	125mm	20.96.13 E
<b>DN 40 / d50mm</b>	130mm	20.96.14 E
<b>DN 40 / d50mm</b>	140mm	20.96.35 E
<b>DN 40 / d50mm</b>	145mm	20.96.15 E
<b>DN 40 / d50mm</b>	190mm	20.96.16 E
<b>DN 40 / d50mm</b>	230mm	20.96.17 E
incl. 3/2 230 V solenoid, mounted, hydraulic: 3 m water column pressure loss at 20 m <sup>3</sup> /h		
<b>DN 50 / d63mm</b>	140mm	20.96.18 E
<b>DN 50 / d63mm</b>	170mm	20.96.19 E
<b>DN 50 / d63mm</b>	190mm	20.96.20 E
<b>DN 50 / d63mm</b>	230mm	20.96.21 E
incl. 3/2 230 V solenoid, mounted, hydraulic: 3 m water column pressure loss at 30 m <sup>3</sup> /h		
<b>DN 65 / d75mm</b>	208mm	20.96.22 E
incl. 3/2 230 V solenoid, mounted, hydraulic: 3 m water column pressure loss at 50 m <sup>3</sup> /h		
<b>DN 80 / d90mm</b>	251mm	20.96.24 E
incl. 3/2 230 V solenoid, mounted, hydraulic: 3 m water column pressure loss at 70 m <sup>3</sup> /h		
<b>DN 100 / d110mm</b>	304mm	20.96.25 E
incl. 3/2 230 V solenoid, mounted, hydraulic: 3 m water column pressure loss at 105 m <sup>3</sup> /h		

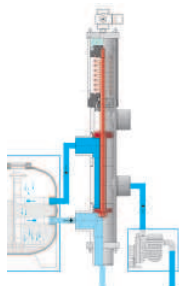

Application: for filtration

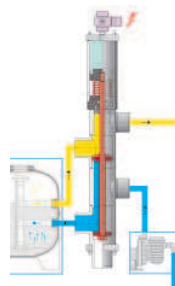

Application: for backwashing

<b>BESGO 3-way valve</b> made of PVC-U for alternative applications and for clear rinsing		Article No.
<b>DN 40 / d50mm</b>	incl. 3/2 230 V solenoid valve	20.96.28 E
<b>DN 50 / d63mm</b>	incl. 3/2 230 V solenoid valve	20.96.29 E
<b>DN 65 / d75mm</b>	incl. 3/2 230 V solenoid valve	20.96.30 E
<b>DN 80 / d90mm</b>	incl. 3/2 230 V solenoid valve	20.96.31 E
<b>DN 100 / d110mm</b>	incl. 4/2 230 V solenoid valve	20.96.32 E

### Air compressor for operating BESGO valves

Einhell compressor Euro 8/24, 230 V/50 Hz, 1.5 kW, tank volume 24 l, operating pressure max. 8 bar, 33 kg

Features: • start unloader, • motor protection, • pressure regulator, intake filter, pressure switch, • 1 pressure gauge for unregulated tank pressure, • 1 pressure gauge for regulated tank pressure

Article No. 20.96.33

### Installation unit

for water control pressure, 3/8" BESGO connections.

Consisting of pressure gauge 0-10 bar

Non-return valve, fine filter, stop valve

Article No. 20.96.27

## Filter controls

### Filter controls

**Functions:**

Control for a single phase 230 V or three phase 400 V filter pump

**Scope of delivery:**

Housing with hinged clear cover, protection IP 65 with analogue time switch without power reserve, multi-switch for the functions "Off", "On" and "Automatic", operating lamp for the filter pump, potential-free output contact, e.g. for dosing system, etc.



	Article No.
<b>Filter control FC 1W</b> for connecting to a 230 V single phase filter pump	20.97.14 D
<b>Filter control FC 1 D</b> for connecting to a 400 V three phase filter pump The control contains the motor protection (up to 8 A rated current)	20.97.15 D

## Controls for swimming pool filters, solar systems and heat exchangers

	Article No.
<b>Swim-tec® Poolcontrol 230</b> with water sensor	20.97.12 D
<b>Swim-tec® Poolcontrol 400</b> with water sensor and motor protection max. 8A Analogue heating filter control with time switch for 230 V and 400 V (motor protection max. 8A). Connection possibility for channel tank control, backwashing control and dosing system. (Protection IP 65). Optional possibility for use of a heat exchanger or solar system with motor valve 24 V or solar pump 230 V. Two potential-free switching contacts are also available for filtering and heating.	20.97.13 D
<b>Swim-tec® Pool Consulting control 230 V</b> , time and temperature control with integrated solar control for connecting to a 230 V three phase filter pump incl. water sensor with fastening clamp. Switching contacts can be programmed for activating BESGO automatic backwashing.	20.97.10 D
<b>Swim-tec® Pool Consulting control 400 V</b> , time and temperature control with integrated solar control for connecting to a 400 V three phase filter pump with up to max. 8.0 A rated current, incl. water sensor with fastening clamp. Switching contacts can be programmed for activating BESGO automatic backwashing.	20.97.11 D
<b>Solar sensor</b> If the solar sensor is added, a motor reversing valve with 24 V AC or a solar pump with 230 V can be connected up in combination with a solar system.	15.40.16 D
<b>Water sensor</b>	15.40.17 D



**Note:**

Not for installation outside, only mount in dry shafts!



# Filter controls

## Controls for swimming pool filters, solar systems and heat exchangers

	Article No.
<b>Swim-tec® Pool Consulting Plus control</b> Digital filter, heating and solar control for filter pumps 230 V and 400 V (motor protection max. 7 A). Also with two potential-free switching contacts: filter/heating. Intuitive user interface with illuminated LC screen. Display of the individual operating statuses. Connection possibility for channel tank control, dosing system and motor valve 230 V for solar absorber respectively separate solar pump. Version in extra large housing. (Protection IP 65).	
<b>Swim-tec® Pool Consulting Plus 230 V with water sensor</b>	20.97.29 D
<b>Swim-tec® Pool Consulting Plus 400 V with water sensor</b>	20.97.30 D

### Extended functions

#### Automatic program for automated backwashing with plunger valve and clear rinsing with 3-way valve

- Maximum operating reliability
- Low pressure losses
- Suitable for all filters
- Sizes DN 40 to DN 125

#### Bus-capable for Aquacontrol Poolvision

- Integrated bus technology for display and maintenance with Aquacontrol Poolvision
- Very simple installation with a bus cable to connect the individual components. The system automatically detects the connected components.

#### Automatic program for swimming pool and whirlpool

- Just one water treatment system for the swimming pool and a whirlpool.
- The whirlpool is brought up to temperature by pressing a button or at a set time.
- This saves costs in terms of procurement and operation.
- Surcharge for whirlpool application

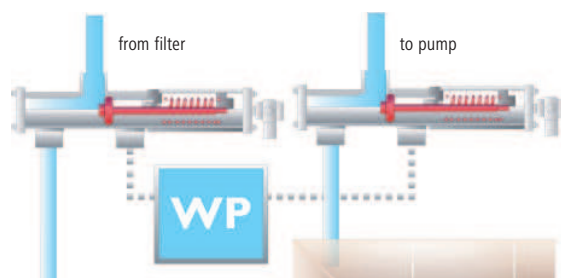
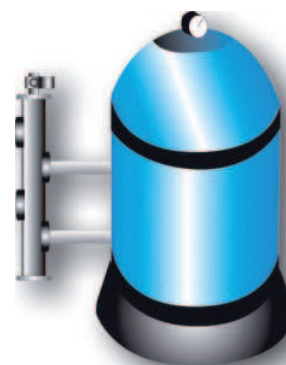

# Filter controls

## Central control unit

	Article No.	
<b>Poolvision</b> User-friendly control terminal with extra large screen (screen diagonal 14.5 cm) for display and alteration of all relevant values together with remote control and maintenance of the connected swimming pool systems.		
	20.97.32 D	

### The large control terminal provides access to the following units:

#### Control for filters, heating and solar system

- Filter system operating hours
- Swimming pool heating
- Solar system
- Automatic backwashing

#### Measuring, control and dosing system

- Display of the hygiene auxiliary parameters, e.g. pH value and chlorine level
- Adjustment of the required nominal values and control parameters

#### Extension boxes (at a surcharge)

- Underwater spotlights
- Garden irrigation/lighting
- Water features

#### Components

The system is very flexible and can be extended at any time. To keep pace with technical progress, a new software version is simply installed.

#### Diagram with overflow channel



#### Diagram with skimmer

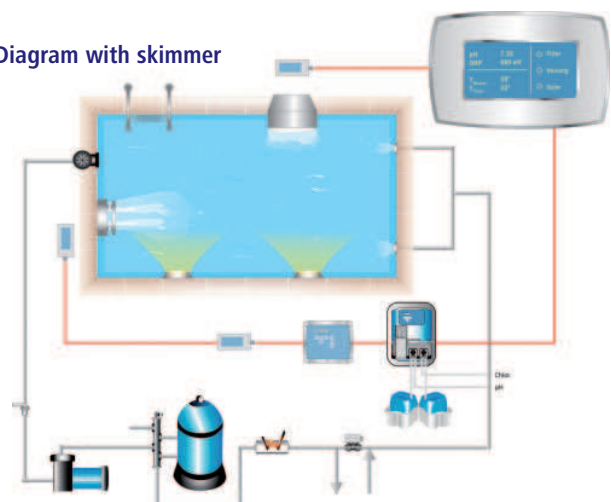

#### Installation

Very simple installation with a bus cable to connect the individual components. The system automatically detects the connected components.



## Swimming pool pumps



**KSB swimming pool pumps, pump housing made of temperature-resistant polypropylene**

The stated output is the power output P2.

		Voltage	P2	Article No.
Filtra	6 E	230 V	0.30 kW	20.22.10 C
Filtra	6 D	400 V	0.30 kW	20.22.11 C
Filtra	8 E	230 V	0.40 kW	20.22.12 C
Filtra	8 D	400 V	0.40 kW	20.22.13 C
Filtra	12 E	230 V	0.50 kW	20.22.14 C
Filtra	12 D	400 V	0.50 kW	20.22.15 C
Filtra	14 E	230 V	0.63 kW	20.22.16 C
Filter	14 D	400 V	0.63 kW	20.22.17 C
Filtra	18 E	230 V	0.80 kW	20.22.18 C
Filtra	18 D	400 V	0.80 kW	20.22.19 C
Filtra	22 E	230 V	1.00 kW	20.22.20 C
Filtra	22 D	400 V	1.00 kW	20.22.21 C
Filtra	24 E	230 V	1.20 kW	20.22.22 C
Filtra	24 D	400 V	1.20 kW	20.22.23 C
Filtra	30D	400 V	1.20 kW	20.22.24 C

** New quiet version!**

**Speck swimming pool pumps, Badu 90, pump housing made of glass-fibre reinforced PP**

The stated output is the power output P2



			Voltage	P2	Article No.
Badu	90/7 W	NEW	230 V	0.25 kW	20.21.10 C
Badu	90/7 D	NEW	400 V	0.25 kW	20.21.11 C
Badu	90/11 W	NEW	230 V	0.45 kW	20.21.12 C
Badu	90/11 D	NEW	400 V	0.45 kW	20.21.13 C
Badu	90/13 W	NEW	230 V	0.55 kW	20.21.14 C
Badu	90/13 D	NEW	400 V	0.55 kW	20.21.15 C
Badu	90/15 W	NEW	230 V	0.75 kW	20.21.16 C
Badu	90/15 D	NEW	400 V	0.75 kW	20.21.17 C
Badu	90/20 W	NEW	230 V	1.00 kW	20.21.18 C
Badu	90/20 D	NEW	400 V	1.00 kW	20.21.19 C

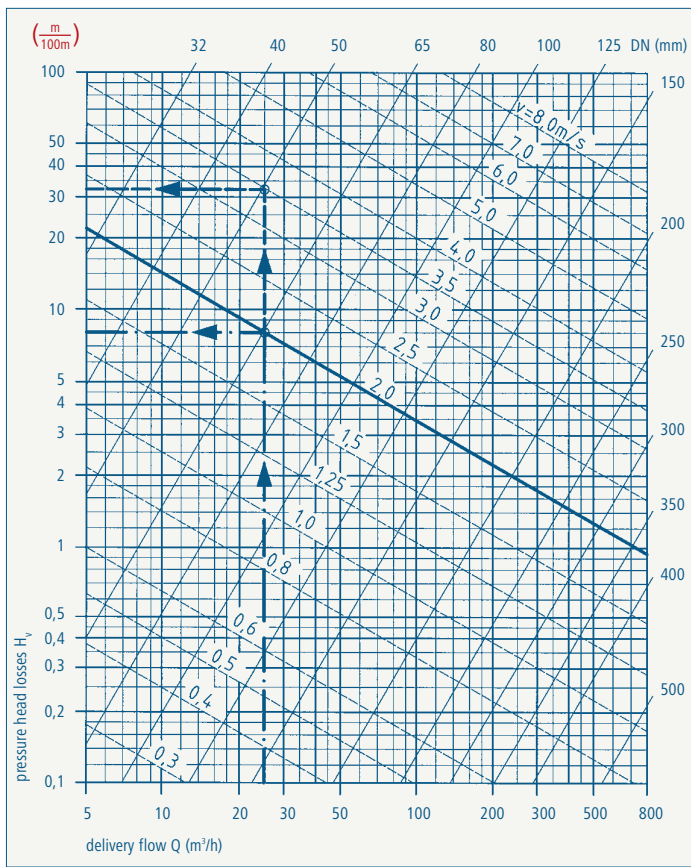

The pressure head losses apply to pure water at 20°C and liquids of the same kinematic viscosity with new steel pipes. The values should be multiplied by  $\approx 0.8$  for plastic pipes.

**Example:**

Q = 25 m<sup>3</sup>/h, 20 m plastic pipe  
 DN 50 = Δ d 63      DN 65 = Δ d 75  
 with pressure head loss reading  
 $H_v = 33$  m per 100 m      8.00 m per 100 m  
 Correction factor 0.80 for plastics pipes  
 26.40 m per 100 m      6.40 m per 100 m

**Pressure head loss:**

for 20 m pipe ( $\times \frac{20}{100}$ )  
 $H_v = 5.28$  m      1.28 m  
 Flow velocity control  
 $v = 3.50$  m/s (too high)      2.00 m/s (OK)

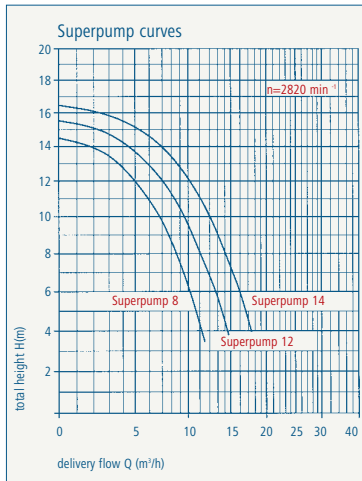

**Swim-tec® Superpump by Speck**  
 Pump housing made of PP

The stated output is the power output P2

	P2		Article No.
Superpump 8	230 V	0.30 kW	20.21.20 D
Superpump 12	230 V	0.45 kW	20.21.21 D
Superpump 14	230 V	0.65 kW	20.21.22 D

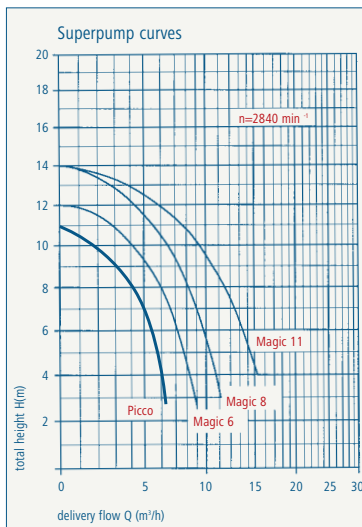

**Speck circulation pumps, Badu Magic and Picco**  
 Pump housing made of PP

The stated output is the power output P2

	P2		Article No.
Picco 5	230 V	0.20 kW	20.21.23 E
Magic 6	230 V	0.25 kW	20.21.24 E
Magic 8	230 V	0.40 kW	20.21.25 E
Magic 11	230 V	0.45 kW	20.21.26 E



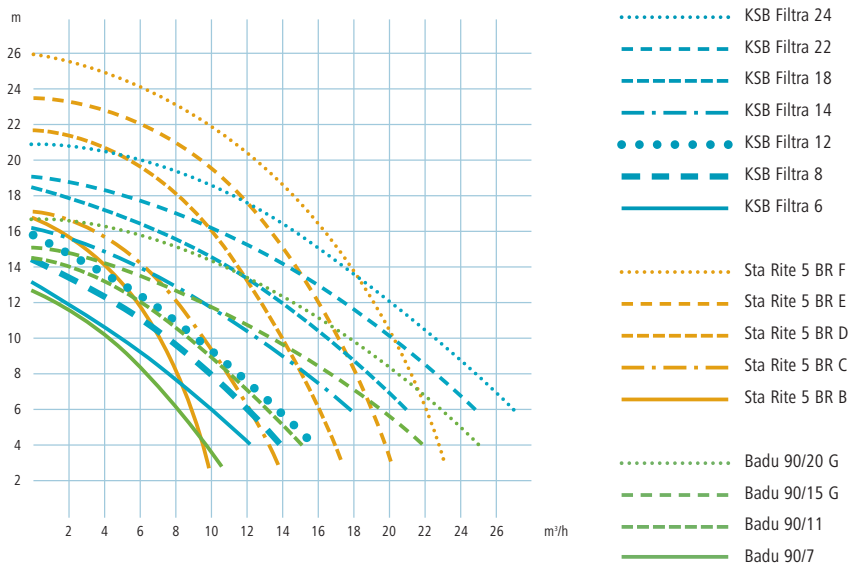

## STA-RITE Swimming pool pumps

### 5BR made of bronze, particularly quiet

	Voltage	Output in m³/h at 8 m water column	Power output in P2	Article No.
5BRB-1	220 - 240 V	8	0,25kW	20.23.10 D
5BRB-3	380 - 420 V	8	0,25kW	20.23.11 D
5BRC-1	220 - 240 V	11	0,37kW	20.23.12 D
5BRC-3	380 - 420 V	11	0,37kW	20.23.13 D
5BRD-1	220 - 240 V	15	0,55kW	20.23.14 D
5BRD-3	380 - 420 V	15	0,55kW	20.23.15 D
5BRE-1	220 - 240 V	18	0,75kW	20.23.16 D
5BRE-3	380 - 420 V	18	0,75kW	20.23.17 D
5BRF-1	220 - 240 V	21	1,10kW	20.23.18 D
5BRF-3	380 - 420 V	21	1,10kW	20.23.19 D

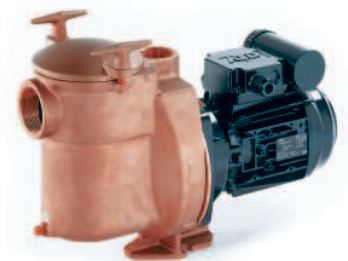

### 5MPRC Dyna-Glas

	Voltage	Output in m³/h at 8 m water column	Power output in P2	Article No.
5MPRC-1	220 - 240 V	12	0.37kW	20.23.20 D
5MPRC-3	380 - 420 V	12	0.37kW	20.23.21 D
5MPRD-1	220 - 240 V	16	0.55kW	20.23.22 D
5MPRD-3	380 - 420 V	16	0.55kW	20.23.23 D
5MPRE-1	220 - 240 V	21	0.75kW	20.23.24 D
5MPRE-3	380 - 420 V	21	0.75kW	20.23.25 D
5MPRF-1	220 - 240 V	27	1.10kW	20.23.26 D
5MPRF-3	380 - 420 V	27	1.10kW	20.23.27 D



### SW5P6R special pumps for seawater (salt level max. 4.0%)

	Voltage	Output in m³/h at 8 m water column	Power output in P2	Article No.
SW5P6RD-1	220 - 240 V	16.5	0.55kW	20.23.28 D
SW5P6RD-3	380 - 420 V	16.5	0.55kW	20.23.29 D
SW5P6RE-1	220 - 240 V	20.0	0.75kW	20.23.30 D
SW5P6RE-3	380 - 420 V	20.0	0.75kW	20.23.31 D
SW5P6RF-1	220 - 240 V	24.5	1.10kW	20.23.32 D
SW5P6RF-3	380 - 420 V	24.5	1.10kW	20.23.33 D
SW5P6RG-1	220 - 240 V	29.0	1.50kW	20.23.34 D
SW5P6RG-3	380 - 420 V	29.0	1.50kW	20.23.35 D
SW5P6RH-1	220 - 240 V	34.0	2.20kW	20.23.36 D
SW5P6RH-3	380 - 420 V	34.0	2.20kW	20.23.37 D



# Suspension filter technology IS - series

Our success story: the suspension filter range by MTH!

Optimum technology, maximum stability, minimum space requirements, strong design

**Special swimming pool filters for above ground pools up to 30 m<sup>3</sup> with in-built circulation pump**

	Article No.
Special filter type IS 6	20.31.13 D
Special filter type IS 6 - unglued	20.31.14 D

**Special swimming pool filters for above ground pools up to 60 m<sup>3</sup> with in-built circulation pump**

	Article No.
Special filter type IS 12	20.31.15 D
Special filter type IS 12 - unglued	20.31.16 D

**Special filters for children's paddling pools**

	Article No.
Paddling pool filter type IS 2	20.31.10 E
Paddling pool filter type IS 2 - unglued	20.31.11 E



Type IS 6

	Filtration rate:	Power consumption:	Electrical connection:	Dimensions L x W x H	Weight: 1 box
	m <sup>3</sup> /h*	Watt	Voltage	mm	kg gross
Type IS 6	5	140	230 V, 50 Hz	460 x 360 x 420	10
Type IS 12	8 - 10	220	230 V, 50 Hz,	500 x 400 x 440	13
Type IS 2	2	100	230 V, 50 Hz,	380 x 300 x 370	6

\* Filtration rate for clean cartridge



Type IS 12



Type IS 2



# Suspension filter technology SK-series



## The compact floating skimmer set SK 2

	Article No.	
<b>Floating skimmer set</b> complete assembled	20.32.10 D	
<b>Floating skimmer set</b> not glued Pipes <b>not glued</b> , use in concrete pool	20.32.11 D	
<b>Floating skimmer set with filter cartridge</b> Constitutes a complete filter in combination with a swimming pool pump	20.32.12 D	
<b>Floating skimmer set with filter cartridge</b> Use in concrete pool, pipes <b>not glued</b> Constitutes a complete filter in combination with a swimming pool pump.	20.32.13 D	
Dimensions and weight: 1 box L: 380 mm x W: 660 mm, 6.5 kg		



## All-Rounder Kit: the skimmer/filter and pump complete set

	Article No.	
<b>Floating skimmer set</b> <b>SK 2</b> with filter cartridge and self-priming Speck pump with pre-filter <b>Magic 6</b>	20.32.14 D	
<b>Floating skimmer set</b> <b>SK 2 - unglued</b> , for concrete pool, with filter cartridge and self-priming Speck pump with pre-filter <b>Magic 6</b>	20.32.15 D	

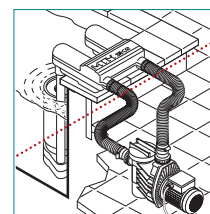
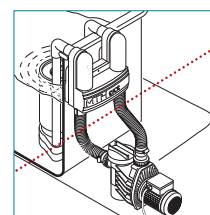

Filtration rate:	Filter surface:	Power consumption:	Electrical connection:	Connection lead length:
m <sup>3</sup> /h*	m <sup>2</sup>	Watt	Voltage	meter
7.0	1.5	450	230 V, 50 Hz	3

\* Filtration rate for clean cartridge

	Article No.	
<b>Multimat "S"</b> Splashproof socket timer switch with "Manual" and "Automatic" switch. For all plug-in filter systems (230 V)	20.99.10 E	
<b>Set of spare filters (2 filters in 1 pack)</b>		
Top quality textile cartridges, filter type IS 2 and S 2	20.94.10 E	
Top quality textile cartridges, filter type IS 5, IS 6 and IS 12	20.94.11 E	







# **solar systems**

# Solar systems

Longer bathing season with a constant pool temperature – **without any energy costs!**

**You reckon that's not possible? Let us show you how!**

General leisure behaviour is changing, with more individual plans and greater priority for the home and garden.

Notwithstanding the effects of mass motorization, the summer is always best in or at your own pool – if it weren't for Central European weather.

A solar system can make you independent of the weather and keep the pool water at a constant, pleasant 24 – 29°C, even when the sky is cloudy.



An MTH solar system works simply and effectively: **an uncovered swimming pool containing 40 m<sup>3</sup> water consumes approx. 1,000 l heating oil from May to October to keep the temperature at only 22°C.** Given today's oil prices, this results in considerable costs.

### **☑ Your solar system – your profit:**

1. The MTH solar system generates absolutely no energy costs in producing the same water temperature, because the water is heated by solar energy.
2. The solar system can usually be operated with the already existing filter pump.
3. **The costs can be recouped already after one to two years!**
4. The constant water temperature gives you a longer summer season.
5. Solar systems by MTH are environment-friendly

## Example: water temperatures in a sample swimming pool in summer 2002

### Basic data:

- bathing season from 28.4.2002 to 7.10.2002
- location: greater Munich area
- swimming pool foil 1.5 mm
- 60 m<sup>3</sup> water content
- roller shutter cover over the pool
- 100% solar system SUNNY FLEX® S

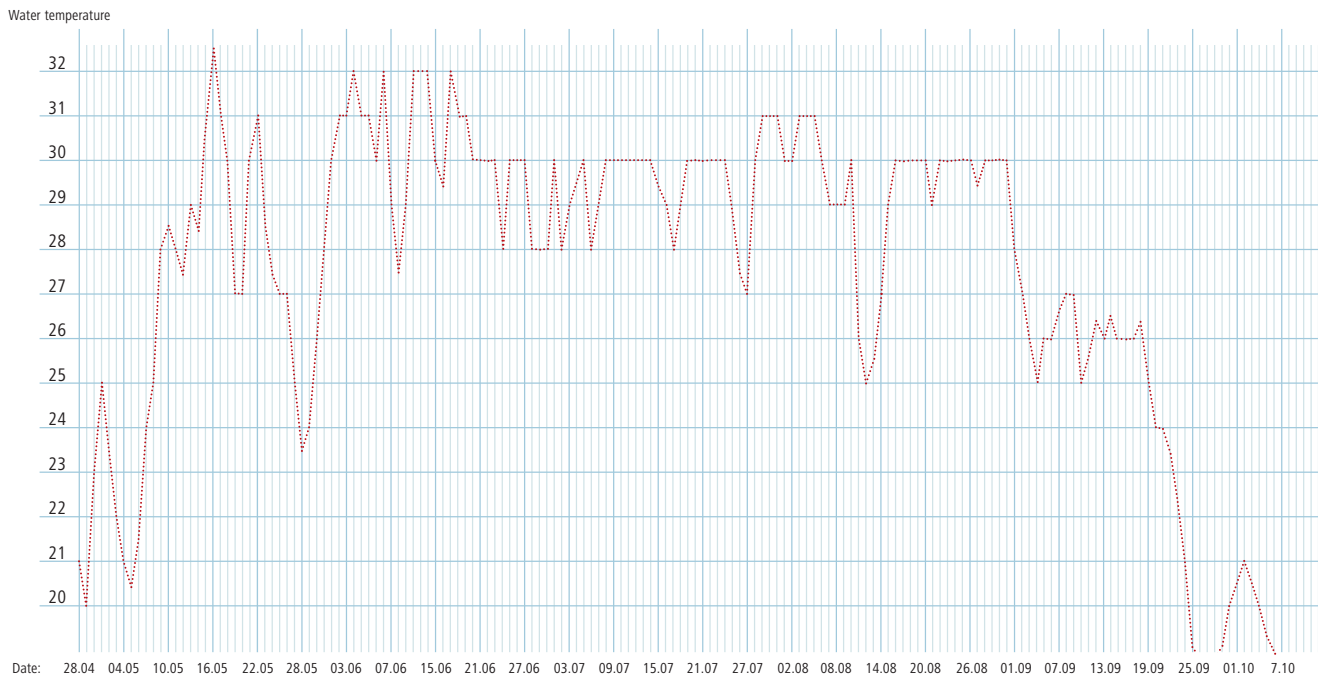



# Solar systems

## Introducing a successful family:

We have been developing and producing solar heating systems for swimming pools since 1979.

A solar system makes you independent of the weather and keeps the pool water at a constant pleasant 24 to 29°C, even when the sky is cloudy. We have been developing and producing solar heating systems for swimming pools since 1979.

From the simple **SUNNY MAX** and the proven **SUNNY PLATE** solar system to the extremely successful **SUNNY FLEX®** solar system, meanwhile many of these systems are operating on thousands of German and European roofs on private and public buildings.

They have now been joined by the **SUNNY FLEX® S**, which sets new standards thanks to a new installation system, chemically even more resistant material and a highly aesthetic appearance.

All products share the same superior profile.



The profile of the **SUNNY FLEX®** collectors consists of individual tubes which are permanently connected together.

The outstanding properties of our solar profile have been confirmed in neutral tests by the CEC (Commission of European Communities Joint Research Centre), FSEC (Florida Solar Energy Center), EIR (Eidgenössisches Institut für Reaktorforschung) and the Central Swiss Technical Institute in Lucerne.

### **SUNNY FLEX® S** - Premium class The trend-setting solar system, latest technology



### **SUNNY FLEX®** The extremely flexible, aesthetic version



### **SUNNY PLATE** The world's top-selling product



### **SUNNY MAX** The simple, low-cost solution



# Solar systems

## Collector surface

In Central Europe, the collector surface should correspond approximately to the water surface of the pool.  
 The required collector surface can be reduced to 60% of the water surface by using a cover over the pool to prevent heat loss.

---

This diagram shows that the MTH collectors are superior to far more expensive glazed collectors when it comes to heating swimming pool water (working range).

---

The system is approx. 10% more efficient.  
 This comes from the reflection losses caused by the glass surface.  
 The complicated structure of the insulated, glazed collectors brings no advantages when used for heating swimming pools (small temperature difference  $T_f - T_L$ ).

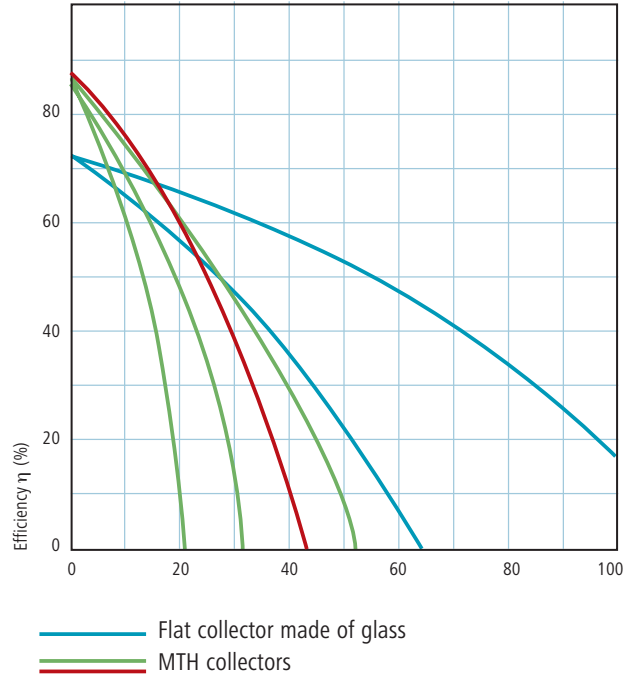

### Example for the MTH collector system:

$\Delta T$  = temperature difference  $T_f - T_L$  (K) of the MTH systems.

Solarization =  $800 \text{ W/m}^2$   
 Ambient air temperature:  $T_i = 20^\circ \text{ C}$   
 Temperature at the collector inlet  
 (pool water temperature):  $T_i = 22^\circ \text{ C}$

Temperature at the collector outlet:  $T_s = 26^\circ \text{ C}$   
 Mean collector temperature:  $T_i = \frac{1}{2} (T_s + T_i) = 24^\circ \text{ C}$   
 Temperature difference:  $\Delta T = T_s - T_i = 4 \text{ K}$

The MTH solar collector results in a particularly low mean collector temperature  $T_f$ , because the complete flow rate of the filter is pumped through the collector system.

This makes the system highly efficient. The efficiency diagram shows a  $\eta$  of approx. 82%.

**This results in a thermal gain.**  
 $Q = 800 \text{ W/m}^2 \times h = 656 \text{ W/m}^2$   
**20 m<sup>2</sup> solar surface are available.**  
 $Q = 656 \text{ W} \times 20 = 13120 \text{ W}$ .

Approx. 13 kW are available to produce an increase in temperature.

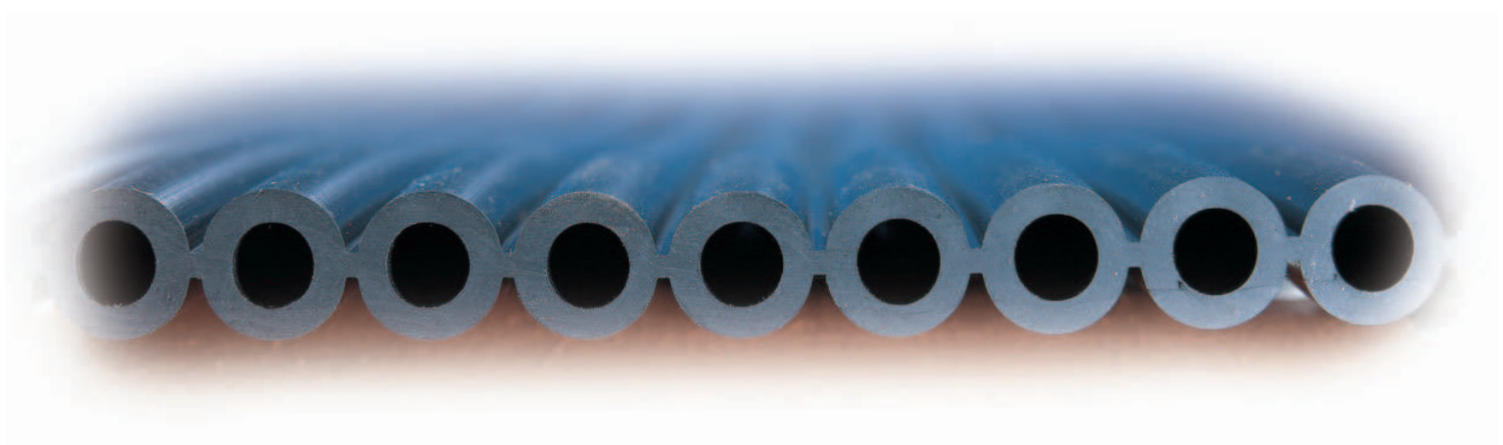

**Diffuse radiation**

is no hindrance to maximum energy absorption, because the surface of the SUNNY FLEX® collector is far larger than that of a smooth surfaced collector with the same dimensions.

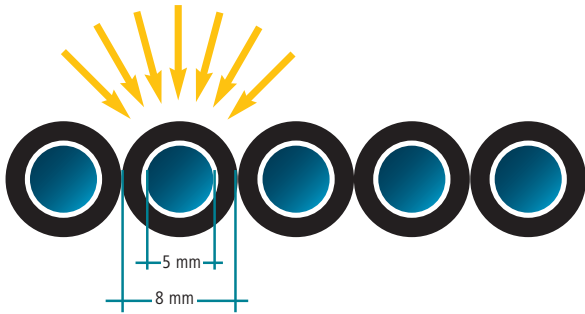

**Direct solar radiation**

can be absorbed unhindered and directly by the collector tubes in relative independence of the corresponding incidence angle, and transferred to the pool water flowing through the tubes.

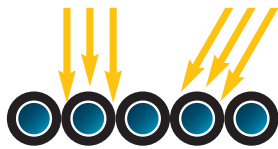

**Reflected solar energy**

usually hits either one or other neighbouring collector tube so that this energy is also used.



**i** The market also offers collectors with a space between the individual tubes; it is quite logical that this is a waste of space, because the gaps cannot be used to heat the pool water.

**i** Installing the SUNNY FLEX® solar system for the open air swimming pool belonging to the local authority of Großräschen on the edge of the Spreewald (forest around the River Spree) near Berlin.



**i** SUNNY FLEX® solar system being installed for the open air swimming pool set in the woods of Cunnersdorf Spa in the Elbsandsteingebirge (Elbe Sandstone Mountains) near Dresden.



# Solar systems

## SUNNY FLEX® S - latest MTH technology for heavenly water temperatures

### The TPE collector material

Ultra-modern TPE (thermoplastic elastomer) is as elastic as EPDM (ethylene propylene diene monomer), but far more resistant to chemical influences.

### The TPE collector manifolds

are not made of ABS (acrylonitrile butadiene styrene) but of harder TPE than the collector foils. This makes the manifolds practically indestructible, robust and insensitive to frost, even for solar systems installed on flat roofs.

### The installation system

The individual collector manifolds are connected together with bushings and nipples and secured with a black stainless steel clip. The advantage compared to an adhered bond is quite obvious: easily detached again, but still very secure.

The solar foils are not adhered directly to the roof, but held securely by a two-part installation rail so that they can be removed again. The lower part of the rail is usually adhered to the roof, but it can also be screwed on.

This makes it simply child's play to replace a solar foil or a single collector manifold at a later point in time.

Utility models and patents ensure that these advantages are protected in key European countries.

SUNNY FLEX® S is a registered trademark of MTH AG

#### SUNNY FLEX® S solar system

Customized production: : **length or width or length and width**  
no straight meters L = required length, B = number of foils

Article No. 15.11.98 D

#### SUNNY FLEX® S South solar system

Article No. 15.11.99 D

SUNNY FLEX® S in standard lengths, solar width = 3 foils = 1.02 m installation width = basis for calculation



When placing your orders, please use the order drawing for SUNNY FLEX® S 53

Also available as download under: [www.mth-sunnypool.com](http://www.mth-sunnypool.com)

Our film about SUNNY FLEX® S is available under [www.mth-sunnypool.com/downloads](http://www.mth-sunnypool.com/downloads).



**The m<sup>2</sup> price includes 2 solar clips per foil!**



## Functional diagram

1. The filter keeps the pool water clean.
2. The circulation pump sucks in the water from the pool and pumps it through the filter, through the solar system from A to B and then back into the pool.
3. The automatic solar control controls the solar system.
4. The solar sensor (sun sensor) tells the solar control whether enough solar energy is available to increase the temperature of the water in the pool.
5. The water sensor tells the solar control whether the pool water needs to be heated.
6. The motor reversing valve is switched by the solar control. When the solar system is operating, it blocks the direct water path to the pool.
7. Manual stop valve blocks off the solar feed pipe from the filter circuit.
8. Manual stop valve blocks off the solar return pipe from the filter circuit.

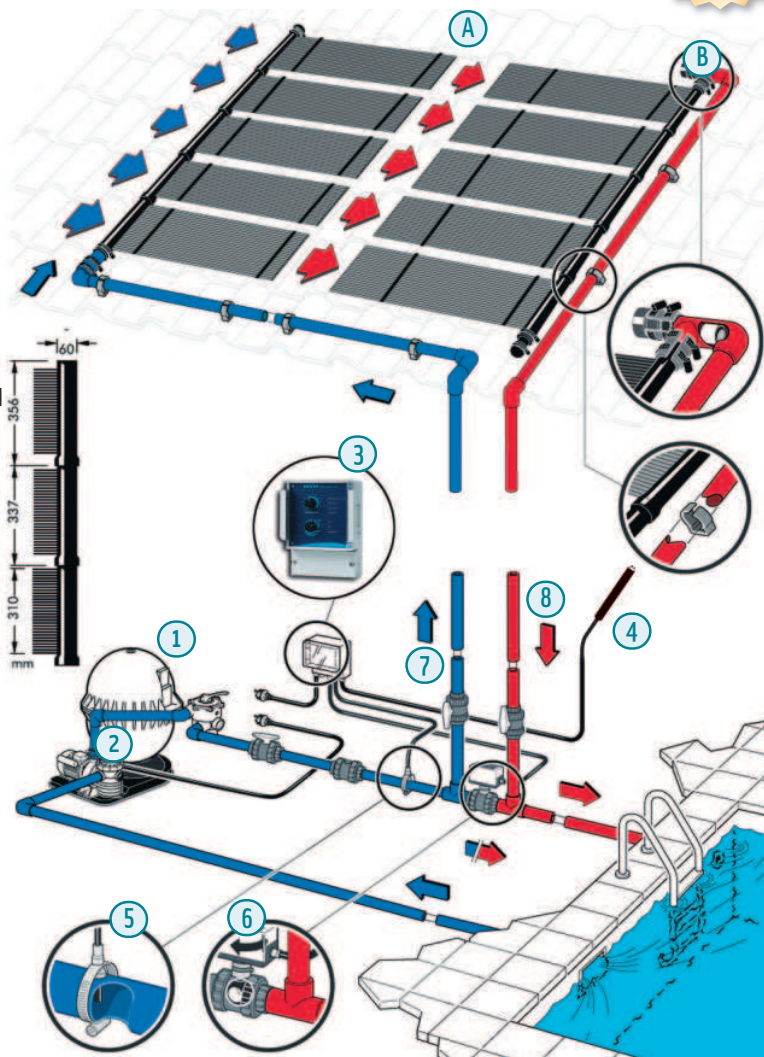

Technical data			
Empty weight:	approx. 4 kg/m <sup>2</sup>		
Collector weight when filled with water:	approx. 7 kg/m <sup>2</sup>		
Inner diameter of the solar tubes:	approx. 5 mm		
Outer diameter of the solar tubes:	approx. 8 mm		
Flow rate			
Mean flow rate per m <sup>2</sup>	0.25 m <sup>3</sup> /h		
Maximum flow rate per m <sup>2</sup>	0.50 m <sup>3</sup> /h		
Pressure losses at 0.25 m <sup>3</sup> /h flow rate and 5 m solar length (increases with length)	1000 mm water column		
Operating pressure	2.0 bar		
Maximum output	850 W/m <sup>2</sup>		
Collector temperature = ambient temperature:	(Solarization 1 kW>/m <sup>2</sup> )		
Material data			
Test criteria	Test specification	Unit of measurement	
Hardness	DIN 53505	Shore A	75.00
Density	DIN 53479	g/cm <sup>3</sup>	1.13
Tensile strength at break	DIN 53504	N/mm <sup>2</sup>	5.50
Elongation at break	DIN 53504	%	450.00
Stress value at 100%	DIN 53504	N/mm <sup>2</sup>	3.40
Stress value at 200%	DIN 53504	N/mm <sup>2</sup>	3.90
Stress value at 300%	DIN 53504	N/mm <sup>2</sup>	4.40
Resistance to tear propagation	DIN 53515	N/mm <sup>2</sup>	24.00

## Solar systems

### SUNNY FLEX® S/Standard set of foils

black color	Article No.
Standard size 3 m x 1.02 m (3 foils)	15.21.10 D
Standard size 4 m x 1.02 m (3 foils)	15.21.12 D
Standard size 5 m x 1.02 m (3 foils)	15.21.14 D
Standard size 6 m x 1.02 m (3 foils)	15.21.16 D
Standard size 7 m x 1.02 m (3 foils)	15.21.18 D
Standard size 8 m x 1.02 m (3 foils)	15.21.20 D
Standard size 10 m x 1.02 m (3 foils)	15.21.22 D

### The S-class in a complete set with accessories:

	black color	SOUTH red color
	Article No.	Article No.
<b>SUNNY FLEX® S SET 1</b> (3 m x 5 m = 15 m <sup>2</sup> ) SUNNY FLEX® S solar system for pools up to max. 25 m <sup>2</sup> water surface (covered). <b>Complete scope of supply:</b> 3 m wide (9 foils) and 5 m long <b>Accessories:</b> 90 installation rails, 1 ventilation valve, 2 end caps, 2 special nipples (4.1 and 4.2), 2 rubber bushings, 26 stainless steel clips, black, 10 cartridges SUNNY FLEX MASTIC	15.21.70 D	15.21.71 D
<b>SUNNY FLEX® S SET 2</b> (2 m x 6 m = 12 m <sup>2</sup> ) SUNNY FLEX® S solar system for pools up to max. 20 m <sup>2</sup> water surface (covered). <b>Complete scope of supply:</b> 2 m wide (6 foils) and 6 m long <b>Accessories:</b> 72 installation rails, 1 ventilation valve, 2 end caps, 2 special nipples (4.1 and 4.2), 2 rubber bushings, 20 stainless steel clips, black, 8 cartridges SUNNY FLEX MASTIC	15.21.72 D	15.21.73 D
<b>SUNNY FLEX® S SET 3</b> (3 m x 8 m = 24 m <sup>2</sup> ) SUNNY FLEX® S solar system for pools up to max. 40 m <sup>2</sup> water surface (covered). <b>Complete scope of supply:</b> 3 m wide (9 foils) and 8 m long <b>Accessories:</b> 144 installation rails, 1 ventilation valve, 2 end caps, 2 special nipples (4.1 and 4.2), 2 rubber bushings, 26 stainless steel clips, black, 16 cartridges SUNNY FLEX MASTIC	15.21.74 D	15.21.75 D





# Solar systems

## SUNNY FLEX® SOUTH – the solar system with Provençal flair in best MTH quality

SUNNY FLEX® S with red solar foils and red collector manifolds blends in perfectly with Mediterranean architecture. In South Europe, the 25% reduced output compared to the black SUNNY FLEX® S system is scarcely significant.

The quality, material and installation system correspond to SUNNY FLEX® S.



SOUTH red color	Article No.	
Standard size 3 m x 1.02 m (3 foils)	15.21.11 D	
Standard size 4 m x 1.02 m (3 foils)	15.21.13 D	
Standard size 5 m x 1.02 m (3 foils)	15.21.15 D	
Standard size 6 m x 1.02 m (3 foils)	15.21.17 D	
Standard size 7 m x 1.02 m (3 foils)	15.21.19 D	
Standard size 8 m x 1.02 m (3 foils)	15.21.21 D	
Standard size 10 m x 1.02 m (3 foils)	15.21.23 D	



**Note:**  
The customer is responsible for adapting the colour of the connection pipes and fittings. Rubber bushings and clips are black.

# Solar systems



## Solar accessories for SUNNY FLEX® S

	Article No.
<b>Installation set</b> SUNNY FLEX® S consisting of: 1 ventilation valve (15.92.14), 2 end caps (15.92.15), 1 special nipple (15.31.11), 1 special nipple (15.31.12), 2 short rubber bushings (15.92.16) with 6 stainless steel clips (48.12.18)	15.31.13 D
Original SUNNY FLEX® mastic adhesive (310 ml)	15.92.10 D
Original SUNNY FLEX® mastic adhesive (600 ml)	15.92.11 D
<b>Hand gun</b> for mastic adhesive 600 ml	15.92.12 D
<b>Universal installation system - Recommended</b>	
<b>Installation rail</b> (1.02 m long for 3 foils) made of glass-fibre reinforced polyester with black stainless steel screws. The bottom part of the top rail is suspended from the roof tile and also adhered to the contact points with mastic adhesive. The following rails are clipped into the previous rail with a very secure connection and also adhered to the contact points. This system is vital when the spacing between tiles is too small, but can also be used on every other roof as well (tile spacing < 340 mm).	black 15.31.16 D red 15.31.17 D
<b>Tile spacing installation system</b>	
Polyamide <b>installation rail</b> with 2 black stainless steel screws (for one foil). The lower part is usually adhered to the roof.	15.31.10 D
<b>Installation aid for very steep roofs</b>	
Special installation rails with screwed-on metal sections for bending round and fastening to a roof batten in the preceding row of tiles, see drawing	15.92.13 D
<b>Special PVC nipple</b> with stainless steel reinforcement on one side. The reinforced side is pushed into the bushing of the collector manifold and held with the stainless steel clip. The other side is glued to the manifolds.	15.31.11 D
<b>Special nipple</b> (stainless steel pipe) as adapter from solar system to end cap	15.31.12 D
<b>Installation aid for tile when tile spacing is too large</b> If the individual collector manifolds are too short (tile spacing > 340 mm), one or several collector manifold adapters (TPE) can be used to compensate, see drawing.	15.31.14 D



SUNNY FLEX® mastic adhesive

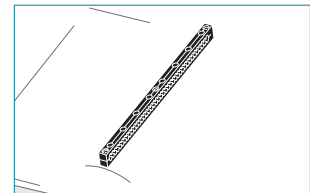

Installation rail

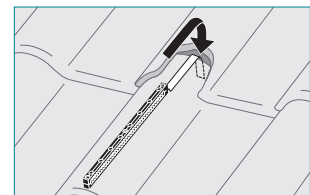

Installation aid for very steep roofs

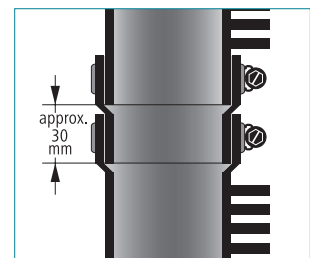

Installation aid for tiles when tile spacing is too large

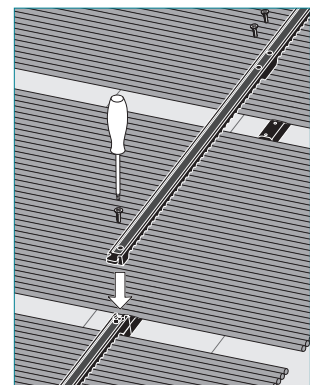
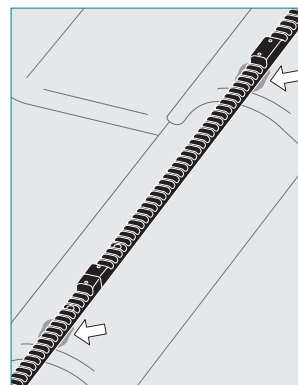
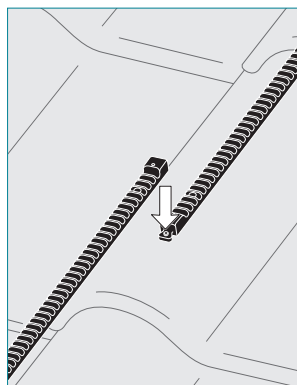

Installation rail for 3 foils



# Solar systems

## SUNNY FLEX®

SUNNY FLEX® solar system  
 Customized production: **length or width or length and width**  
 no straight meters L = required length, B = number of foils

Article No. 15.12.99 D

SUNNY FLEX® is a registered trademark of MTH AG.



Not suitable for chlorine electrolysis units.



When placing your orders, please use the order drawing for SUNNY FLEX® 66

Also available as download under: [www.mth-sunnypool.com](http://www.mth-sunnypool.com)

Our film about SUNNY FLEX® is available under [www.mth-sunnypool.com/downloads](http://www.mth-sunnypool.com/downloads).

	Article No.	
Standard size 3 m x 1.02 m (3 foils)	15.22.10 D	
Standard size 4 m x 1.02 m (3 foils)	15.22.11 D	
Standard size 5 m x 1.02 m (3 foils)	15.22.12 D	
Standard size 6 m x 1.02 m (3 foils)	15.22.13 D	
Standard size 7 m x 1.02 m (3 foils)	15.22.14 D	
Standard size 8 m x 1.02 m (3 foils)	15.22.15 D	
Standard size 10 m x 1.02 m (3 foils)	15.22.16 D	



### Note

The SUNNY FLEX® solar systems consist of highly resistant EPDM (ethylene propylene diene monomer).

SUNNY FLEX® in standard lengths, solar width = 3 foils = 1.02 m installation width = basis for calculation

### Caution

Salt electrolysis units damage EPDM! No guarantee when using such units!

# Solar systems

## Solar accessories for SUNNY FLEX®

	Article No.
<b>Installation set SUNNY FLEX®</b> consisting of: 1 ventilation valve (15.92.14), 2 end caps (15.92.15), 2 special nipples (15.32.10), 3 short rubber bushings (15.92.16) and 8 black stainless steel clips (48.12.18)	15.32.14 D
Original SUNNY FLEX® <b>mastic adhesive</b> (310 ml)	15.92.10 D
Original SUNNY FLEX® <b>mastic adhesive</b> (600 ml)	15.92.11 D
<b>Hand gun</b> for mastic adhesive 600 ml	15.92.12 D
<b>Special nipple</b> (adapter from solar system to pipes), the nipple is glued to the collector manifold of the solar system	15.32.10 D
<b>Installation aid for tile when tile spacing is too large</b> If the individual collector manifolds are too short (tile spacing > 340 mm), one or several collector manifold adapters (ABS) can be used to compensate, see drawing.	15.32.11 D
<b>Installation aid for very steep roofs</b> Self-adhesive spacers, 100 each	15.32.12 D
Special installation rails with screwed-on metal sections for bending round and fastening to a roof batten in the preceding row of tiles, see drawing	15.92.13 D



SUNNY FLEX® mastic adhesive

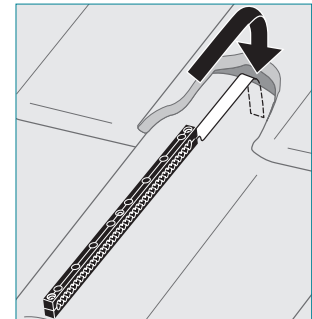

Installation aid for very steep roofs

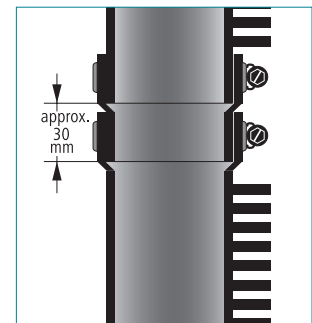

Installation aid for tiles when tile spacing is too large

## Keep it easy and use our sets:

	Article No.
<b>SUNNY FLEX® SET 1</b> (3 m x 5 m = 15 m <sup>2</sup> ) SUNNY FLEX® solar system for pools up to max. 25 m <sup>2</sup> water surface (covered). <b>Complete scope of supply:</b> 3 m wide (9 foils) and 5 m long <b>Accessories:</b> 1 ventilation valve, 2 end caps, 2 special nipples, 3 rubber bushings, 8 stainless steel clips, black, 12 cartridges SUNNY FLEX MASTIC	15.22.70 D
<b>SUNNY FLEX® SET 2</b> (2 m x 6 m = 12 m <sup>2</sup> ) SUNNY FLEX® solar system for pools up to max. 20 m <sup>2</sup> water surface (covered). <b>Complete scope of supply:</b> 2 m wide (6 foils) and 6 m long <b>Accessories:</b> 1 ventilation valve, 2 end caps, 2 special nipples, 3 rubber bushings, 8 stainless steel clips, black, 10 cartridges SUNNY FLEX MASTIC	15.22.71 D
<b>SUNNY FLEX® SET 3</b> (3 m x 8 m = 24 m <sup>2</sup> ) SUNNY FLEX® solar system for pools up to max. 40 m <sup>2</sup> water surface (covered). <b>Complete scope of supply:</b> 3 m wide (9 foils) and 8 m long <b>Accessories:</b> 1 ventilation valve, 2 end caps, 2 special nipples, 3 rubber bushings, 8 stainless steel clips, black, 20 cartridges SUNNY FLEX MASTIC	15.22.72 D

# Solar systems

## Order drawing SUNNY FLEX®

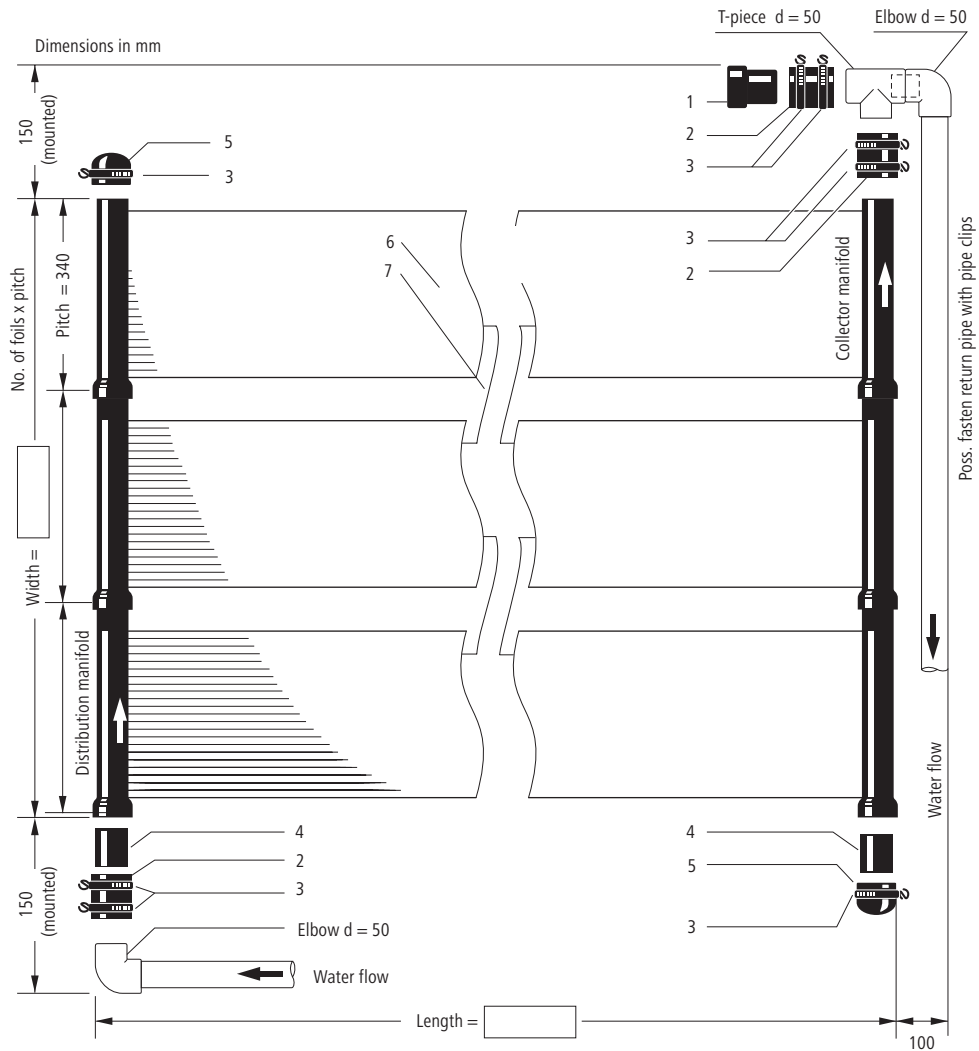

### Scope of supply

Installation set  
Article No. 15.32.14

No.	Quantity	Article No.	Article
6		15.12.99	SUNNY FLEX® S collector foil / 0.3 m wide (length incl. collector and distribution manifold)
7			Visible strips
1	1	15.92.14	Ventilation valve
5	2	15.92.15	End cap
4	2	15.32.10	Special nipple
2	3	15.92.16	Rubber bushing, short
3	8	48.12.18	Stainless steel clip
		15.92.10	Special mastic adhesive, 1 cartridge 0.31 l per 1.25 m <sup>2</sup> solar surface (SUNNY FLEX® is adhered directly to the roof surface)
		15.32.11	Adapter piece for collector manifold, tile spacing > 340 mm
	1	15.40.10	Solar control SC 3
	1	15.40.11	Motor reversing valve d = 50
	1	15.40.12	Motor reversing valve d = 63
	1	15.40.13	Solar control SC Compact Control integrated in motor reversing valve, d = 50
	1	15.40.14	Solar control SC Compact Control integrated in motor reversing valve, d = 63

# Solar systems

## SUNNY PLATE® solar systems

We have been offering the technically mature and proven SUNNY PLATE® solar system since 1979. These solar plate collectors are the world's best-selling products of this type and consist of UV-resistant polypropylene.

### Advantages at a glance

- The product is technically mature.
- Simple installation and fastening.
- As in all other MTH solar collectors, the conversion efficiency is higher than in collectors covered with glass or foil.
- Matt black tube structure of the collectors.
- Corrosion-resistance, i.e. the pool water flows through the collectors without needing a heat exchanger.
- Low purchasing costs for the system are quickly recouped.
- Easy retrofitting in existing systems.

### Function

As a rule, the solar system is installed in an existing filter circuit. The circulation pump of the filter system then also works for the solar system.

The motor reversing valve is fitted in the existing pool supply pipe. A T-piece has to be set here because of the standpipe of the solar system which departs from the motor reversing valve.

After the reversing valve, the return pipe leads from the solar system back into the pool supply pipe, where the second T-piece is required. The motor reversing valve is controlled by the electronic temperature control. This control is fed with information from the solar sensor which is mounted on the collector, and from the water sensor which is fitted in the pool supply pipe.

The water sensor measures the temperature of the pool water. If the solar sensor measures a higher temperature than that of the pool water, then the solar control switches the motor reversing valve on and the pool supply line is blocked.

This means that the pool water now has to flow over the roof through the solar system.

The water flows through the individual tubes and is heated up before flowing back through the collector manifold into the pool circuit.

Usually this does not create any additional electricity costs, because the solar system runs on the filter pump which is operating anyway.



### **i** Note:

The SUNNY PLATE® system is not suitable for installation on flat roofs. The roof needs an adequate pitch so that the system can be drained with the ventilation valve.

### **i** Caution:

There is a frost risk at temperatures below 5°C if the system has not been drained.

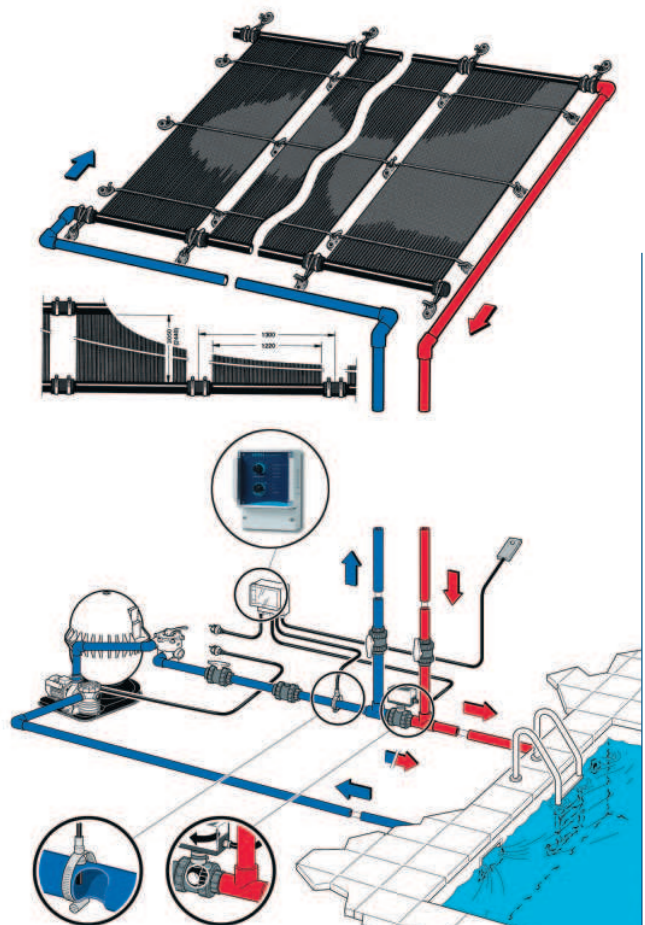

# Solar systems

## SUNNY PLATE®

		with SP 25	with SP 30	with SP 42
	Article No.	Article No.	Article No.	Article No.
Solar pool heating in a set incl. accessories (set of 6 collectors SP 30) (for covered pools with up to 37 m <sup>2</sup> water surface)		15.23.13 D	15.23.11 D	15.23.15 D
Solar pool heating in a set incl. accessories (set of 4 collectors SP 30) (for covered pools with up to 25 m <sup>2</sup> water surface)		15.23.14 D	15.23.12 D	15.23.16 D
Collector extension set, 2 each SP 30	15.23.10 D			
Collector SP 42	15.13.12 D			
Collector SP 30	15.13.11 D			
Collector SP 25	15.13.10 D			
Fastening accessories for SUNNY PLATE®	15.33.10 D			
Ventilation valve	15.92.14 D			
End cap	15.92.15 D			
Connection accessories for pipe for SUNNY PLATE®	15.33.11 D			
SUNNY PLATE® mastic adhesive (310 ml)	15.92.10 D			

### Scope of supply of the set:

**6 or 4 solar collectors**, 3.7 m<sup>2</sup> effective surface area for SP 30

#### 6 or 4 sets of fastening accessories

(each set consisting of 2 short rubber bushings, 4 stainless steel hose clips, 5 double eyelets, 3 long fabric tapes, 1 short fabric tape, 1 PVC tape)

#### 1 ventilation valve, 1 end cap

**1 set of connection accessories for the pipe** (consisting of: 2 long rubber bushings, 4 stainless steel hose clips, 5 double eyelets, 1 short fabric tape, 1 short PVC tape),

#### 1 plastic ball valve

**1 sealing cartridge** original SUNNY FLEX MASTIC

### Scope of supply of the extension set:

2 solar collectors 3.7 m<sup>2</sup> effective surface area with 2x fastening accessories

### Control

A solar control (temperature difference control) should always be used, because Central European weather often makes it difficult to decide whether the solar system would heat or cool the water.

### Technical data SUNNY PLATE:

	SP 25	SP 30	SP 42
Length:	2.44 m	3.05 m	4.20 m
Width:	1.22 m	1.22 m	1.22 m
Effective surface area:	3.00 m <sup>2</sup>	3.72 m <sup>2</sup>	5.10 m <sup>2</sup>
Empty weight:	7.5 kg	9 kg	11.5 kg
Water contents:	13 kg	16 kg	22 kg

Sets can also be supplied with collectors SP 25 and SP 42.



# Solar systems

## Solar controls

	Article No.
<b>Solarcontrol SC 2</b> with solar and water sensor and digital display	15.40.09 D
<b>Solarcontrol SC 3</b> with solar and water temperature sensor and clip for water sensor	15.40.10 D

In this control, the required water temperature is adjusted by hand, e.g. 28°C. When the temperature is exceeded, the water cools down automatically over night. The system offers additional information, such as: heating temperature has reached nominal level, cooling. Light-emitting diode display. The system shows a frost warning when the air temperature falls below 5°C.

The **motor reversing valve** operates with low voltage of 24V. The corresponding safety transformer is included in the solar control. **d = 50/63**

2-way	Article No.
<b>d = 50 mm</b>	15.40.11 D
<b>d = 63 mm</b>	15.40.12 D
3-way	Article No.
<b>d = 50 mm</b>	15.40.29 D
<b>d = 63 mm</b>	15.40.30 D

### Solarcontrol SC compact

Solar control with temperature difference control integrated in the motor reversing valve (24 V) with power supply unit 230 V, with ball valve **d = 50/63**, water and solar sensor and clip for water sensor

	Article No.
<b>d = 50 mm</b>	15.40.13 D
<b>d = 63 mm</b>	15.40.14 D

### Solarcontrol SC 230

Solar control with temperature difference control integrated for connecting a pump (230 V) up to 2.0 kW output, with water and solar sensor and clip for water sensor

	Article No.
	15.40.15

	Article No.
<b>Solar sensor</b>	15.40.16 D
<b>Water sensor</b>	15.40.17 D

BESGO 4/2-way solar valve made of PVC-U for quiet operation DN 40/d = 50 mm , incl. top-mounted 3/2-way 230V solenoid valve

	Article No.
	20.96.34 E



Solarcontrol SC 2

Solarcontrol SC 3



Solarcontrol SC compact



Solarcontrol SC 230

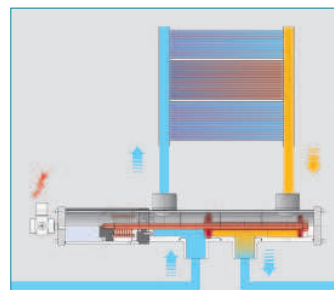

# Solar systems

## Solar accessories

PVC installation material in black	
	Article No.
Elbow 90°, d = 50 mm	48.12.10 D
Elbow 45°, d = 45 mm	48.12.11 D
T-piece 90°, d = 50 mm	48.12.12 D
Adhesive bushing, d = 50 mm	48.12.13 D
Pipe d = 50 mm x 2.4 mm, price per m	49.12.10 D

Solar accessories	
	Article No.
Rubber bushings	15.92.16 D
Solar clips	48.12.18 D
Fabric tapes, short	15.92.21 D
Fastening eyelets	15.92.18 D
Fastening accessories for SUNNY PLATE	15.33.10 D
Ventilation valve	15.92.14 D
End cap	15.92.15 D
Connection accessories for pipe for SUNNY PLATE	15.33.11 D
SUNNY PLATE mastic adhesive (310 ml)	15.92.19 D
PVC ball valve d = 50 mm (grey)	48.11.60 A
PVC ball valve d = 63 mm (grey)	48.11.61 A
Spacer, self-adhesive. 100 each	15.32.12 D
Draining fitting	15.92.10 D
Non-return valve for adhesive bushing d = 50 mm (grey)	48.11.64 A
Non-return valve for adhesive bushing d = 63 mm (grey)	48.11.65 A
Dirt trap, PVC, with adhesive bushing d = 50 mm (grey)	48.11.66 D
Dirt trap, PVC, with adhesive bushing d = 63 mm (grey)	48.11.67 D
Repair set for SUNNY PLATE	15.33.14 D
Repair plug for SUNNY PLATE	15.33.13 D
Repair set for SUNNY FLEX®	15.32.13 D
Repair set for SUNNY FLEX® S	15.31.15 D



## Solar systems

### SUNNY MAX™ solar systems – collector for above ground pools



#### SUNNY MAX™

Simple, low-cost solar collector made of extruded UV-resistant polypropylene, with collector manifolds  $d_a = 50$  mm,  $d_i = 1\frac{1}{2}$ "  
Dimensions (W / L / area) 1.22 m / 6.30 m / 7.70 m<sup>2</sup>

#### Connection accessories:

- 1 elbow with 1½" outer thread and 38 mm hose connection
- 1 hose nozzle, 1½" x 38 mm hose connection
- 2 bungs 1½" (fitted in collector)  $d = 50$  and 38 mm
- 4 hose clips, 2 hose pieces NW 38 1.50 m and 3 m long

Article No.

15.24.10 D

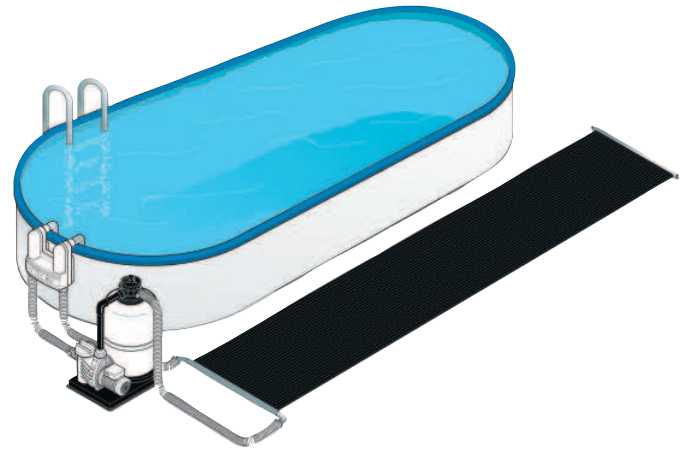

**FAFCO**  
**sunny & max™**  
made in Switzerland

#### SUNNY MAX™ plus

SUNNY MAX™'s big brother  
Dimensions (W / L / area) 1.22 m / 8.50 m / 10.30 m<sup>2</sup>

#### Connection accessories:

- 1 elbow with 1½" outer thread and 38 mm hose connection
- 1 hose nozzle, 1½" x 38 mm hose connection
- 2 bungs 1½" (fitted in collector)  $d = 50$  and 38 mm
- 4 hose clips, 2 hose pieces NW 38 1.50 m and 3 m long

Article No.

15.24.11 D

### Advantages compared to similar systems

- High output with no webs between the tubes to reduce system efficiency
- Larger number of tubes for far lower friction losses
- Far greater stability with the collector not consisting just of single strips
- Very robust connection between tubes and collector manifold
- Opening in collector manifold results in far lower power loss in the filter pump



Must be dismantled at the end of the bathing season and stored so as to be protected from frost.

#### **i Caution!**

There is a frost risk at temperatures below 5°C.  
The system must be drained first.







# swimming pool heaters

# Swimming pool heaters

## Stainless steel heat exchangers for heating the pool water

- Heat exchanger made of V4A (1.4401).
- Outer jacket with welded pipe coil and immersion sleeve for electronic temperature measurement.
- Internal integrated water diversion for optimum heating of the pool water.

- The heat exchanger itself is heated by means of a central or low-temperature heating system, depending on the type.
- The operating pressure on the heater side is 10 bar, and 3 bar on the pool water side.
- Initial commissioning: see installation instructions.

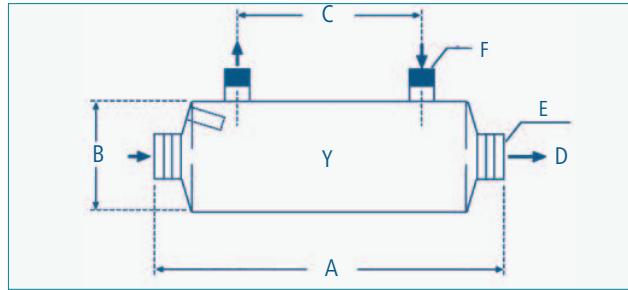

HWT and NWT

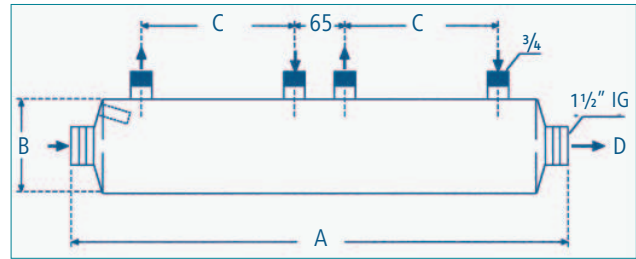

SHWT



Type	A	B	C	D	E	F
kcal x 1000	mm	ø	mm	mm	inch	inch
HWT 40	385	125	205	50	1½	¾
HWT 70	680	125	290	50	1½	1
HWT 104	780	160	430	60	2	1
HWT 140	1050	160	295	60	2	1
HWT 209	1370	160	430	60	2	1
NWT 20	680	125	335	50	1½	¾
NWT 40	1050	160	570	50	1½	1
SHWT 40	605	125	570	50	1½	1

Type	Output in kW		Min. pump rate	Heating loss	Min. pump rate	Pool water loss	Article No.
kcal x 1000	90°-70°	60°-40°	heating m³/h	bar	pool water m³/h	bar	
Heating heat exchanger HWT 40	40	28	2	0.18	10	0.11	22.11.10 C
Heating heat exchanger HWT 70	70	31	3	0.15	12	0.15	22.11.11 C
Heating heat exchanger HWT 104	104	55	5	0.20	15	0.20	22.11.12 C
Heating heat exchanger HWT 140	140	62	2 x 3	0.15	20	0.50	22.11.13 C
Heating heat exchanger HWT 209	209	110	2 x 5	0.20	25	1.00	22.11.14 C
Low-temperature heat exchanger NWT 20	20 at 50° - 40°		1.2	0.10	10	0.18	22.11.15 C
Low-temperature heat exchanger NWT 40	40 at 50° - 40°		2.2	0.20	10	0.30	22.11.16 C
Low-temperature heat exchanger NWT 52	50 at 50° - 40°		3.6	1.5	10	1.2	22.11.18 C
Solar heating heat exchanger SHWT 40	50°-40° 90°-70°		2	0.18	10	0.11	22.11.17 D
	Solar 10 Heating 40						
Fastening clips made of plastic (pair) d = 125 mm							22.90.10 D
Fastening clips d = 160 mm							22.90.16 D
Rubber hose mounting set incl. 4 stainless steel clips d/50							22.90.11 D

Larger heat exchangers on request

# Swimming pool heaters

## Heat exchanger for heating the pool water

<b>Plastic heat exchanger type Kstw 47.5 kW</b>	
Top quality plastic heat exchanger consisting of a plastic housing (polyamide) and a stainless steel ring corrugated hose coil mounted in the housing, material (1.4571) V4A, heating side with inserted metal thread G 3/4"	
Article No. 22.13.10 C	

<b>Swim-tec® heat exchanger made of titanium</b>	
<b>TWT 35</b> swimming pool connections 1 1/2" outer thread, output: 70/90° C - 40 kW 40/60° C - 13 kW	
Article No. 22.12.10 D	

<b>TWT 65</b> swimming pool connections 1 1/2" outer thread, output: 70/90° C - 65 kW 40/60° C - 26 kW	
Article No. 22.12.11 D	

<b>TWT 93</b> swimming pool connections 2" outer thread, output: 70/90° C - 105 kW 40/60° C - 60 kW	
Article No. 22.12.12 D	

<b>Sand filter heat exchanger combination (add surcharge to filter price)</b>	
Heat exchanger combination, filter pump 230 V AC	
Article No. 22.41.10 D	
Heat exchanger combination, filter pump 400 V three-phase	
Article No. 22.41.11 D	

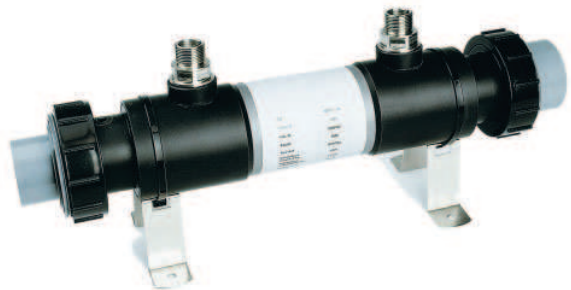

## Sand filter electric heater combination

<b>With control for filter circulation pump:</b>					
<b>230 V~, 50 Hz, Filter Control FC 1W</b>			<b>400 V 3~, 50 Hz, FC 1D</b>		
	Article No.		Article No.		
EKH 4	22.41.12 D		22.41.16 D		
EKH 6	22.41.13 D		22.41.17 D		
EKH 12	22.41.14 D		22.41.18 D		
EKH 18	22.41.15 D		22.41.19 D		

<b>With control for filter circulation pump:</b>					
<b>Pool Consulting 230 V</b>			<b>400 V</b>		
	Article No.		Article No.		
LEH 3	22.41.20 D		22.41.25 D		
LEH 4	22.41.21 D		22.41.26 D		
LEH 6	22.41.22 D		22.41.27 D		
LEH 9	22.41.23 D		22.41.28 D		
LEH 12	22.41.24 D		22.41.29 D		



**Note**  
DIN 4751, Part 2, Water heating installations, stipulates that a safety temperature controller (STW) must be present to protect the installation.  
See clip-on thermostat 67

**i**  
Surcharge for a combination of sand filter, electric heater, filter control, pipes and mounted on a pallet.  
The surcharge must be added to the price of the required sand filter.



## Swimming pool heaters

### The low-priced solution

Thermoblock standard type W respectively D heat exchanger type HWT 40 made of stainless steel V4A, fastened with removable plastic hood, heating circulation pump R 3/4", gravity brake R 3/4", temperature and time control Swim-tec® Pool Consulting 230 V for AC resp. 400 V for three-phase current.

	Article No.	
Thermoblock standard type W 230 V for AC	22.42.10 D	
Thermoblock standard type D 400 V for three-phase current	22.42.11 D	



### Automatic heat exchanger for connecting to the central heating

Heat exchanger type SBWT 40 made of stainless steel V4A, wall-mounting unit with removable front cover, electronic temperature control, heating pump, gravity brake

Thermoblock with control, type HWT 40 TW for connection to an AC filter pump, with temperature and time control Swim-tec® Pool Consulting		
	Article No.	
	22.42.12 D	

Thermoblock with control, type HWT 40 TD for connection to a three-phase filter pump, with temperature and time control Swim-tec® Pool Consulting		
	Article No.	
	22.42.13 D	

### Note

DIN 4751, Part 2, Water heating installations, stipulates that a safety temperature controller (STW) must be present to protect the installation. See clip-on thermostat [67](#)



### The kit

Kit consisting of heat exchanger type HWT 40 made of stainless steel V4A, fastening clips (pair), heating circulation pump R 3/4", gravity brake R 3/4", temperature and time control Swim-tec® Pool Consulting 230V for AC

	Article No.	
	22.42.14 D	





# Swimming pool heaters

## Electric swimming pool heaters

Type	Rated output	Article No.
Type SBHE 24	Rated output 24 kW	22.21.10 C
Type SBHE 30	Rated output 30 kW	22.21.11 C
Type SBHE 36	Rated output 36 kW	22.21.12 C
Type EKH 4	Rated output 4 kW	22.21.13 C
Type EKH 6	Rated output 6 kW	22.21.14 C
Type EKH12	Rated output 12 kW	22.21.15 C
Type EKH18	Rated output 18 kW	22.21.16 C
Type LEH 3	Rated output 3 kW	22.21.17 D
Type LEH 4	Rated output 4 kW	22.21.18 D
Type LEH 6	Rated output 6 kW	22.21.19 D
Type LEH 9	Rated output 9 kW	22.21.20 D
Type LEH 12	Rated output 12 kW	22.21.21 D



## Small electric swimming pool heaters

		Stainless steel V4A	Titanium
Type	Rated output	Article No.	Article No.
Type 1.5	Rated output 1.5 kW	22.11.19 D	22.12.13 D
Type 3	Rated output 3 kW	22.11.20 D	22.12.14 D
Type 6	Rated output 6 kW	22.11.21 D	22.12.15 D
Type 9	Rated output 9 kW	22.11.22 D	22.12.16 D
Type 12	Rated output 12 kW	22.11.23 D	22.12.17 D
Type 15	Rated output 15 kW	22.11.24 D	22.12.18 D
Type 18	Rated output 18 kW	22.11.25 D	22.12.19 D

**Housing material:** V4A – electropolished; titanium – silver varnished

**Heating rod material:** only available in Incoloy 825

**Safety features:** control thermostat 0-40°C, safety thermostat 55°C, flow controller min. 2200 l/h

**Operating pressure:** max. 3 bar

**Wall bracket:** plastic D 50 mm

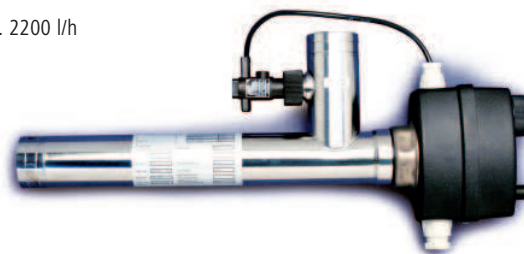

**i** All electric heaters are only available in three-phase current.  
Electric heater LEH is only available with welded feet.

## Accessories

	Article No.
Gravity brake with connection R 3/4"	22.90.15 D
Clip-on thermostat as safety temperature controller	22.90.14 D
Solenoid valve R 1/2", 230 V	20.95.17 D
Solenoid valve R 3/4", 230 V	20.95.25 D
Heating circulation pump R 3/4", type Speck, connection R 3/4", structural length 130 mm, N 20/33 max., circulation rate 1.5 – 2 m³/h. Power consumption P1, 30 W, 45 W, 65 W	20.21.39 C







# swimming pool technology

# Measuring and control equipment

## Measuring, control and dosing systems for private swimming pools



**Systematic water care:** Swim-tec® dosing systems are responsible for controlling the pH value of the water every day and check how much disinfectant is added. The necessary quantity of water care products is added to the pool water as required.

Crystal-clear water at all times: you can go off on your travels for weeks at a time.

Swim-tec® dosing systems ensure that the water always has the same quality. Choose classic water treatment with chlorine: most efficient and particularly effective, therefore suitable for open-air pools or pools with higher water temperatures. Or opt for the gentle method with active oxygen: suitable for people who are allergic to chlorine, or for avoiding the typical chlorine smell in indoor pools. The active oxygen method is less effective so that it may be necessary to use chlorine briefly from time to time.

All systems can be retrofitted to already existing swimming pools without any problems.



### Swim-tec® DOS pH Basic

Microprocessor-controlled measuring, control and dosing system for controlling the pH value.

**Measuring range:**

pH 6,2 - 8,  $\Delta$  pH = 0,2

**Control characteristics:**

Can be changed over from pH+ to pH-

**Protection device:**

Activation delay, dosing time limitation

**Control:**

LED display, 2 buttons

**Dosing pump:**

Hose dosing pump max. 1.6 l/h, with spring-mounted rollers for extremely quiet, robust operation

**Scope of supply:**

- Measuring, control and dosing system  
Swim-tec® DOS pH Basic
- pH and Rx sensor with fixed cable and SN6 plug
- Buffer solutions pH 4 and pH 7
- Hose dosing pump 1.6 l/h
- Dosing line
- Inoculation valve and suction filter with foot valves for extracting from tank
- Installation set for pH sensor and inoculation valve in the pipe d=50 mm



Swim-tec® DOS pH Basic

Swim-tec® DOS pH Basic	Article No.	
	37.31.27 E	



## Measuring, control and dosing systems by for private swimming pools

### EWADOS concept

Low-priced dosing system, easy to install.

#### Scope of supply:

- Dosing hose pump, pumping rate approx. 17 ml/min
- Daily/weekly timer module TM 2000
- Snap lid for changing the pump hose quickly and easily
- Simple function: when the power is switched on, the dosing hose pump pumps during the programmed interval
- Flexible suction line DN 4 1/4 with foot valve and ceramic weighting piece, hose length 2500 mm
- Possibility for connecting a suction lance with "status empty"
- Possibility for connecting an external warning signal (230 V) for indicating operating faults (warning signal not included in the scope of supply)
- Hose breakage safeguard
- Compact housing, protection IP 65
- Inoculation point G1/1 complete with hose connection
- Pressure hose PE d = 4/6; 2.0 m
- Drilling clip d = 50 with thread 1/2" for fastening the inoculation point



EWADOS concept

Article No.	
37.31.12 F	

### Swim-tec® DOS pH/Redox Basic

Microprocessor-controlled measuring, control and dosing system for controlling the pH value and the chlorine level by means of redox potential.

#### Measuring range:

pH 6,2 - 8,  $\Delta$  pH = 0,2

Redox: 650 - 900,  $\Delta$  Redox: 25 mV

#### Control characteristics:

Can be changed over from pH+ to pH-

#### Protection device:

Activation delay, dosing time limitation

#### Control:

LED display, 3 buttons

#### Dosing pump:

Hose dosing pump max. 1.6 l/h, with spring-mounted rollers for extremely quiet, robust operation

#### Scope of supply:

- Measuring, control and dosing system  
Swim-tec® DOS pH/Redox Basic
- pH and redox sensor with fixed cable and SN6 plug
- Buffer solutions pH 4 and pH 7 and Rx 475 mV
- Hose dosing pump 1.6 l/h
- Dosing line
- Inoculation valve and suction filter with foot valves for extracting from tank
- Installation set for pH sensor and inoculation valve in the pipe d=50 mm



Swim-tec® DOS pH/Redox Basic

Article No.	
37.31.28 E	

## Measuring and control equipment

### Tried and tested measuring and control equipment for private swimming pools

#### Water care without chlorine



##### Clearline DOS SL3 de luxe

Microprocessor-controlled measuring, control and dosing system for controlling the pH value and for time- and temperature-dependent active oxygen dosing.

**Measuring range:**

pH 0-14, active oxygen dosing time is calculated automatically depending on pool water temperature and pool size, pool water temperature displayed alternately with day, time and date.

**Control characteristics:**

Can be changed over from pH+ to pH- (PID) and dosing active oxygen (daily 7 ml/m<sup>3</sup> at 25°C)

**Control:**

Intuitive user interface with LC display, 4 buttons – quick and easy to use

**Protection device:**

Activation delay 0 – 15 minutes, dosing time limitation 0 – 240 minutes, dosing pump switched off when canister empty

**Dosing pumps:**

Hose dosing pump max. 1.6 l/h, with spring-mounted rollers for extremely quiet, robust operation

**Scope of supply:**

Measuring, control and dosing system Aqua Consulting private Clearline DOS SL 3 de luxe, with two storage tubs for canisters 25 l / 30 l, single measuring water flow cell with 2 stop valves, hose connection nipples and 10 m measuring water pipe, 1-pH single bar measuring chain, temperature sensor, measuring cable, buffer solutions pH 4 and 7, one dosing station each for pH and active oxygen with hose pumps, suction lances with level shutdown (tank empty), dosing line PTFE each 1.5 m with inoculation valves (VITON). System tested in the workshop and packed in a box.



Aqua Consulting private Clearline DOS SL 3 de luxe	
Article No.	
37.31.10 E	

#### Water care with chlorine



##### Swim-tec® DOS CL 2 de luxe

Microprocessor-controlled measuring, control and dosing system for controlling the pH value and the chlorine level by means of redox potential.

**Measuring range:**

pH 0-14, redox +/- 2000 mV and display of pool water temperature.

**Control characteristics:**

Can be changed over from pH+ to pH- (PID), redox (PID)

**Control:**

Intuitive user interface with LC display, 4 buttons – quick and easy to use

**Protection device:**

Activation delay 0 – 15 minutes, dosing time limitation 0 – 240 minutes, dosing pump switched off when canister empty.

**Dosing pumps:**

Hose dosing pump max. 1.6 l/h, with spring-mounted rollers for extremely quiet, robust operation

**Scope of supply:**

Measuring and control system Aqua Consulting private Swim-tec® DOS CL 2 de luxe, with two storage tubs for canisters 25 l / 30 l, 1 double measuring water flow cell with 2 stop valves, hose connection nipples and 10 m measuring water pipe, 1 pH and Rx single bar measuring chain, temperature sensor, measuring cable, buffer solutions pH 4, pH 7 and redox 475 mV, one dosing station each for pH and chlorine with hose pumps, suction lances with level shutdown, dosing line PTFE each 1.5 m with inoculation valves (VITON). System tested in the workshop and packed in a box.

Aqua Consulting private Swim-tec® DOS CL 2 de luxe	
Article No.	
37.31.11 E	

## Measuring and control equipment Premium Line

### ProMinent®

#### Measuring and control system:

ph and Redox

The DULCOPOOL® DSR swimming pool controller is a microprocessor-controlled measuring and control unit for measuring and controlling the pH value and redox voltage. It measures and displays the pH value and the redox voltage. The DSR performs control functions with the corresponding actuators (e.g. dosing pumps). All adjusted values are saved in duplicate in an EEPROM with fail-safe storage even in case of a power failure.

#### Scope of supply:

- Measuring and control system DULCOPOOL® DSR mounted on a mounting plate
- 2 Dulcoflex hose pumps, 1.6 l/h resp. alpha membrane dosing pump
- 1 flow transmitter as adapter for pH value measuring point, redox measuring point and flow sensor
- 1 pH measuring cell
- 2 suction lances made of PVC/Viton, 6 x 4 mm without level switch
- 2 dosing valves made of PVC/Viton, 10 x 4 mm
- 1 measuring water line made of PE, 8 x 5 mm, 10 m long
- 1 dosing line made of fabric-reinforced PVC, 10 x 4 mm, 10 m long
- 1 suction line made of PVC, 8 x 5 mm, 5 m long
- 2 measuring water sampling ball valves made of PVC, 1/2" – 8 x 5 mm
- 1 set buffer solution pH and redox



Measuring and control system DULCOPOOL® DSR with

Hose pumps	Article No. 37.31.22 F
Membrane pumps	Article No. 37.31.30 F

### ProMinent®

#### Measuring and control system:

pH and chlorine

The DULCODOS POOL (respectively DULCODOS POOL for membrane pumps) swimming pool controller is a microprocessor-controlled measuring and control system for measuring and controlling the pH value and chlorine. It measures and displays the pH value and the chlorine level. The ACL2A can perform control functions with the corresponding actuators (e.g. dosing pumps).

#### Scope of supply:

- 1 D2CA measuring and control system
- 1 Beta membrane dosing pump for dosing chlorine bleach lye
- 1 Beta membrane dosing pump resp. Dulcoflex hose pump for dosing acid
- 1 DGMa flow transmitter module as adapter for pH value and chlorine measuring point, one module for visual display and evaluation of the measuring water flow with protection filter
- 1 measuring water monitor
- 1 mounting plate made of white PP
- 1 pH measuring cell, type: PHES 112 SE
- 1 chlorine measuring cell CLE 3 2ppm mA or
- 2 suction lances with level switch made of PVC/Viton, 6 x 4 mm

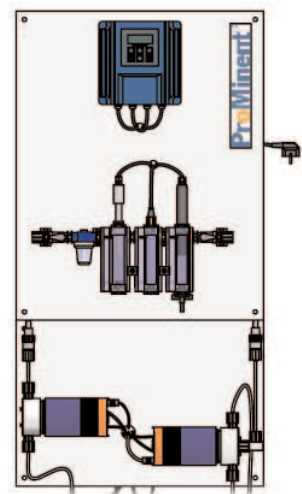

- 2 dosing valves made of PVC/Viton, 10 x 4 mm
- 1 measuring water line made of PE, 8 x 5 mm, 10 m long
- 1 dosing line made of fabric-reinforced PVC, 10 x 4 mm, 10 m long
- 1 suction line made of PVC, 8 x 5 mm, 5 m long
- 2 measuring water sampling ball valves made of PVC, 1/2" – 8 x 5 mm
- 1 set buffer solution and electrolyte for the chlorine probe

Measuring and control system DULCODOS POOL ACL2A with

Hose pumps	Article No. 37.31.25 F
Membrane pumps	Article No. 37.31.29 F

# Measuring and control equipment

## Accessories for dosing systems



	Article No.	
pH sensor with fixed cable and SN6 plug	37.39.12 E	
Rx sensor with fixed cable and SN6 plug	37.39.13 E	



	Article No.	
Buffer solution pH 7	37.39.19 E	
Buffer solution pH 4	37.39.18 E	
Buffer solution 475 mV	37.39.17 E	



	Article No.	
Measuring water line 8/6 mm per m	37.39.25 E	
Dosing line PTFE 4/6 mm per m	37.39.26 E	
Inoculation valve 3/8" AG	37.39.27 E	
Mini ball valve 1/4"	48.11.91 E	
Connection nipple for measuring water pipe, blue	37.39.58 E	



	Article No.	
Hose dosing pump, 1.5 l/h, 230 V	37.39.22 D	
Spare hose for dosing pump	37.39.23 E	
Drive cross	37.39.24 F	
Hose pump Swim-tec® Basic and de luxe	37.39.39 E	
Spare hose de luxe	37.39.40 F	



	Article No.	
Suction lance with chlorine level switch	37.39.29 E	
Suction lance with pH level switch	38.39.30 E	
Suction lance with Clearline level switch	37.39.31 E	
Storage tub for safe storage of 25 l or 30 l canister	37.39.11 F	

# Pool UV-disinfection equipment

## for hygienically clean pool water

Simple, gentle treatment for swimming pool and whirl-pool water. Clear bubbling water, free of chlorine smell and bacteria, in an environment- and user-friendly way. To support chemical water treatment, particularly where higher water temperatures or frequently used pools are concerned or where compatibility completely or partly prohibits the use of chemicals, MTH now offers a UV system which warrants additional safety and thus far better water quality.

The system even decomposes chloroform, bromoform and other undesirable side products of disinfection with chlorine bleach lye. One pleasant side effect is the partly drastic reduction in chemical treatment agents, while at the same time boosting the effect obtained, for example, when using oxygen products.

### The advantages:

- Drastic reduction in chlorine consumption
- Far lower quantities of water care agents
- No red eyes, no skin irritation
- Lower costs for chemicals
- Environment-friendly disinfection
- Long service life of the lamps of up to 9000 hours

### Pool UV

	Article No.
Type 50 up to 10 m³/h	41.21.11 D
Type 80 up to 15 m³/h	41.21.12 D
Type 120 up to 20 m³/h	41.21.13 D

### Spare parts



	Article No.
UV lamp 50/10	41.29.10 D
UV lamp 80/15	41.29.11 D
UV lamp 120/20	41.29.12 D
Quartz tube 50/10	41.29.13 D
Quartz tube 85/15, 120/20	41.29.14 D



During operation, flowing water must flow around the UV burners. It may be necessary to fit flow controllers.



Service water systems on request!

Units	Pool UV 50	Pool UV 80	Pool UV 120
			
Flow rate (max.)	10 m³/h	15 m³/h	20 m³/h
<b>UV-C lamp</b>			
Power output UV-C	17 W	27 W	38 W
Micro-organism killing rate	99,9%	99,9%	99,9%
Service life	9000 h	9000 h	9000 h
Temperature range	4 – 40°C	4 – 40°C	4 – 40°C
<b>UV housing made of V4A</b>			
Tube diameter, connection dimensions	1½" BSP outside	2" BSP outside	2" BSP outside
Outer diameter of the UV housing (mm)	130	130	130
Housing length (mm)	570	980	980
Chamber material	Edelstahl 316 L (2 mm Materialstärke)		
max. pressure	10 bar	10 bar	10 bar
<b>Switchboard</b>			
UV monitoring	<ul style="list-style-type: none"> <li>• LED, operation control of the UV lamp</li> <li>• Optics window at the top in the screw cap</li> <li>• Potential-free change-over contact for external alarm</li> </ul>		
Dimensions	220 x 120 x 80 (L x W x H) mm		
Connection	220/240V, 50Hz		





# **swimming pool accessories**

## Dolphin pool cleaners



### Dolphin Plus Battery

- Cordless pool cleaner with lithium ion battery
- Cleans the pool in 1.5 hours • Special programs
- Clogged filter bag indicator • Incl. caddy
- With remote control • New scanner software
- For pools up to 12 m long

**Combi brush** Article No. 40.12.31 E

**Wonder brush** Article No. 40.12.32 E



### Dolphin Luminous

- Lighting • Special programs • Cleans the pool in 1.5 hours
- 19 m cable with swivel • Clogged filter bag indicator
- Incl. caddy • With remote control • New scanner software
- For pools up to 12 m long

**Combi brush** Article No. 40.12.15 E

**Wonder brush** Article No. 40.12.16 E

### Dolphin Magic

- Pool cleaner for all pool shapes • Cleaning program takes 100 min • Cable with swivel • 19 m cable • Incl. caddy
- New scanner software • For pools up to 12 m

**PVC brush** Article No. 40.12.11 E

**Combi brush** Article No. 40.12.12 E

**Wonder brush** Article No. 40.12.13 E



### Dolphin Diagnostic

- Climbs walls • Large filter surface • Cable 20 m long with float
- 1 kg dirt absorption capacity • Incl. caddy • Cleans the pool in 3 hours • For pools up to 12 m long

**PVC brush** Article No. 40.12.20 E

**Combi brush** Article No. 40.12.21 E

**Wonder brush** Article No. 40.12.22 E

### Diagnostic and Dynamic filter bag

Article No. 40.13.61 E

Disposable bags 5 each Article No. 40.14.81 E

### Magic/Luminous filter bag

Article No. 40.13.78 E

### Moby filter bag

Article No. 40.15.29 E



### Dolphin Dynamic plus

- Special programs • Cleans the pool in 3 hours • 20 m cable with swivel • Clogged filter bag indicator • With Combi brushes
- Incl. caddy • With remote control • New scanner software
- For pools up to 12 m

<b>PVC brush</b>	Article No. 40.12.23 E
<b>Combi brush</b>	Article No. 40.12.24 E
<b>Wonderbrush</b>	Article No. 40.12.25 E

### Dolphin Dynamic pro X

- Special programs • Cleans the pool in 6 hours • 30 m cable with swivel • Clogged filter bag indicator • Incl. caddy
- With remote control • New scanner software
- For pools up to 25 m

<b>Combi brush</b>	Article No. 40.12.27 E
<b>Wonder brush</b>	Article No. 40.12.28 E



### Dolphin 2x2

- Climbs walls • Cable 40 m long with swivel • 2 x 1 kg dirt absorption capacity • With remote control • Incl. caddy
- Cleans the pool in 8 hours • Clogged filter bag indicator
- With Combi brushes • For public pools up to 60 m long

<b>PVC brush</b>	Article No. 40.12.17 E
<b>Combi brush</b>	Article No. 40.12.18 E
<b>Wonder brush</b>	Article No. 40.12.19 E



### Dolphin Moby

- Pool cleaner for all pool shapes • 19 m cable without caddy
- Cycle time 2.5 h • Small filter bag with 70 micron instead of 50 micron • Without remote control • 2 years guarantee
- Cleans the corners, not the walls • For pools up to 10 m long

<b>Combi brush</b>	Article No. 40.12.37 E
--------------------	------------------------



Your Dolphin pool cleaner is serviced and repaired quickly and reliably in our Dolphin Service Center in Glöching



# Swimming pool accessories

## Swimming pool installation parts made of gunmetal (Lahme parts) With stainless steel cover V4A ( 1.4401)

Extension piece made of gunmetal for surface extractor, length: 100 mm  
Article No. 36.21.30 C

Surface extractor made of gunmetal, with 2-way control valve, installation depth 24 cm  
Article No. 36.21.11 C\*

as above, without control valve  
Article No. 36.21.10 C\*

Pool cleaner connection plate. For surface extractor 36.21.11 and 36.21.10  
Article No. 36.21.36 C



Sealing plug 1 1/2"   
Article No. 36.28.10 C

Key for sealing plug   
Article No. 36.28.11 C

PVC hose nozzle NW 38   
Article No. 36.28.12 C

Water level controller, mechanical, made of gunmetal, matches surface extractor 36.21.11 and 36.21.10  
Article No. 36.28.13 C



Tile frame fits the lid of surface extractor 36.21.11 and 36.21.10, Ms, pol. NiZi   
Article No. 36.21.31 C

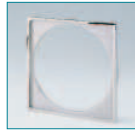

Double tile frame for 2 lids of the surface extractor and water level controller, Ms, pol. NiZi   
Article No. 36.21.32 C



Flange set for surface extractor, for foil and prefabricated pools   
Article No. 36.21.33 C



Flange set for surface extractor, for tiled pools, 15 mm wider on each side   
Article No. 36.21.34 C



Floor drain with right-angled outlet R 2"   
Article No. 36.23.10 C

Set of flange rings for floor drain   
Article No. 36.23.30 C



Electronic water level control with solenoid valve R 1/2"   
Article No. 36.92.10 C



Double seal for 36.21.11 and 36.21.10   
Article No. 36.91.14 C\*

### Wall leadthroughs for tiled and foil pools

240 mm R 2" inside x R 1 1/2" inside (302)   
Article No. 36.24.10 C

340 mm R 2" inside x R 1 1/2" inside (303)   
Article No. 36.24.11 C

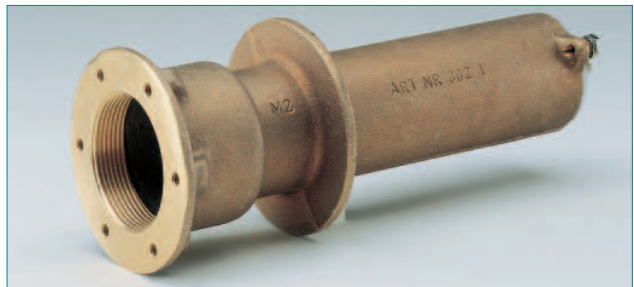

## Swimming pool accessories

### Inlet nozzles for foil pools with V4A stainless steel cover and ball



Flange parts only fit wall leadthrough 36.24.10 and 36.24.11 with nozzle, adjustable direction, ball 18 mm  $\varnothing$

Article No. 36.22.18 C

Inlet fitting with flange part. With nozzle, adjustable direction, 18 mm  $\varnothing$ , outer thread R 1½" x 40 mm

Article No. 36.22.10 C

Inlet fitting with flange part. With nozzle, adjustable direction, 18 mm  $\varnothing$ , outer thread R 2" x 40 mm

Article No. 36.22.11 C



### Inlet nozzles for tiled pool with V4A stainless steel cover



Inlet nozzle R 1½", thread length 40 mm, nozzle 18 mm  $\varnothing$

Article No. 36.22.12 C

Outer thread R 2", thread length 40 mm, nozzle 18 mm  $\varnothing$

Article No. 36.22.13 C

### Floor inlets for public pools

Floor nozzle for foil pools, adjustable quantity, lockable. R 2" outside and d-50 inside. Complete with seals and screws.

Article No. 36.12.13 C



Floor nozzle, adjustable quantity, lockable, G 1½", cover V4A

Article No. 36.22.16 C

Floor nozzle, adjustable quantity, lockable with connection angle, G 1½" x 2", cover V4A

Article No. 36.22.17 C

Set of flange rings, complete with seal and screws for Article No. 36.22.16 and Article No. 36.22.17

Article No. 36.22.32 C



# Swimming pool lighting

made of stainless steel

Concrete installation recess (V2A) for underwater spotlights incl. cable protection pipe

Article No. 37.79.10 C

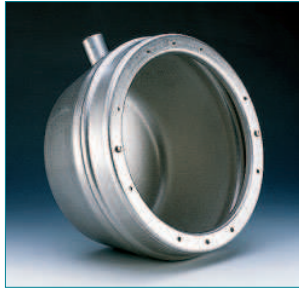

Underwater spotlight (V2A), used with 12V 300W light bulb, ø 250 mm

Article No. 37.79.11 C



Distribution box (V2A) for underwater spotlights 2 x PG 16 and 1 x 3/4" connections Anschlüsse

Article No. 37.79.12 C

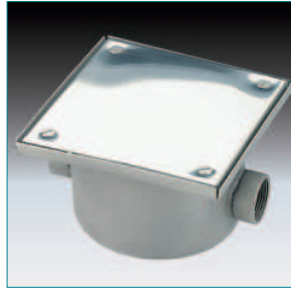

Flange set for underwater spotlights for prefabricated and foil pool, complete with seals and screws (V2A)

Article No. 37.79.13 C

Double seal for underwater spotlight installation recess (37.79.11)

Article No. 37.79.14 C

made of gunmetal

Installation recess

Article No. 37.79.19 C



Spotlight insert

Article No. 37.79.20 C



Connection box made of gunmetal (distribution box)

Article No. 37.79.27 C



Flange set for foil pools

Article No. 37.79.18 C

Double seal for underwater spotlight 37.71.13

Article No. 37.79.16 C

made of plastic

Underwater spotlight made of white plastic with installation recess made of ABS for foil pools, flange made of ABS

Article No. 37.71.10 A



Underwater spotlight made of white plastic with installation recess made of ABS for foil pools, flange made of stainless steel with installation recess made of ABS

Article No. 37.71.11 A



Connection box made of plastic (distribution box)

Article No. 37.79.26 B



Double seal for underwater spotlights (37.71.10 and 37.71.11)

Article No. 37.79.15 D

# Swimming pool lighting

## Safety transformer



For swimming pool lighting  
100 VA

Article No. 37.79.28 C

For connecting one spotlight  
300 VA

Article No. 37.79.30 C

For connecting three  
spotlights 900 VA

Article No. 37.79.32 C

For swimming pool lighting  
150 VA

Article No. 37.79.29 C

For connecting two spotlights  
600 VA

Article No. 37.79.31 C

Copper surcharge for transformers as per DEL notation when  
purchased from supplier Article No. 37.79.98 C



as per VDE 0550, protection  
IP 65, shock-resistant, com-  
pletely encapsulated in resin

## Spotlights

Underwater spotlight made of  
gunmetal, cover V4A, complete  
410 + 413, damp location  
recess made of bronze, special  
lamp, 12 V, 300 W

Article No. 37.71.13 C



Halogen underwater spotlight  
made of gunmetal, cover  
made of plastic, 12 V, 50 W,  
for surface-mounted pools  
with separate foil flange and  
counter-set

Article No. 37.71.14 C



Suspension spotlight complete  
with lamp 75 W / 12 V with  
transformer, mounted ready  
for connecting up

Article No. 37.71.12 E



### Lighting set for surface- mounting swimming pool

2 halogen underwater spot-  
lights made of gunmetal, cover  
made of plastic, 12 V, 50 W,  
with separate foil flange and  
counter set, safety transformer  
for swimming pool lighting  
100 VA, 2 connection boxes  
made of plastic

Article No. 37.72.11 C



## Lighting accessories

Halogen underwater spotlight  
insert, complete, 12 V, 50 W,  
cover A4

Article No. 37.79.17 C

Flange ring set for foil/  
prefabricated pool, to fit  
37.79.21

Article No. 37.79.22 C

Halogen light bulb, 12 V,  
75 W

Article No. 37.79.24 C

Halogen light bulb, 12 V, 50 W

Article No. 37.79.25 C

Spare lamp for underwater  
spotlight, 12 V, 300 W, fits:  
37.71.13, 37.71.10, 37.71.11,  
37.79.11 and 37.79.20

Article No. 37.79.23 C

Installation cup for halogen  
underwater spotlight

Article No. 37.79.21 C

## Counter-current swimming systems

### UWE Jet Stream massage nozzles for installation in the floor and wall

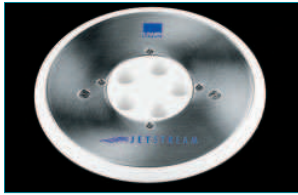

#### Jet Stream Viva

Floor system consisting of: shell part (RG), finished part with 3.5 kW three-phase pump and flange set for foil and polyester pools, with pneumatic switch (shell and finished part with control box)

Article No. 37.81.15 E



#### Jet Stream Lido

Wall-mounting system, consisting of: shell part (RG), finished part with 3.5 kW three-phase pump and flange set for foil and polyester pools, with pneumatic switch (shell and finished part with control box)

Article No. 37.81.16 E



#### Jet Stream Libra 3

Wall-mounting system with 3 wellness nozzles, ideal particularly for installation in steps. Consisting of: shell part (RG), finished part with 3.5 kW three-phase pump and flange set for foil and polyester pools, with pneumatic switch (shell and finished part with control box)

Article No. 37.81.17 E



On request, all our counter-current swimming systems can also be supplied in 230 V AC.

## Swim-tec® counter-current swimming systems

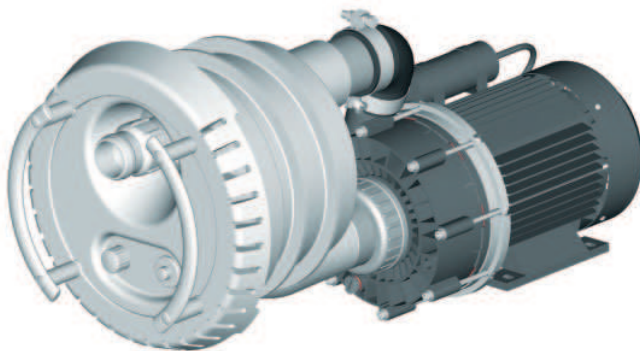

#### Swim-jet by Speck

Pre-mounted set made of plastic including flange set

Article No. 37.82.35 D

Ready mounted set made of plastic complete with PN switch, three-phase pump, power consumption 3.3 kW, power output 2.6 kW, cover with handles

Article No. 37.82.36 D

Ready mounted set as above. Pump AC, power consumption 2.3 kW, power output 1.6 kW

Article No. 37.82.37 D

# Counter- current swimming systems

## Speck counter- current swimming systems



### Badu Jet classic pre-mounted set

Article No. 37.82.24 D

### Badu Jet classic ready-mounted set 230/400V, 3N, 2.6 kW, three-phase

Article No. 37.82.25 D

### Badu Jet classic ready-mounted set 230 V, 2.2 kW, AC

Article No. 37.82.26 D



### Badu Jet super sport pre-mounted set

Article No. 37.82.27 D

### Badu Jet super sport ready-mounted set 230/400V, 3N, 3.0 kW

Article No. 37.82.28 D

### Massage hose, ø 40

Article No. 37.89.13 D

### Pump bracket

Article No. 37.89.36 D

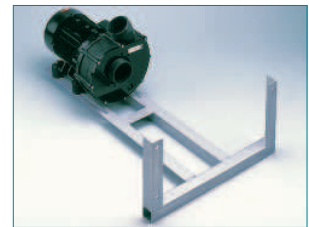

## Lahme counter-current swimming systems made of gunmetal Taifun and Taifun compact

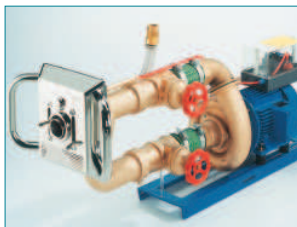

### Taifun

Installation kit Taifun, for rectangular and round shapes, installation depth 240 mm

Article No. 37.82.29 C

Connection set Taifun, rectangular fitting, made of V4A, with gunmetal pump 2.6 kW three-phase, power consumption 3.4 kW

Article No. 37.82.30 C

Connection set Taifun, but with round connection fitting

Article No. 37.82.31 C

### Taifun kompakt

Installation kit Taifun compact, for rectangular and round shapes, installation depth 250 mm

Article No. 37.82.32 C

Connection set Taifun compact, round fitting, made of V4A, with gunmetal pump 2.6 kW three-phase, power consumption 3.4 kW

Article No. 37.82.33 C

Connection set Taifun compact, but with rectangular connection fitting

Article No. 37.82.34 C



### Accessories

Flange set for foil pools

Article No. 37.89.30 C

Massage hose

Article No. 37.89.17 C

Pump bracket

Article No. 37.89.24 C

Handles made of V4A  
2 handles for rectangular fitting

Article No. 37.89.34 C

Handle made of V4A  
1 handle for round fitting

Article No. 37.89.35 C

## Swimming pool ladders – select import quality

### Stainless steel ladders for installed pools, wide angled shape



**Stainless steel ladder, type M, wide angled shape**, ladder beam  $d = 43$  mm, beams and steps made of stainless steel 1.4301 polished

3 steps with installation bracket

Article No. 37.21.18 C

4 steps with installation bracket

Article No. 37.21.19 C

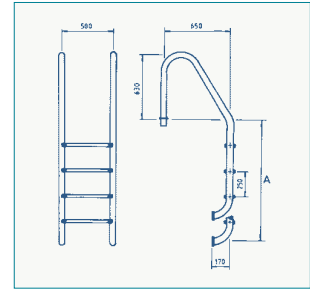

### Stainless steel ladders for installed pools, narrow angled shape



**Stainless steel ladder type T, narrow angled shape**, ladder beam  $d = 43$  mm, beams and steps made of stainless steel 1.4301 polished

3 steps with installation bracket

Article No. 37.21.20 C

4 steps with installation bracket

Article No. 37.21.21 C

**Flange fastening** for 3- and 4-step ladder, suitable for type T (narrow angled) and type M (wide angled)

Article No. 37.29.18 C

**Stainless steel pivot joints** (pair) for all ladder beams,  $d = 43$  mm, suitable for type T (narrow angled) and type M (wide angled)

Attachable sleeve for **installation bracket**

Article No. 37.29.19 C

**Flange fastening**

Article No. 37.29.20 C

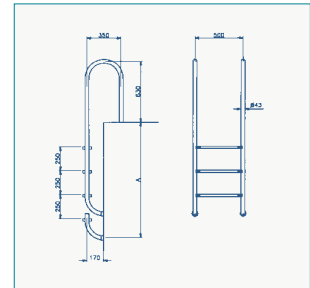

### Stainless steel ladders for installed pools, divided shape



**Stainless steel ladder type T, divided**, ladder beam  $d = 43$  mm, beams and steps made of stainless steel 1.4301 polished

3 steps with flange fastening

Article No. 37.21.22 C

4 steps with flange fastening

Article No. 37.21.23 C

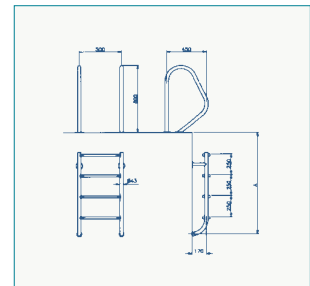

# Swimming pool ladders – select import quality

High pool ladders made of stainless steel for surface-mounting pools



Stainless steel ladder type R for surface-mounting pools, ladder beam d = 43 mm. Plastic steps and plastic platform

Pool height m	Steps	Article No.
1.2/0.4	4/1	37.21.24 C
1/1	3/3	37.21.25 C
1.2/1.2	4/4	37.21.26 C
1.35/1.35	5/5	37.21.27 C
1.5/1.5	5/5	37.21.28 C

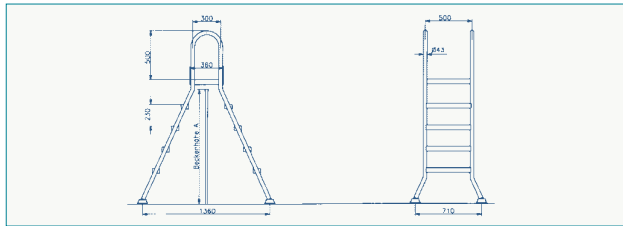

No. of steps	4/4	4/1	3/3
Pool height A	1.2/1.2 m	1.2/0.4 m	1.0/1.0 m

New low-priced ladder, ladder beams of steel, painted, d = 25 mm, pool height 1.2/1.2 m, steps 4/4

Article No. 37.21.29 C



## Holding bars

Stainless steel holding bars in select import quality (V2A)  
d = 40 mm, high gloss polished

Length 1 m, 2 straight supports

Article No. 37.22.13 E

Length 2 m, 3 straight supports

Article No. 37.22.14 E

Length 3 m, 3 straight supports

Article No. 37.22.15 E

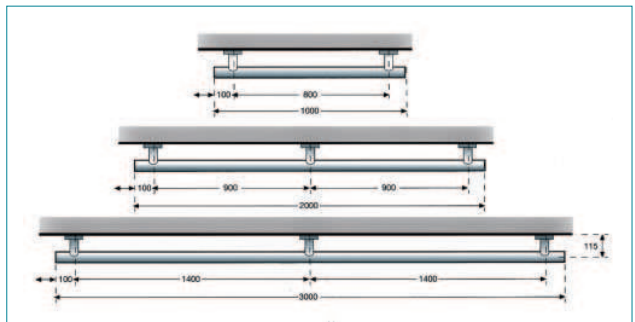

## Handles

1 pair, stainless steel V2A, d = 32 mm, high-gloss polished

Length 0.5 m, 2 flanges per handle with fastening material

Article No. 37.22.16 E



### **i** Tolerable chloride ions for material quality:

V2A = 210 mg/l, V4A = 500 mg/l, Stainless steel 1.4301 corresponds to V2A, stainless steel 1.4401 corresponds to V4A, stainless steel 1.4571 is 1.4401 with titanium content

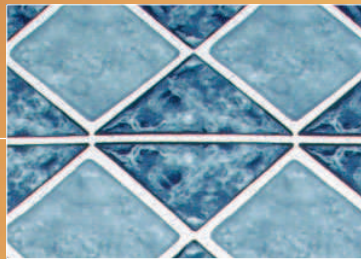



# swimming pool covers and liners

# Swimming pool covers SUNNY SAFE® S

## Safety covers

The safety cover is top class. The efficiently insulating, attractively shaped cover offers optimum safety. The new suspension and quick-fitting system fastens SUNNY SAFE® S quickly and easily across the pool.

Thanks to the additional straps, there is no longer any need to fix the cover at the sides\*. Side cut-outs and radii are not possible with this model.

The cover is available in blue, white and green. It is rolled up and out with a crank handle for easy operation in the right transmission ratio.

\*An additional wind safeguard is available for a surcharge.

**i Note**

No side cut-outs possible!

SUNNY SAFE® S	Article No.
Blue	32.61.97 D
Green	32.61.99 D
White	32.61.98 D

Packaging costs	Article No. 32.60.50
-----------------	----------------------

Roller gear with hand crank	
1 : 3	Article No. 32.91.15 E
1 : 7	Article No. 32.91.10 E
Ground anchor	Article No. 51.11.43

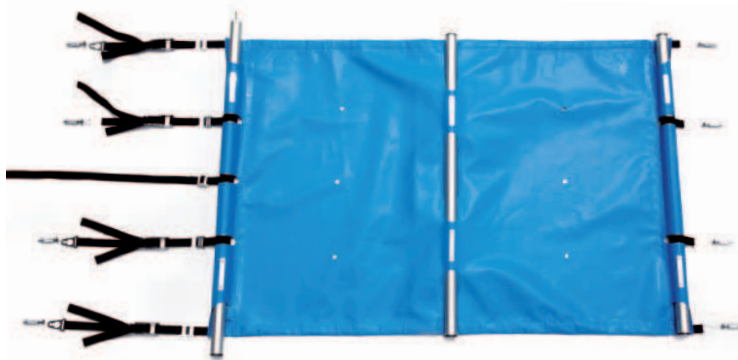

Snow load safeguard for SUNNY SAFE® S and SUNNY SAFE®	
	Article No.
Pool width up to 3 m	32.60.12 D
Pool width up to 4 m	32.60.13 D
Pool width up to 5 m	32.60.14 D
Pool width up to 6 m	32.60.15 D



# Swimming pool covers SUNNY SAFE®



## Safety covers

**Safety for humans and animals, while at the same time reducing energy costs and decreasing the amount of water care agents required:**

Tearproof polyester fabric with low-maintenance PVC coating with dirt-repellent finish. Can easily withstand the weight of children and also animals up to a max. load of 30 kg.

### Note

- For weight reasons, max. size: L x W: 9 m x 5.9 m (can only be cranked on one side for width 5.9 m)
- Cold-resistant to -30°C; does not withstand snow loads
- Anodised aluminium pipes spaced at intervals of approx. 1.2 m. These are incorporated under the cover and lie on the edge of the pool.
- Fungicide coating, therefore does not mould.
- Dimensions e.g. for pool size: L x W: 8 x 4 m, tarpaulin L x W: 8.4 m x 4.4 m

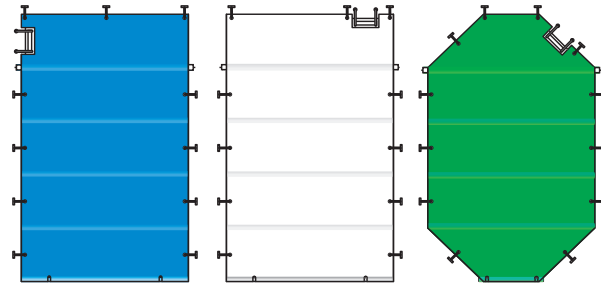

In blue, white (translucent) or green. Possible constructions with ladder cut-out. The driveshaft is fitted in the 2<sup>nd</sup> pipe.

SUNNY SAFE®	Article No.	
Blue	32.60.97 E	
White (translucent)	32.60.98 E	
Green	32.60.99 E	

Roller gear with hand crank		
1 : 3	Article No.32.91.15 E	
1 : 7	Article No.32.91.10 E	

	Article No.	
Cut-outs (e.g. for ladders)	32.60.10 D	
Chamfer	32.60.11 D	
Ground anchor	51.11.26	
Bungee strap with toggle	51.90.17	

Packaging costs	32.60.50	
-----------------	----------	--

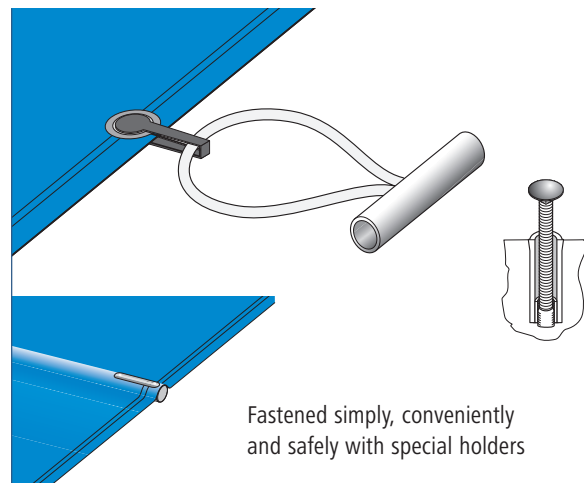

Fastened simply, conveniently and safely with special holders

### Note

The pipe supports for SUNNY SAFE® S and SUNNY SAFE® are made of a new material to protect the foil and the edge stones. Fastening without rivets and screws prevents the material from being scratched!



# Swimming pool covers

## Winter cover

### Winter net cover

Universal cover made of PVC-coated polyester fabric. Colour: blue and green. The cover protects from falling leaves, needles and other coarse impurities.

The tarpaulin has a sewn flap at the side.

Eyelets are inserted around the edge, spaced at intervals of 50 cm. Rubber straps are used to secure the tarpaulin in stainless steel retractable ground anchors (see detailed picture).

Each tarpaulin is made to measure, but larger than the pool itself by 25 cm on each pool side, or as stipulated by the customer. That means that the tarpaulin for a 5.0 m round pool is supplied with a diameter of 5.5 m. The price depends on the pool size, but for round or oval pools, on the circumscribed square or rectangle. The cover for a 5.0 m round pool is calculated with  $5.5 \times 5.5 = 30.25 \text{ m}^2$ . A drawing is required for a freely shaped pool or for a pool with added whirlpool.



Winter cover (green)	Article No. 32.70.99 D
Winter cover (blue)	Art.Nr. 32.70.98 D
Cut-outs (e.g. for ladders)	
	Article No. 32.70.10 D

### Caution

These covers (PE, winter cover, air bubble foil, laminated air bubble foil) do not act as accident safeguards.



### Caution

Safety and winter covers are always custom-made products and cannot be taken back.



# Swimming pool covers

## Cover tarpaulins

Polyethylene fabric coated on both sides, blue, underside black, extremely tearproof, rubber strap in eyelet, also suitable as winter cover

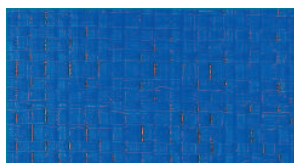

### Round pool



m ø	Article No.
1.80	32.11.10 D
2.40	32.11.11 D
3.00	32.11.12 D
3.50	32.11.13 D
3.60	32.11.14 D
<b>4.00</b>	<b>32.11.15 D</b>
4.20	32.11.16 D
4.50	32.11.17 D
4.60	32.11.18 D
<b>5.00</b>	<b>32.11.19 D</b>
5.50	32.11.20 D
6.00	32.11.21 D
6.50	32.11.22 D
<b>7.00</b>	<b>32.11.23 D</b>
7.50	32.11.24 D
<b>8.00</b>	<b>32.11.25 D</b>
8.50	32.11.26 D
<b>9.00</b>	<b>32.11.27 D</b>
<b>10.00</b>	<b>32.11.28 D</b>
12.00	32.11.29 D

Cover tarpaulin for rectangular pool and custom-made products according to size/m<sup>2</sup>

	32.19.99 D
--	------------

### Oval pool and eight form pool



m	Article No.
<b>4.90 x 3.00</b>	<b>32.13.10 D</b>
<b>5.25 x 3.20</b>	<b>32.12.10 D</b>
5.40 x 3.50	32.12.11 D
5.75 x 3.50	32.13.14 D
5.40 x 3.60	32.13.11 D
<b>6.25 x 3.60</b>	<b>32.12.12 D</b>
<b>6.30 x 3.60</b>	<b>32.13.19 D</b>
7.20 x 3.60	32.13.23 D
<b>7.37 x 3.60</b>	<b>32.13.26 D</b>
5.60 x 4.20	32.13.12 D
6.50 x 4.20	32.12.13 D
7.30 x 4.20	32.13.24 D
<b>8.00 x 4.00</b>	<b>32.13.28 D</b>
8.10 x 4.50	32.13.29 D
<b>7.25 x 4.60</b>	<b>32.12.14 D</b>
7.30 x 4.60	32.13.25 D
<b>9.16 x 4.60</b>	<b>32.13.35 D</b>
7.70 x 5.00	32.12.15 D
8.40 x 5.00	32.13.32 D
<b>8.55 x 5.00</b>	<b>32.12.16 D</b>
<b>9.00 x 5.00</b>	<b>32.13.34 D</b>
10.30 x 5.00	32.13.40 D
<b>11.00 x 5.50</b>	<b>32.13.41 D</b>
<b>9.20 x 6.00</b>	<b>32.12.17 D</b>
9.60 x 6.00	32.13.38 D
10.00 x 6.00	32.13.39 D

### **i** When making your selection

The "size" is the pool inner dimension. The cover tarpaulin is larger by 25 cm on each side and adequate when the pool is full.

If the water level is lowered, a larger tarpaulin must be selected, adding double the lowered dimension in length and width. These covers are custom-made products charged by the m<sup>2</sup>.

### **i**

The PE cover tarpaulins shown in bold print are standard tarpaulins which are normally always available ex stock. All other sizes are custom-made products which are produced specially and cannot be taken back.

### **i** Caution

These covers (PE, winter cover, air bubble foil, laminated air bubble foil) do not act as accident safeguards.

# Swimming pool covers

## Air bubble foil\*

### SUNNY POOL® air bubble foil\*, made to measure, particularly thick approx. 400 µm

Air bubble foil made to measure	
Article No.	32.29.98 D*
Surcharge for ladder cut-out	
Article No.	32.20.11 D

Pulling device with hemstitch, PVC pipe and pull rope	
Article No.	32.20.10 D

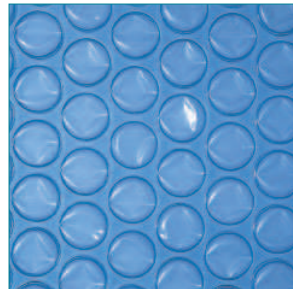

### SUNNY POOL® air bubble foil\*, prefabricated, particularly thick approx. 400 µm as a rectangle

m	Article No.
5.00 x 3.00	32.24.17 D
6.00 x 3.00	32.24.21 D
5.25 x 3.20	32.24.19 D
6.00 x 4.00	32.24.22 D
6.25 x 3.60	32.24.24 D
7.37 x 3.60	32.24.29 D
7.00 x 4.00	32.24.26 D
7.25 x 4.60	32.24.28 D
8.00 x 4.00	32.24.30 D
9.00 x 4.00	32.24.34 D
10.00 x 4.00	32.24.36 D
8.00 x 5.00	32.24.31 D

m	Article No.
8.55 x 5.00	32.24.33 D
10.00 x 5.00	32.24.37 D
12.00 x 5.00	32.24.39 D
10.00 x 6.00	32.24.38 D
12.00 x 6.00	32.24.40 D
3.00 x 3.00	32.24.11 D
4.00 x 4.00	32.24.14 D
5.00 x 5.00	32.24.18 D
6.00 x 6.00	32.24.23 D
7.00 x 7.00	32.24.27 D
8.00 x 8.00	32.24.32 D

### SUNNY POOL® air bubble foil\*, laminated

Air bubble foil 400 mm with laminated stabilising polyethylene top side.

Laminated air bubble foil made to measure	
Article No.	32.29.99 D
Surcharge for ladder cut-out	
Article No.	32.20.11 D

Pulling device with hemstitch, PVC pipe and pull rope	
Article No.	32.20.10 D



top side

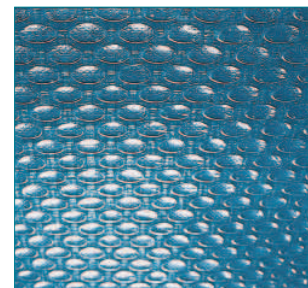

underside

#### Caution

These covers (PE, winter cover, air bubble foil, laminated air bubble foil) do not act as accident safeguards.

\* The lateral corrugation of the material means that an air bubble cover does not lie flat on the water. The service life depends greatly on the exposure to sunlight. In Central Europe, the mean service life is 3 to 5 years.

# Swimming pool covers

## SUNNY POOL® roller devices



### Roller device with crank handle for SUNNY POOL® swimming pool cover (air bubble foil)

	Article No.
Pool width up to 3 m	32.91.11 D
Pool width up to 4 m	32.91.12 D
Pool width up to 5 m	32.91.13 D
Pool width up to 6 m	32.91.14 D

### Spare parts

Aluminium shaft, anodised $\varnothing$ 90 mm	Article No. 32.99.10 D
1 pair bearing blocks	Article No. 32.99.11 D
Crank	Article No. 32.99.12 D

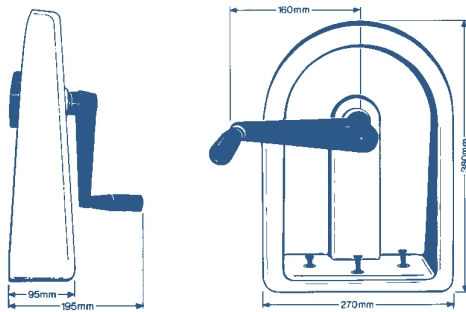

All versions are also available at the same price for mounting to the wall on one side

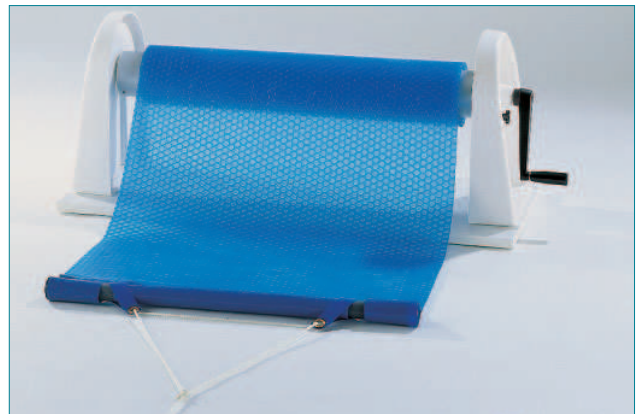

### Electric roller device for SUNNY POOL® swimming pool cover (air bubble foil)

Tubular motor with limit switch, transformer 24 V low voltage and surface switch, mounted in the aluminium pipe  $\varnothing$  100 mm of the roller device.

Motor operation supports the rolling up and unrolling action. Unintentional fully automatic operation is not possible.

Article No. 32.99.13 F



The lateral corrugation of the material means that an air bubble cover does not lie flat on the water. The service life depends greatly on the exposure to sunlight. In Central Europe, the mean service life is 3 to 5 years.

## Fitting the foil

The main advantages of fabric reinforced Alkorplan Super 2000 with acrylic finish:

**Greater resistance to bleaching from UV radiation**

UV-stability of the foil thanks to the acrylic-coated surface: the acrylic finish reflects UV radiation.

**Greater resistance to chlorine losses**

The acrylic finish protects the pigmentation

**Greater resistance to soiling**

The acrylic-coated surface prevents oil and grease from penetrating the foil.

**Easier to clean**

Less adhesion of dirt to the surface

**Greater resistance to micro-organisms**

Fungicide finish, resistant to algae, bacteria and microbes



Alkorplan SUPER 2000

**Alkorplan Super 2000 foil with acrylic finish – 1.5 mm thick**

Width/by the m	1.65 m / 25 continuous m	2.05 m / 25 continuous m	
	Article No.	Article No.	
Adriatic blue	27.14.10 D	27.14.11 D	
Pale blue	27.14.12 D	27.14.13 D	
White	27.14.14 D	27.14.15 D	
Turquoise	27.14.16 D	27.14.17 D	
Sand	27.14.18 D	27.14.19 D	
Grey	27.14.20 D	27.14.21 D	

**Foil 1,5 mm thick**

Width/by the m	1.65 m / 25 continuous m	2.05 m / 25 continuous m	
	Article No.	Article No.	
Medium blue	27.14.50 D	27.14.51 D	

**Alkorplan Super 2000**

Width/by the m	1.65 m / 25 continuous m		
	Article No.		
Mosaic – 1.5 mm thick	27.14.22 D		
Florentine – 1.5 mm thick	27.14.23 D		

**Footfall protection foil**

Width/by the m	1.65 m / 25 continuous m		
	Article No.		
Adriatic blue	27.91.10 D		
White	27.91.12 D		

Also available in pale blue (27.91.11), turquoise (27.91.13), sand (27.91.14) and black (27.91.15) (only in complete rolls).

Surcharge for cutting to size: 20% for all foils

# Fitting the foil, made-to-measure

## Accessories for fitting the foil

	Article No.
Foil-coated metal angle 70 x 30 x 2000 mm	27.60.10 D
Straight metal plates 70 x 2000 mm	27.60.11 D
Foil composite plate 1.0 x 2.0 m	27.60.12 D
Solvent welding agent (tetrahydrofurane)	27.60.13 D
Liquid foil (seam sealer)	
Blue	27.93.10 D
Pale blue	27.93.11 D
White	27.93.12 D
Turquoise	27.93.13 D
Sand	27.93.14 D
Fleece adhesive, 5 l	27.60.14 D
not suitable for polystyrene stones and polystyrene insulation	
Fleece adhesive, 1 cartridge 0.31 ml	27.60.16 D
for polystyrene stones, e.g. pool type Golf and polystyrene insulation	
Metal ionic bonder (1 l bottle)	27.60.15 D
Spray bottle 0.5 l	27.60.18 D
Special flat brush for screwing on to spray bottle	27.60.19 D
Hammer rivets, aluminium/stainless steel 4.8 x 26 mm (100 rivets)	27.60.20 D
Silicone rubber, medium blue as foil blue 0.6 and 0.8 mm (300 ml)	27.60.21 D
Silicone pre-primer, 125 g	27.60.22 D
Cartridge spray gun	27.60.23 D

**Floor protection fleece**  
 PES fleece 300 g/m<sup>2</sup> white, made of polyester, protects the pool inner cover from damage and from chemical influences. Antimicrobial finish, screw resistant.  
 In rolls 2 m and 1.5 m wide, length 50 continuous m



2 m wide, price for purchasing the whole roll

Article No. 27.40.10 D

2 m wide, price for purchasing part of the roll

Article No. 27.40.11 D

Disinfectant  
 250 ml bottle

Article No. 27.60.17 D



Please state with the order whether 90° corners or round corners are required.

## Made-to-measure foil (please state with the order whether 90° corners or round corners are required)

100% surcharge for inconstant pool height and/or deep section



	h = 1,20	h = 1,50	Special height
	Article No.	Article No.	Article No.
Blue 0.6 mm	28.19.98 C	29.19.98 C	30.19.98 C
Blue 0.8 mm	28.19.99 C	29.19.99 C	30.19.99 C
Florida 0.75 mm	28.59.99 C	29.59.99 C	30.59.99 C
Naxos 0.75 mm	28.69.99 C	29.69.99 C	30.69.99 C
Marble 0.75 mm	28.49.99 C	29.49.99 C	30.49.99 C
White 0.75 mm	28.39.99 C	29.39.99 C	30.39.99 C
Pale blue 0.75 mm	28.29.99 C	29.29.99 C	30.29.99 C
Turquoise 0.75 mm	28.89.99 C	29.89.99 C	30.89.99 C
Sand 0.75 m	28.99.99 C	29.99.99 C	30.99.99 C



Be inspired by our attractive foil designs.

## Special profile for SUNNY POOLS®

The SUNNY POOLS® are always supplied with inner cover and wedge piping. This requires either the new handrail or the existing handrail together with a special profile. If this profile has to be used, an inner cover with wedge piping must be ordered together with the order for the pool (same price).

### Advantages:

- Easier assembly: metal casing is immediately stable
- Edge stones can be placed directly on the handrail
- Diagonal pleating can be removed easily because the wedge piping can be moved horizontally.

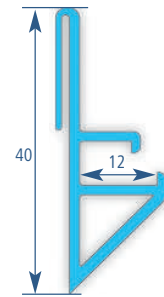

Special profile = 1.20 m Article No. 25.71.10

## Special profile for rectangular pools

### For SUNNY POOL® Golf, concrete pool and brickwork pools

We have developed this special profile to make it easy to replace the pool liner for rectangular pools with intact edge covering. The profile is fitted directly below the edge covering. This means that the edge stones do not have to be removed when repairing the pool.



For rectangular pools, the foil should not be rounded in the pool corners only for very exact pools, e.g. SUNSTAR®

Bars measuring 1.20 m

Article No. 25.71.15 D

Curved corner, 90°, radius 50 mm

Article No. 25.71.16 D

Hard PVC fastening profile (narrow) in bars 2.1 m long to accommodate the wedge piping at the liner

Article No. 25.71.11

Corner piece (narrow), hard PVC fastening profile bent into a quadrant, inner radius 50 mm

Article No. 25.71.12

Hard PVC fastening profile (wide) for SUNNY POOL® Golf, with edge protection, 90 mm wide, 2.10 m long

Article No. 25.71.13

Corner piece (wide) for SUNNY POOL® Golf, hard PVC fastening profile bent into a quadrant, wide with edge protection, inner radius 50 mm

Article No. 25.71.14

PE profile made of polyethylene foam, rounded; 1.5 m long.

For adhering in the vertical corner of the pool (for rectangular pools with rounded corners)

Article No. 25.73.10

Keder for sealing the profile for suspending the wedge piping

Article No. 25.71.17 D

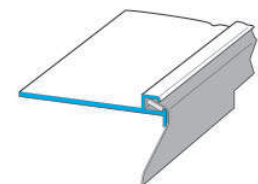
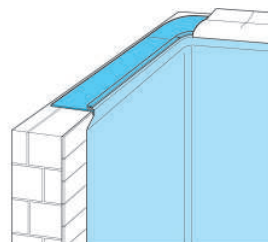
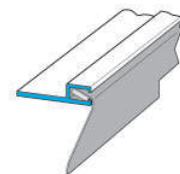
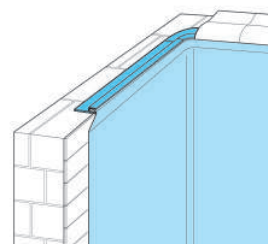
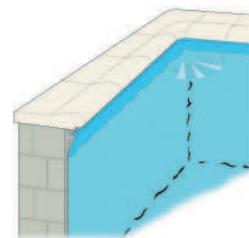

# Swimming pool liners



## Extended range of foils for pools 1.5 m deep:

SUNNY POOL® round, eight form and oval, SUNSTAR® Pool,

### Why have we made essential additions to the colours and design of our foil programme?

#### For two reasons:

1. Products are expected to fulfil increasingly demanding standards with regard to appearance and design. When all is said and done, not all cars are painted the same colour! Our customers are also showing increasing interest in their "own" individual pool.

2. There are also practical advantages to a pool liner which is not just one colour. Foils printed with a pattern are less likely to show stains, e.g. from chlorine. Slight dirt deposits on the floor of the pool are also less obvious and therefore do not have to be removed immediately.

Surcharge for swimming pool liners compared to 0.8 blue.

The effect of the foil price on the pool price is indicated for the individual pool types.

Florida	20%	Naxos	20%
---------	-----	-------	-----

Marble	12%	Pale blue	12%
Weiß	12%		

Blue	no surcharge	Turquoise	no surcharge
------	--------------	-----------	--------------

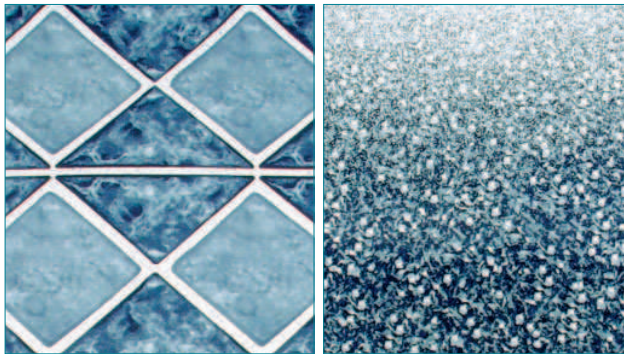

Florida 0.75 mm

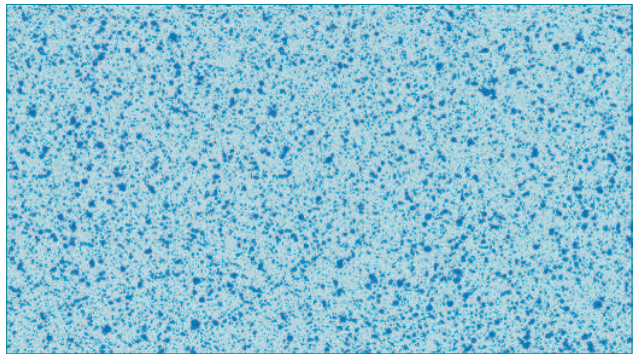

Naxos 0.75 mm

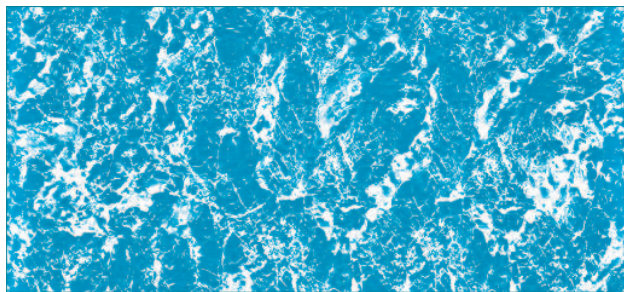

Marble 0.75 mm



Turquoise 0.8 mm

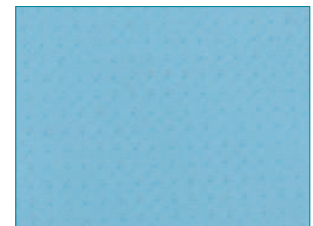

Pale blue 0.75 mm

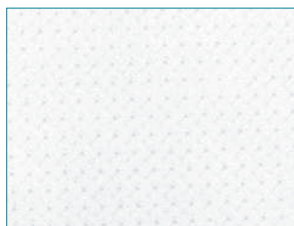

White 0.75 mm



Blue 0.8 mm

# Swimming pool liners

## Round pool liners



Foil blue 0.6 mm, with piping

Surcharge for foil blue and turquoise 0.8 mm for 1.2 m and 1.5 m high pool +25%

Florida, Naxos for 1.5 m high pool +50%

Marble, pale blue, white for 1.5 m high pool +40%

	1.20 m high		1.50 m high
m ø	Article No.		Article No.
3.00	28.11.11 D		
3.50	28.11.12 D		
3.60	28.11.13 D		
<b>4.00</b>	<b>28.11.14 D</b>		<b>29.11.13 D</b>
4.20	28.11.15 D		29.11.14 D
4.50	28.11.16 D		29.11.15 D
4.60	28.11.17 D		29.11.16 D
<b>5.00</b>	<b>28.11.18 D</b>		<b>29.11.17 D</b>
5.50	28.11.19 D		29.11.18 D
<b>6.00</b>	<b>28.11.20 D</b>		<b>29.11.19 D</b>
6.40	28.11.21 D		29.11.20 D
6.50	28.11.22 D		29.11.21 D
<b>7.00</b>	<b>28.11.23 D</b>		<b>29.11.22 D</b>
7.50	28.11.24 D		29.11.23 D
<b>8.00</b>	<b>28.11.25 D</b>		<b>29.11.24 D</b>
8.50	28.11.26 D		29.11.25 D
9.00	28.11.27 D		29.11.26 D
10.00	28.11.28 D		29.11.27 D
12.00	28.11.29 D		29.11.28 D



Please always state with your order whether you need the liner with suspension or wedge piping!



The inner covers shown in bold print in blue 0.6/1.2 and 1.5 m are standard covers which are normally always available ex stock.

All other sizes and foils in 0.8 m blue and/or design foils are custom-made products which are produced specially and cannot be taken back.

## Eight form pool liners



Foil blue 0.6 mm, with piping

Surcharges see above

	1.20 m high		1.50 m high
m	Article No.		Article No.
<b>5.25 x 3.20</b>	<b>28.12.10 D</b>		<b>29.12.10 D</b>
5.40 x 3.50	28.12.11 D		29.12.11 D
5.75 x 3.50	28.12.12 D		29.12.12 D
<b>6.25 x 3.60</b>	<b>28.12.13 D</b>		<b>29.12.13 D</b>
6.50 x 4.20	28.12.14 D		29.12.14 D
7.10 x 4.20	28.12.15 D		29.12.15 D
7.30 x 4.20	28.12.17 D		29.12.17 D
<b>7.25 x 4.60</b>	<b>28.12.16 D</b>		<b>29.12.16 D</b>
7.70 x 5.00	28.12.18 D		29.12.18 D
8.40 x 5.00	28.12.19 D		29.12.19 D
<b>8.55 x 5.00</b>	<b>28.12.20 D</b>		<b>29.12.20 D</b>
9.20 x 6.00	28.12.21 D		29.12.21 D
9.60 x 6.00	28.12.22 D		29.12.22 D



All our foils are thermoplastics. Temperatures constantly above 28°C can cause pleating. The maximum constant temperature for fabric-reinforced foils is 32°C.

# Swimming pool liners



## Oval pool liners



Foil blue 0.6 mm, with piping.  
 Surcharges see page 100

	1.20 m high	1.50 m high
m	Article No.	Article No.
<b>4.90 x 3.00</b>	<b>28.13.11 D</b>	<b>29.13.11 D</b>
5.70 x 3.00	28.13.13 D	29.13.12 D
5.75 x 3.50	28.13.14 D	29.13.13 D
5.86 x 3.50	28.13.15 D	29.13.14 D
5.60 x 4.20	28.13.12 D	29.13.15 D
6.00 x 3.00	28.13.16 D	29.13.16 D
6.14 x 3.00	28.13.17 D	29.13.17 D
6.20 x 3.50	28.13.18 D	29.13.18 D
<b>6.30 x 3.60</b>	<b>28.13.19 D</b>	<b>29.13.19 D</b>
7.00 x 3.00	28.13.20 D	29.13.20 D
7.00 x 3.50	28.13.21 D	29.13.21 D
7.14 x 4.00	28.13.23 D	29.13.22 D
<b>7.37 x 3.60</b>	<b>28.13.25 D</b>	<b>29.13.23 D</b>
7.03 x 4.20	28.13.22 D	29.13.24 D
7.42 x 3.50	28.13.26 D	29.13.25 D
7.50 x 3.50	28.13.27 D	29.13.26 D
7.30 x 4.20	28.13.24 D	29.13.27 D
7.70 x 5.00	28.13.28 D	29.13.28 D
<b>8.00 x 4.00</b>	<b>28.13.29 D</b>	<b>29.13.29 D</b>
8.20 x 4.20	28.13.31 D	29.13.30 D
8.14 x 5.00	28.13.30 D	29.13.31 D
8.59 x 4.20	28.13.32 D	29.13.32 D
8.71 x 4.00	28.13.33 D	29.13.33 D
9.00 x 4.50	28.13.34 D	29.13.34 D
<b>9.16 x 4.60</b>	<b>28.13.36 D</b>	<b>29.13.35 D</b>
9.50 x 4.20	28.13.37 D	29.13.36 D
<b>9.00 x 5.00</b>	<b>28.13.35 D</b>	<b>29.13.37 D</b>
9.50 x 5.00	28.13.38 D	29.13.38 D
10.00 x 6.00	28.13.40 D	29.13.40 D
10.30 x 5.00	28.13.41 D	29.13.41 D
11.00 x 5.50	28.13.42 D	29.13.42 D
11.30 x 6.00	28.13.43 D	29.13.43 D
12.60 x 6.00	28.13.45 D	29.13.45 D

**i**  
 Please always state with your order whether you need the liner with suspension or wedge piping!

**i**  
 The inner covers shown in bold print in blue 0.6/1.2 and 1.5 m are standard covers which are normally always available ex stock.

All other sizes and foils in 0.8 m blue and/or design foils are custom-made products which are produced specially and cannot be taken back.

## Longitudinal pool liners for pools 1.20 m high, with piping

Foil blue 0.6 mm, surcharges see 100



m	Article No.
5.75 x 3.50	28.19.10 D
7.10 x 4.16	28.19.11 D
7.30 x 4.20	28.19.12 D
8.36 x 5.00	28.19.13 D
8.40 x 5.00	28.19.14 D
9.60 x 6.00	28.19.15 D

## Round pool liners for children's paddling pools, with piping

Foil blue, floor min. 0.4 mm, wall 0.3 mm



m ø x m	Article No.
2.5 x 0.5	30.11.10 D
3.0 x 0.6	30.11.11 D
3.5 x 0.9	30.11.12 D

# Swimming pool liners

## Spare liners for imported pools, **without piping**



Foil blue 0.4 mm

m ø x m	Article No.
2.0 x 0.6	30.18.10 D
2.5 x 0.5	30.18.11 D
2.5 x 0.6	30.18.12 D
3.0 x 0.6	30.18.13 D
3.5 x 0.6	30.18.14 D
3.5 x 0.9	30.18.15 D
3.6 x 0.9	30.18.16 D

## Round pool liners for pools 1.20 m high, **without piping**



Foil blue 0.6 mm

m ø	Article No.
3.60	28.18.10 D
3.65	28.18.11 D
4.50	28.18.12 D
4.57	28.18.13 D
5.00	28.18.14 D
5.40	28.18.15 D
5.48	28.18.16 D
6.00	28.18.17 D
6.30	28.18.18 D
6.40	28.18.19 D
7.20	28.18.20 D
7.31	28.18.21 D
8.10	28.18.22 D
8.23	28.18.23 D

## Oval pool liners for pools 1.20 m high, **without piping**



Foil blue 0.6 mm

m	Article No.
5.40 x 3.60	28.18.24 D
5.48 x 3.66	28.18.25 D
6.30 x 3.60	28.18.26 D
6.40 x 3.65	28.18.27 D
7.20 x 3.60	28.18.28 D
7.31 x 3.65	28.18.29 D
7.20 x 4.50	28.18.30 D
7.31 x 4.57	28.18.31 D
8.10 x 4.50	28.18.32 D
8.20 x 4.75	28.18.33 D
9.00 x 4.50	28.18.34 D
9.14 x 4.57	28.18.35 D
12.50 x 4.50	28.18.36 D
12.49 x 4.57	28.18.37 D

Surcharges see 100

Swimming pool foil repair set

Article No. 27.60.24 D
------------------------

All our foils are thermoplastics. Temperatures constantly above 28°C can cause pleating. The maximum constant temperature for fabric-reinforced foils is 32°C.

## Octagonal pool liners for wooden pools, e.g. Arizona Pool



Foil blue 0.6 mm

	1.35 m high		1.50 m high	
	Article No.		Article No.	
RE 600	30.19.10 D		29.19.10 D	
RE 700	30.19.11 D		29.19.11 D	
RE 800	30.19.12 D		29.19.12 D	
RE 1000	30.19.13 D		29.19.13 D	

Foil blue 0.6 mm

	1.35 m high		1.50 m high	
	Article No.		Article No.	
RE 600	30.19.14 D		29.19.14 D	
RE 700	30.19.15 D		29.19.15 D	
RE 800	30.19.16 D		29.19.16 D	
RE 1000	30.19.17 D		29.19.17 D	



At the end of the quality control procedure, every MTH swimming pool foil is given the quality seal stating the year of production.



# Swimming pool handrail and ground rail

with integrated profile for suspending in the wedge piping

Round pool		Swimming pool handrail	Ground rail
m ø	Article No.		Article No.
4.00	25.41.17 D		25.51.17 D
4.50	25.41.19 D		25.51.19 D
5.00	25.41.21 D		25.51.21 D
5.50	25.41.22 D		25.51.22 D
6.00	25.41.23 D		25.51.23 D
7.00	25.41.24 D		25.51.24 D
8.00	25.41.25 D		25.51.25 D
9.00	25.41.26 D		25.51.26 D
10.00	25.41.27 D		25.51.27 D



Eight form pool		Swimming pool handrail	Ground rail
m	Article No.		Article No.
5.25 x 3.20	25.42.10 D		25.52.10 D
5.40 x 3.50	25.42.11 D		25.52.11 D
6.25 x 3.60	25.42.12 D		25.52.12 D
7.25 x 4.60	25.42.14 D		25.52.14 D
8.55 x 5.00	25.42.16 D		25.52.16 D
9.20 x 6.00	25.42.17 D		25.52.17 D



Oval pool		Swimming pool handrail	Ground rail
m	Article No.		Article No.
4.90 x 3.00	25.43.10 D		25.53.10 D
6.30 x 3.60	25.43.14 D		25.53.14 D
7.37 x 3.60	25.43.21 D		25.53.21 D
8.00 x 4.00	25.43.22 D		25.53.22 D
9.16 x 4.60	25.43.29 D		25.53.29 D
9.00 x 5.00	25.43.28 D		25.53.28 D
10.30 x 5.00	25.43.31 D		25.53.31 D
11.00 x 5.50	25.43.32 D		25.53.32 D



The handrail without profile for suspending the wedge piping (for foils with suspended piping) is available at the same price, please state with order

Round pool (narrow), handrail and ground rail identical	
m ø	Article No.
2.50	25.41.10 D
3.00	25.41.12 D
3.50	25.41.14 D



## Garden pond foil

### SUNNYFOL, special foil for garden ponds

Custom-made product, rectangle or square as stated

0.5 mm	27.92.96 D	1.00 mm	27.92.97 D
Three-dimensional version 1.0 mm (Fleece see p. 133)		27.92.98 D	
Solvent welding agent (tetrahydrofurane)		27.60.13 D	

